

TRACT 20393-3

J.F. Davidson Associates, Inc.
ENGINEERING PLANNING SURVEYING
ARCHITECTURE LANDSCAPE ARCHITECTURE

FB. 12640/43

SHEET 1 OF 4 SHEETS

SURVEY OF TRACT 20393-3 E TIES

FOR VAN PABLE

W.O. No. 12640

Date 9-29-92

SURVEY PARTY FRANK CANNARIZI

REF.

AM.

SURVEY NOIES WINDWOOD CIR. S'LY OF WESTERLY DR.

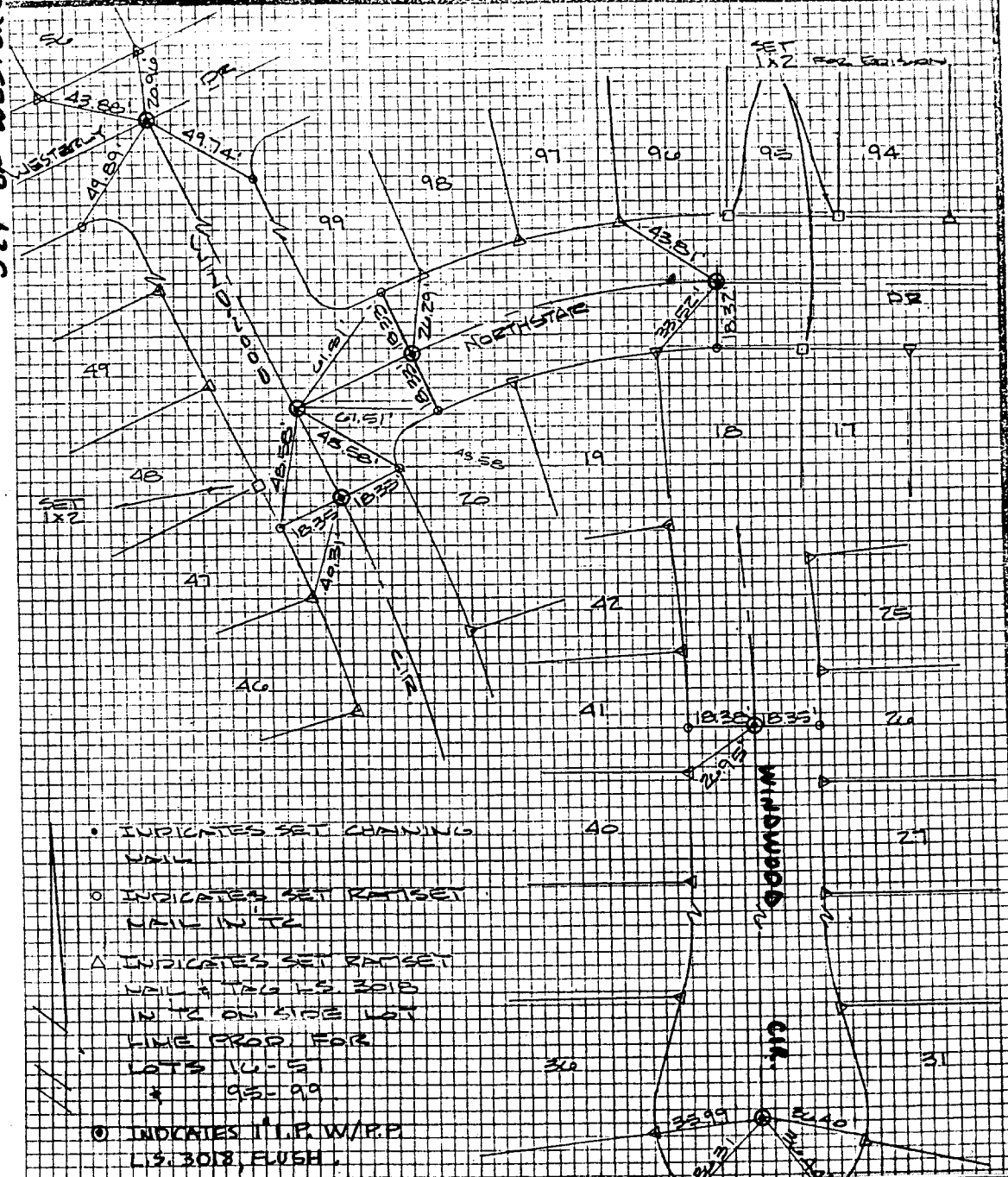

- INDICATES SET CHAINING NAIL
- INDICATES SET RAMSET NAIL IN T/C
- △ INDICATES SET RAMSET NAIL FLAG L.S. 3018 IN T/C ON SIDE LOT FINE GRID FOR LOTS 46-51 & 95-99
- INDICATES I.L.P. W/R.P. L.S. 3018, FLUSH.

- × FD. Ramset Nail on T/C
- FD. LD. & TK. on T/C
- FD. "C" Nail on T/C
- Set LD. & TK. on T/C

OFFICIAL TIE PLAT

CITY OF RIVERSIDE

These ties are for the purpose of perpetuating the found monumentation. No claim is made as to the relationship of the points or lines shown hereon to true boundary locations.

Scale: _____
 Date: _____
 Drawn by: _____
 W.O.: _____
 F.B.: _____

Sheet 1 of 1
 File No.: _____

Street: WINDWOOD CIR. 8859 TIE
 X-Street: WESTERLY DR.
 OFFICIAL USE ONLY