

Street: **WASHINGTON ST.**  
**8992** **71E** OFFICIAL USE ONLY  
 X-Street: **FRANCES ST.**

WASHINGTON STREET  
 AT FRANCES STREET

HISTORICAL DATA	SWING TIES	CREW:
FB 21/30		STEELE
FB 484/22		FRYC
FB 953/2		RUSSELL
		MARCH 15, 72
		FB 580/44

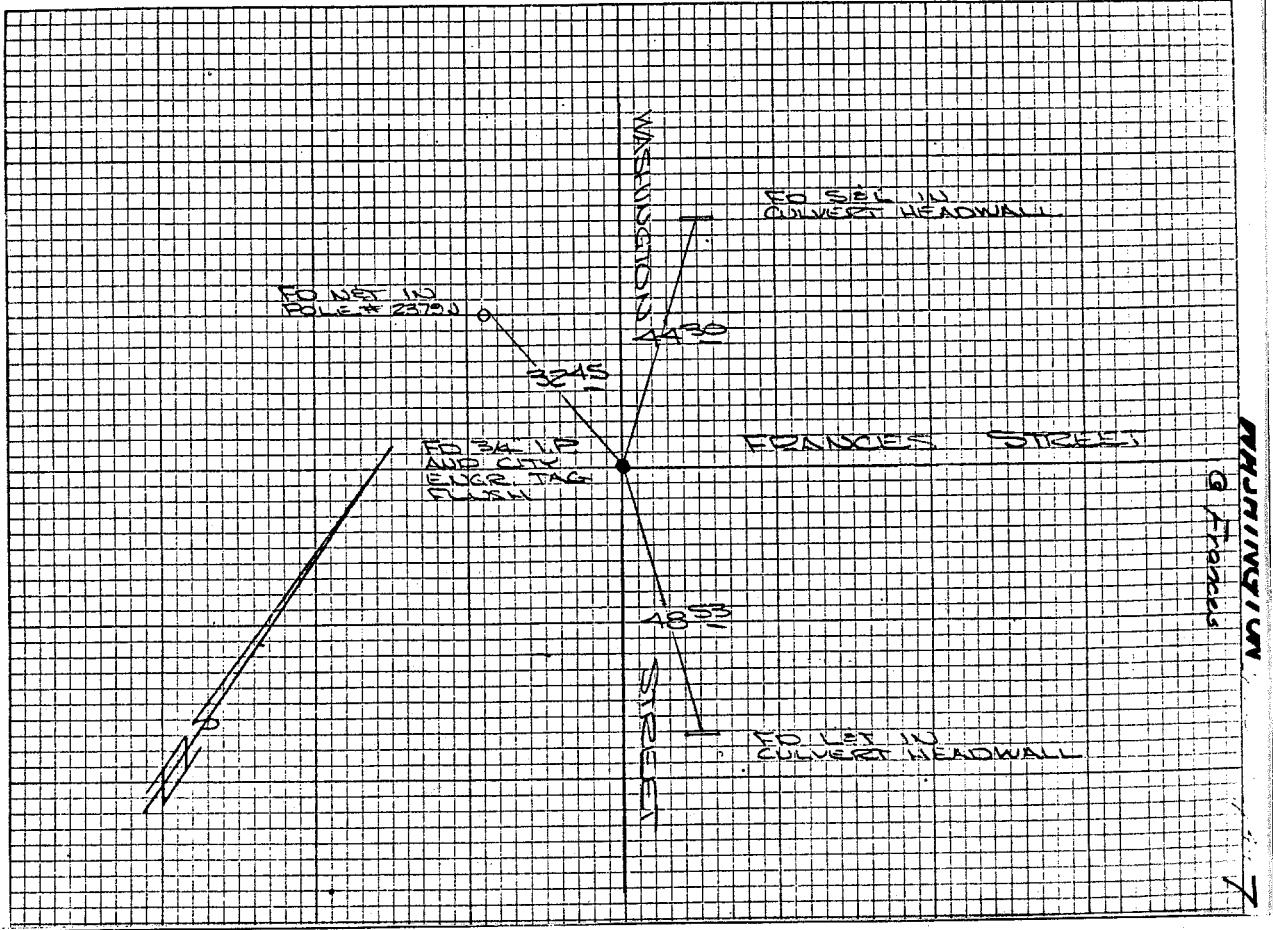

- ✕ FD. Ramset Nail on T/C
- FD. LD. & TK. on T/C
- FD. "C" Nail on T/C
- Set LD. & TK. on T/C

## OFFICIAL TIE PLAT

### CITY OF RIVERSIDE

*These ties are for the purpose of perpetuating the found monumentation. No claim is made as to the relationship of the points or lines shown hereon to true boundary locations.*

Scale: \_\_\_\_\_  
 Date: \_\_\_\_\_  
 Drawn by: \_\_\_\_\_  
 W.O.: \_\_\_\_\_  
 F.B.: \_\_\_\_\_

Sheet 1 of 1  
 File No.: \_\_\_\_\_