

HISTORICAL DATA

CRFB 1005/35
 CRFB 999/54
 CRFB 940/48

Third ST BETWEEN Commerce & Park
 INDEX LL38 pg 128 10/3/83

TRANSIT TIES

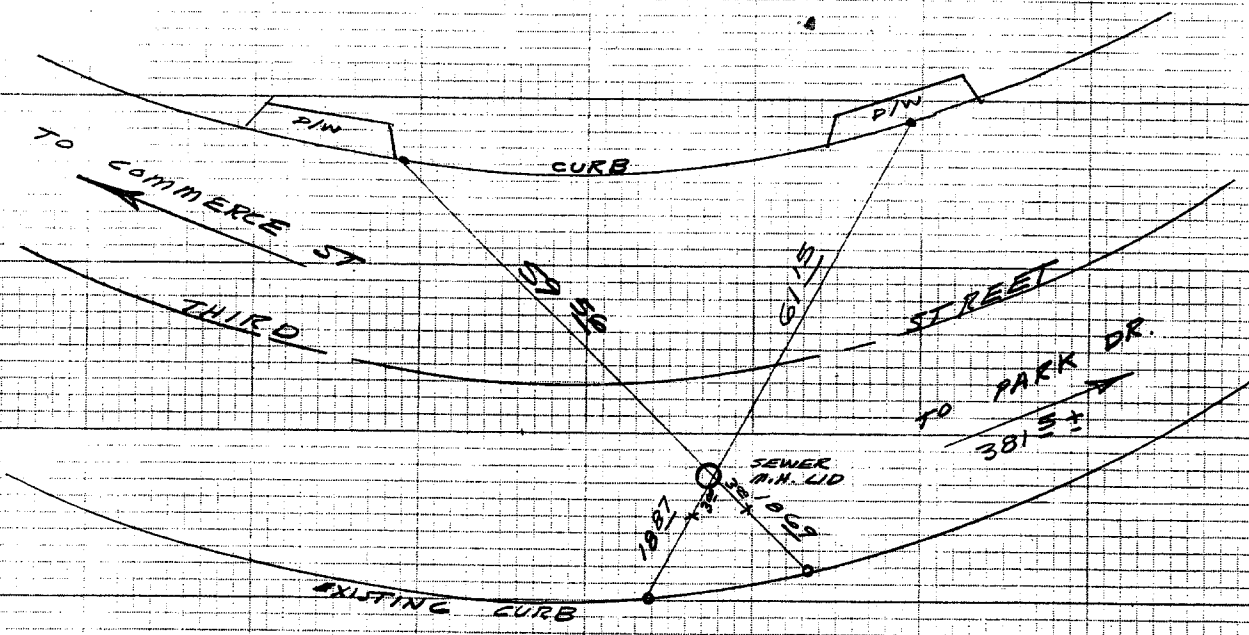

- FD L & T
- SET L & T
- × FD RR SPIKE WITH PUNCH MARK
 3.00 FROM P.I., PER CRFB 1005/35

- × FD. Ramset Nail on T/C
- FD. LD. & TK. on T/C
- FD. "C" Nail on T/C
- Set LD. & TK. on T/C

Street: Third ST
 9091 TIF
 OFFICIAL USE ONLY
 X-Street: Between Commerce & Park

Scale:

Date:

Drawn by:

W.O.:

F.B.:

OFFICIAL TIE PLAT
 CITY OF RIVERSIDE

These ties are for the purpose of perpetuating the found monumentation. No claim is made as to the relationship of the points or lines shown hereon to true boundary locations.

Sheet 1 of 1

File No.: