

HISTORICAL
DATA
FB 926/63

TRANSIENT TIES

CREW:
STEELE
FRY
DEW
AUG. 31, 71
FB 952/48

Field Checked
11-21-79 KD

RESET
11-16-89

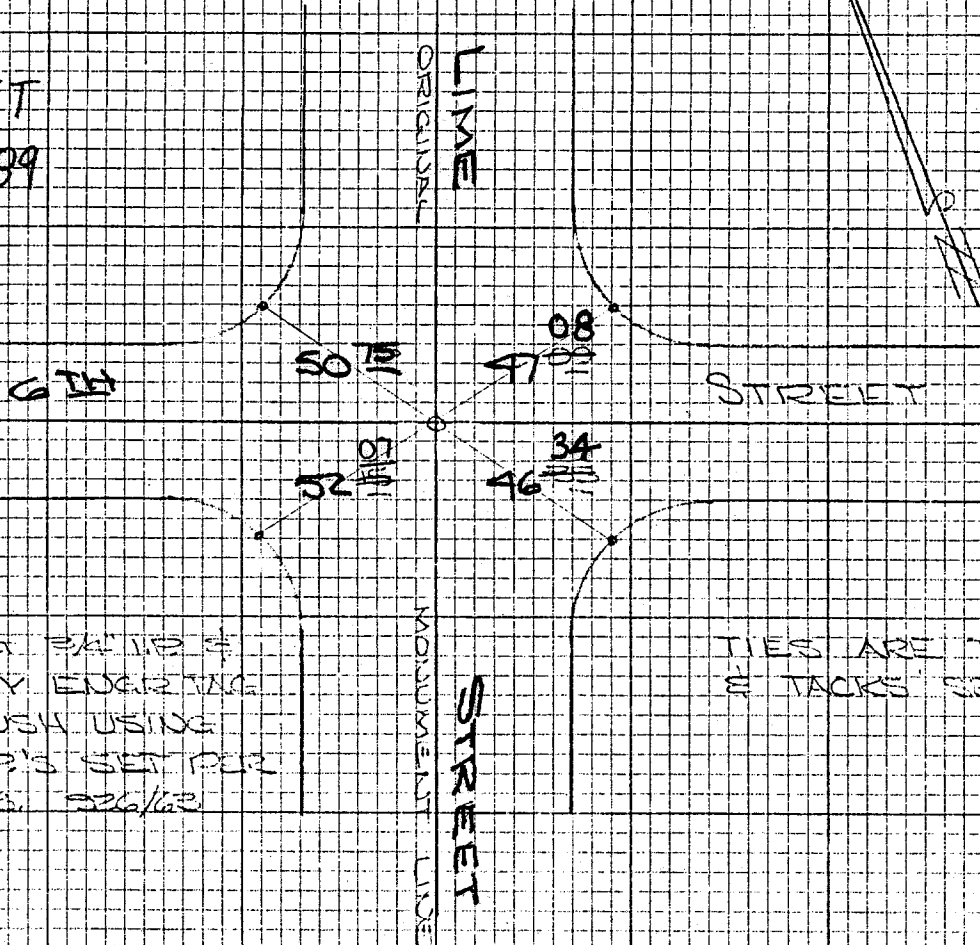

- ✕ FD. Ramset Nail on T/C
- FD. LD. & TK. on T/C
- FD. "C" Nail on T/C
- Set LD. & TK. on T/C

Street: LIME ST
9149 TIE

X-Street: 6TH ST
OFFICIAL USE ONLY

Scale:

Date:

Drawn by:

W.O.:

F.B.:

OFFICIAL TIE PLAT

CITY OF RIVERSIDE

These ties are for the purpose of perpetuating the found monumentation. No claim is made as to the relationship of the points or lines shown hereon to true boundary locations.

Sheet 1 of 1

File No.: