

HISTORICAL DATA  
 CREB 237/4-75

TRANSIT TIES

CREW:  
 STEELE  
 FRVC  
 DEW  
 SEPT 14, 77  
 CREB 237/79

Street: 10th ST  
 9237 TIF  
 OFFICIAL USE ONLY  
 X-Street: ALLEY B/TW MAIN &  
 ORANGE

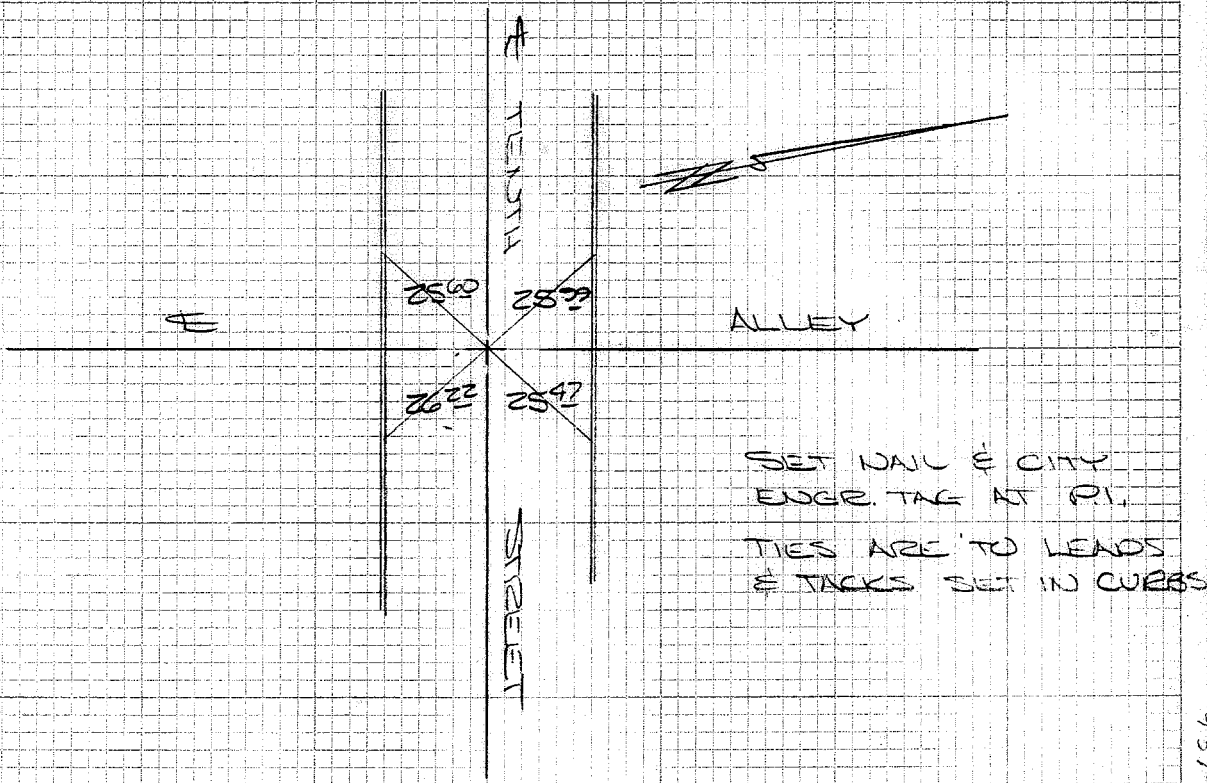

- ✕ FD. Ramset Nail on T/C
- FD. LD. & TK. on T/C
- FD. "C" Nail on T/C
- Set LD. & TK. on T/C

Scale:  
 Date:  
 Drawn by:  
 W.O.:  
 F.B.:

**OFFICIAL TIE PLAT**  
 CITY OF RIVERSIDE

*These ties are for the purpose of perpetuating the found monumentation. No claim is made as to the relationship of the points or lines shown hereon to true boundary locations.*

Sheet 1 of 1  
 File No.: