

TRANSIT TIES

NOTE:

⊙ FD. N+T + 2' N+T
 * TIES FLUSH PER
 CITY TIE SHT. DATED
~~4/4/86 + LL9/44*~~
 RESET W/PK NAIL
 AND CITY ENGR.
 TAG FLUSH

HISTORICAL DATA

CITY TIE SHT. DATED 4/4/86
 LL9/44-A
 CRFB 957/2
 " 656/42443
 FIELD CHECKED
 2-8-01

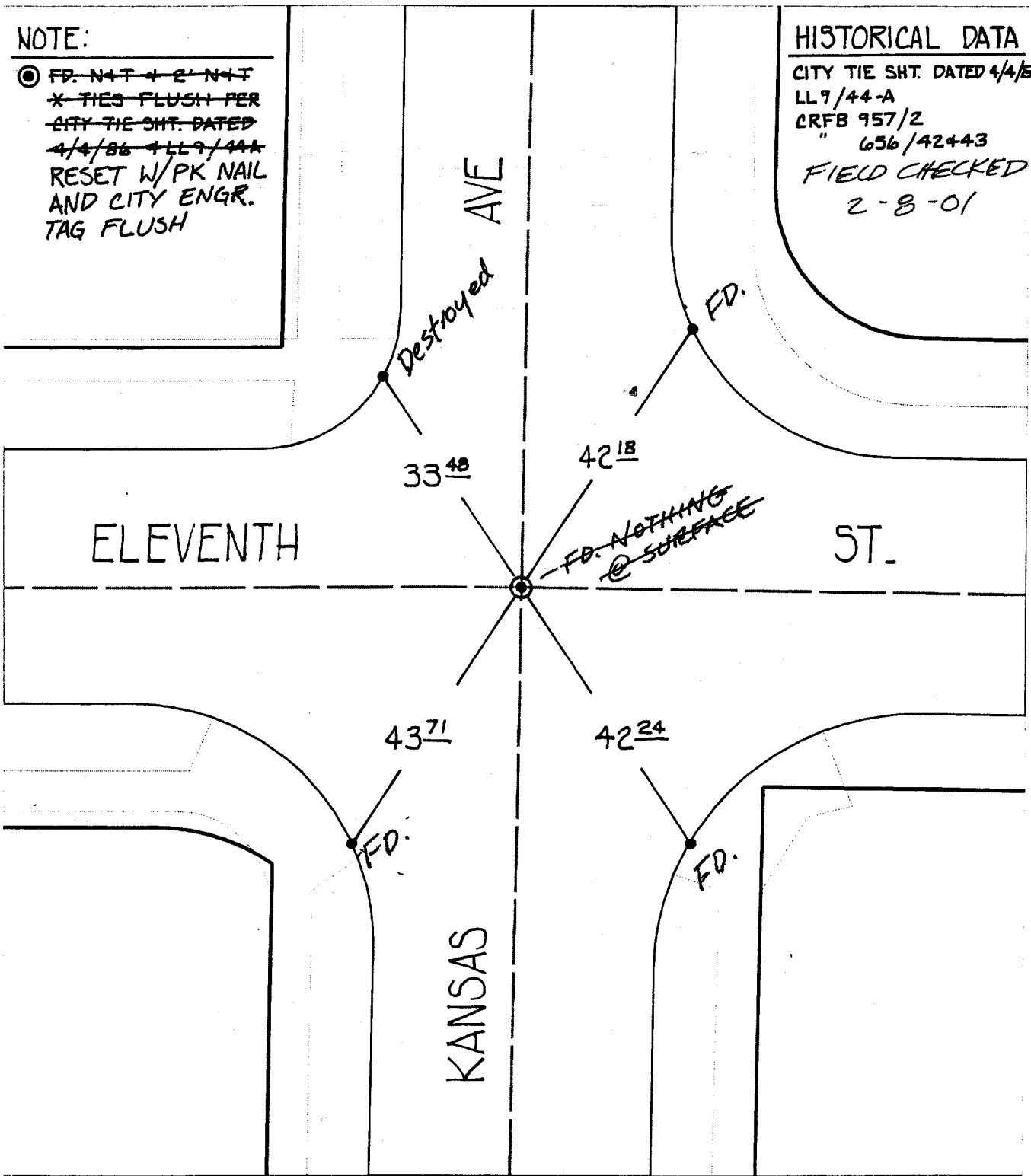

✕ FD. Ramset Nail on T/C
 ■ FD. "C" Nail on T/C

● FD. LD. & TK. on T/C
 ○ Set LD. & TK. on T/C

Scale: 1" = 20'

Date: 08/16/99

Drawn by: L. Harris

W.O.:

F.B.:

OFFICIAL TIE PLAT
CITY OF RIVERSIDE

*These ties are for the purpose of perpetuating the found
 monumentation. No claim is made as to the relationship of
 the points or lines shown hereon to true boundary locations.*



Sheet 4 of 5

File No.:

Street: **9246 TIE** KANSAS AVE.
 X-Street: ELEVENTH ST.
 OFFICIAL USE ONLY