

SWING TIES

NOTE:

- TEMP. PT. ON M.H. LID W/3' N+T X-TIES
- () RECORD DIST.

RESET W/ PK. NAIL & CITY ENGR TAG
FD. NOTHING

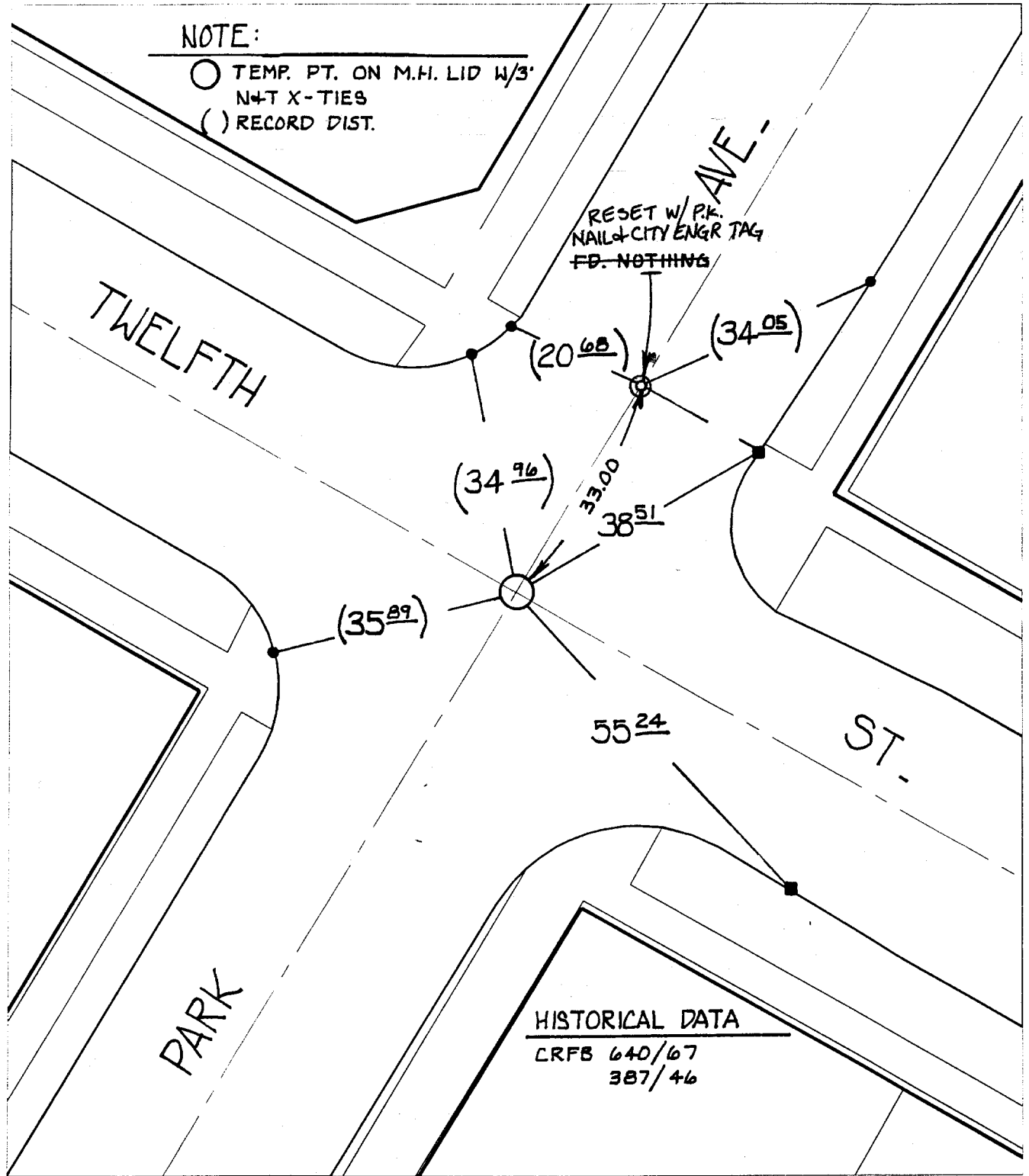

Street: 9282 TWELFTH ST.
X-Street: PARK AVE.
OFFICIAL USE ONLY

- × FD. Ramset Nail on T/C
- FD. LD. & TK. on T/C
- FD. "C" Nail on T/C
- Set LD. & TK. on T/C

HISTORICAL DATA
CRFB 640/67
387/46

Scale: 1" = 20'
Date: 11/7/99
Drawn by: survey
W.O.:
F.B.:

OFFICIAL TIE PLAT
CITY OF RIVERSIDE

These ties are for the purpose of perpetuating the found monumentation. No claim is made as to the relationship of the points or lines shown hereon to true boundary locations.



19
17
Sheet 1 of 1
File No.: