

SWING TIES

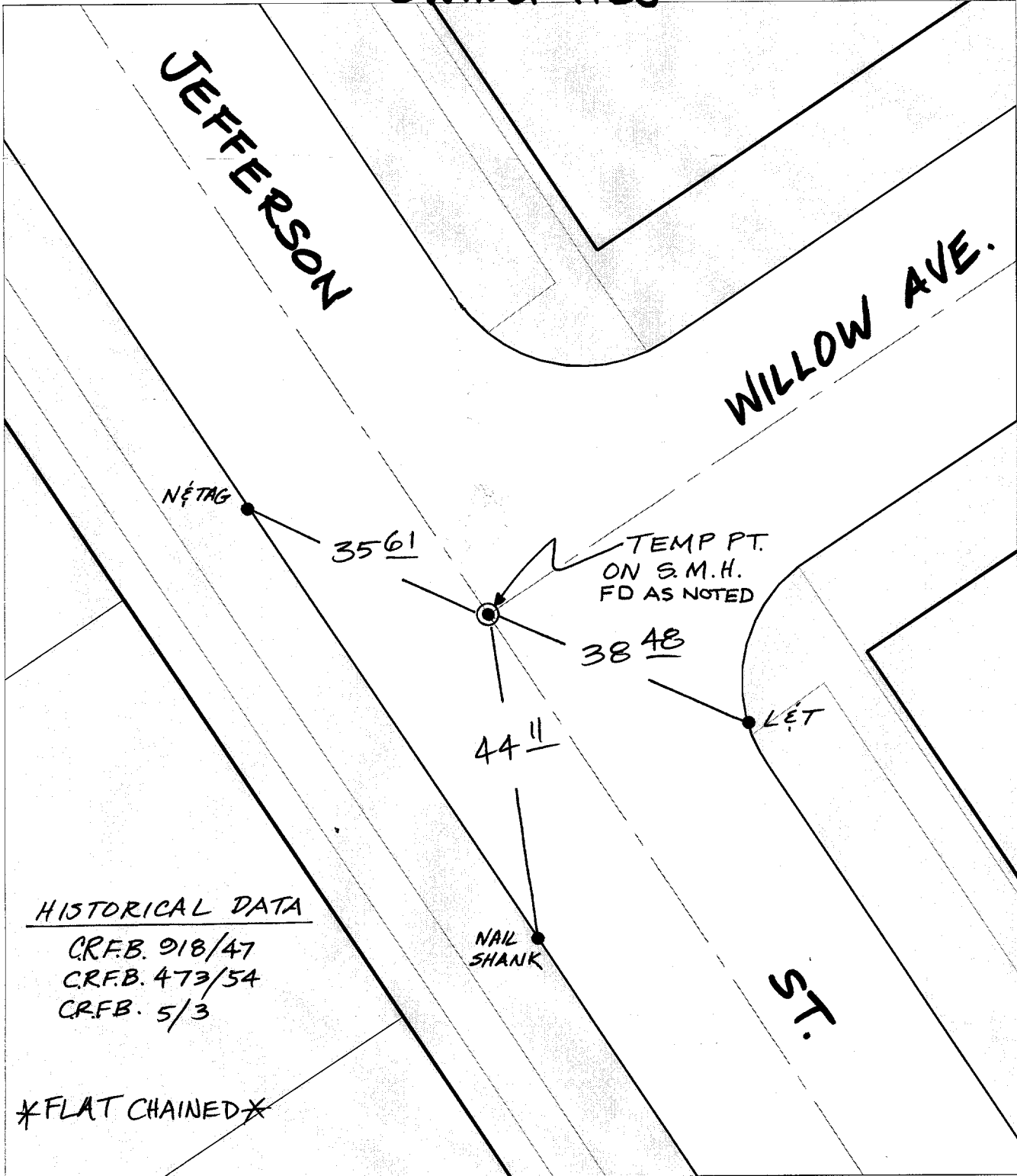

HISTORICAL DATA

CR.F.B. 918/47  
 CR.F.B. 473/54  
 CR.F.B. 5/3

\*FLAT CHAINED\*

Street: **WILLOW AVE.**  
**9239 TIF**  
 X-Street: **JEFFERSON ST.**  
 OFFICIAL USE ONLY

- ✕ FD. Ramset Nail on T/C      ● FD. LD. & TK. on T/C
- FD. "C" Nail on T/C      ○ Set LD. & TK. on T/C

P.K. and City Engineer tag to be set @ surface after street construction is complete. (if possible)

Scale: 1" = 20'  
 Date: 05/09/01  
 Drawn by: scurtis  
 F.B.:  
 TR-Sec: T3SR5W-5

**OFFICIAL TIE PLAT**  
 CITY OF RIVERSIDE

*These ties are for the purpose of perpetuating the found monumentation. No claim is made as to the relationship of the points or lines shown hereon to true boundary locations.*



Sheet 1 of 1  
 Cadme MB: 52-5