

Street: MAUDE ST. B.C. & E.C. **9767 TIF** X-Street: S'LY OF ARLINGTON AVE.  
 OFFICIAL USE ONLY

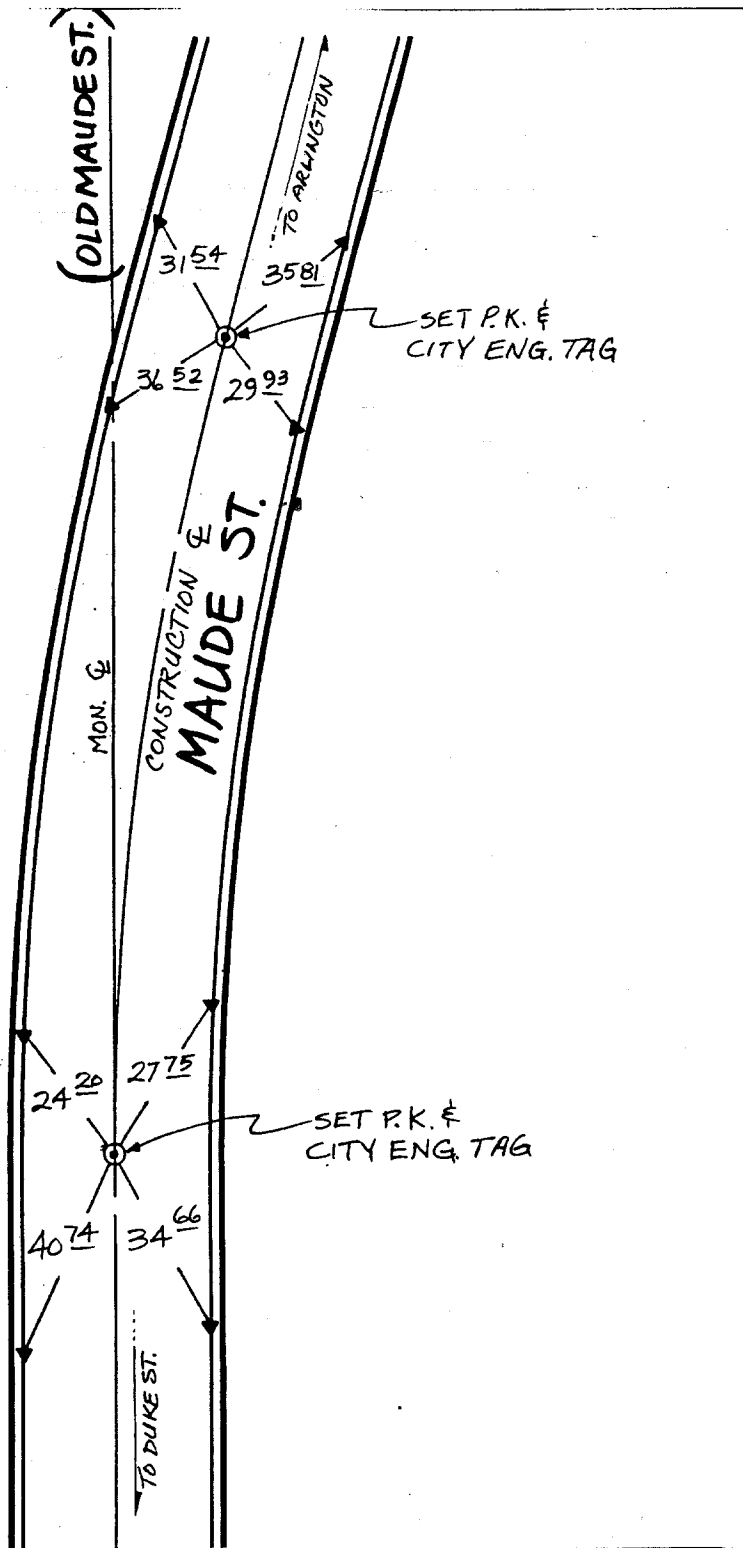

ALL DISTANCES  
FLAT CHAINED

▲ - INDICATES SET  
P.K. NAIL IN T.C.

× FD. Ramset Nail on T/C  
 ■ FD. "C" Nail on T/C

● FD. LD. & TK. on T/C  
 ○ Set LD. & TK. on T/C

Scale:  
 Date:  
 Drawn by:  
 W.O.:  
 F.B.:

**OFFICIAL TIE PLAT**  
**CITY OF RIVERSIDE**

*These ties are for the purpose of perpetuating the found monumentation. No claim is made as to the relationship of the points or lines shown hereon to true boundary locations.*

Sheet 1 of 1  
 File No.: