

Street: **9836 TIF** INDIANA AVE.
 X-Street: OFFICIAL USE ONLY
 MARY ST.

HISTORICAL DATA

CRFB 952/60-61
 " 919/17
 " 669/53
 " 254/63

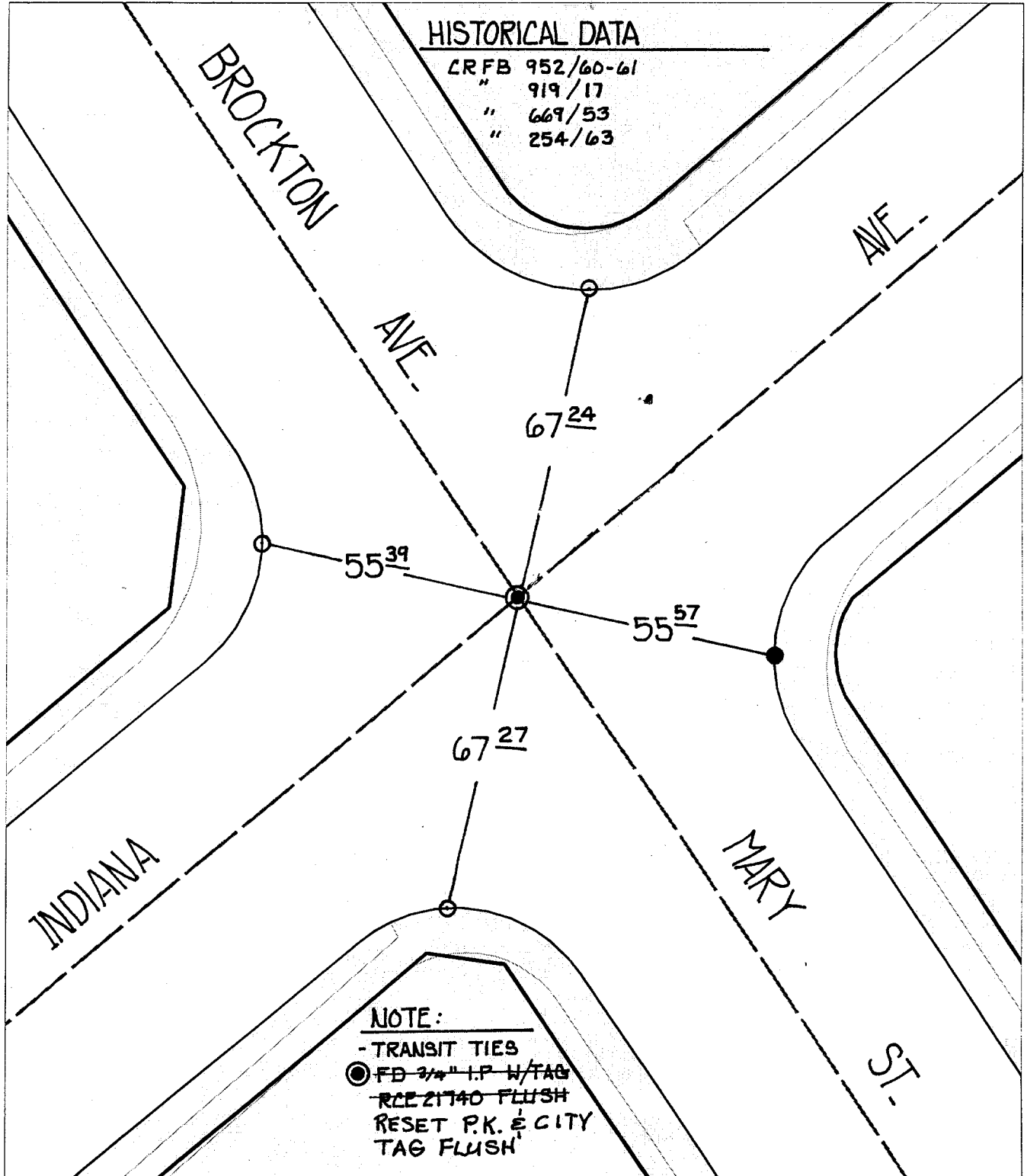

NOTE:

- TRANSIT TIES
- FD 3/4" I.P. W/TAG
- ~~RCE 21740 FLUSH~~
- RESET P.K. $\frac{1}{2}$ CITY
- TAG FLUSH

- × FD. Ramset Nail on T/C
- FD. "C" Nail on T/C

- FD. LD. & TK. on T/C
- Set LD. & TK. on T/C

Scale: 1" = 30'

Date: 08/05/99

Drawn by: L. Harris

W.O.:

F.B.:

OFFICIAL TIE PLAT
CITY OF RIVERSIDE

These ties are for the purpose of perpetuating the found monumentation. No claim is made as to the relationship of the points or lines shown hereon to true boundary locations.



Sheet 1 of 1

File No.: