

SWING TIES

Street:
9886 TIF

PHILBIN AVE

X-Street:
OFFICIAL USE ONLY

RUTLAND AVE

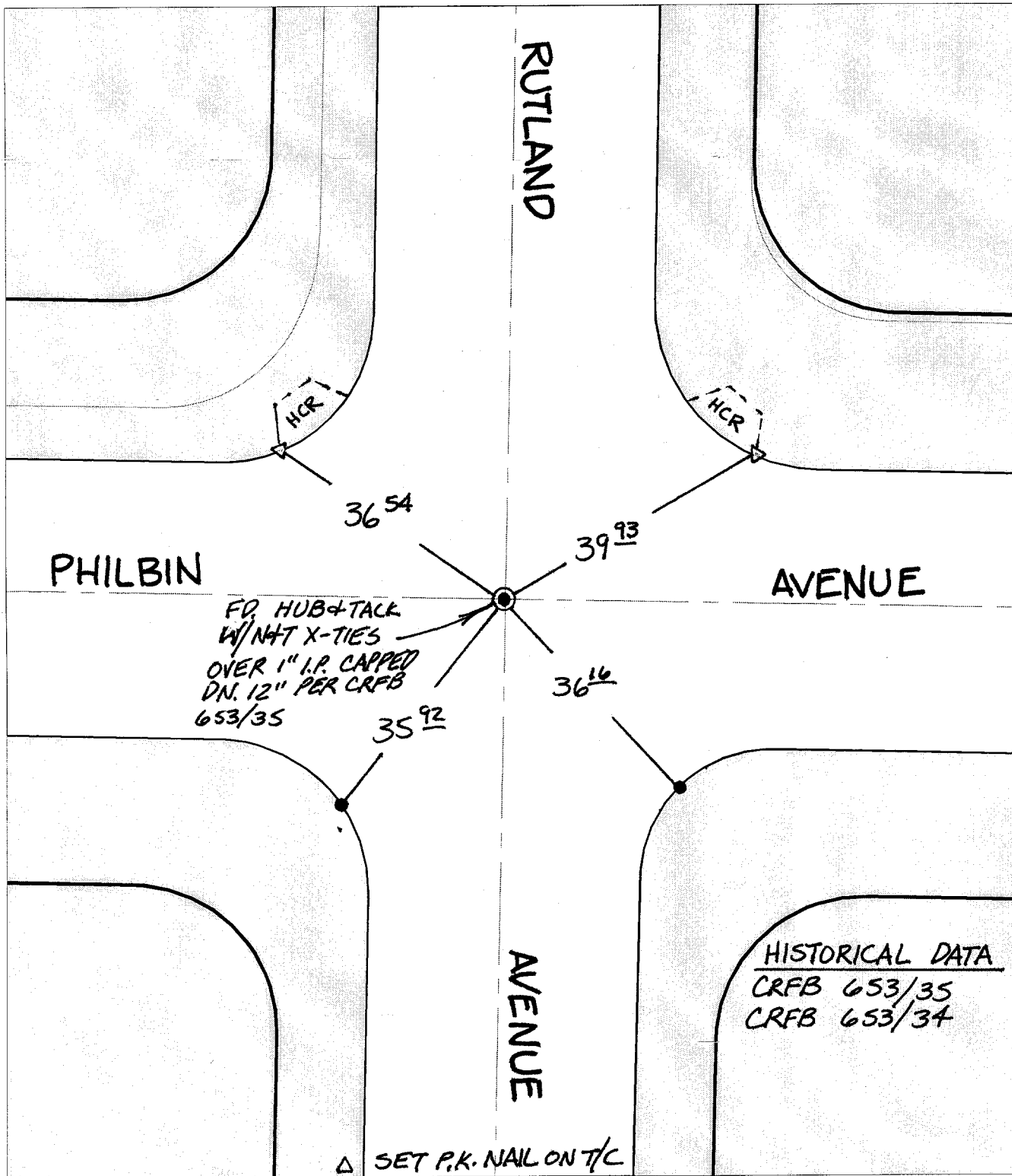

HISTORICAL DATA
CRFB 653/35
CRFB 653/34

△ SET P.K. NAIL ON T/C

✕ FD. Ramset Nail on T/C
■ FD. "C" Nail on T/C

● FD. LD. & TK. on T/C
○ Set LD. & TK. on T/C

P.K. and City Engineer tag to be set @ surface after street construction is complete. (If possible)

Scale: 1" = 20'

Date: 10/22/01

Drawn by: survey

F.B.:

TR-Sec: T3SR6W-1

OFFICIAL TIE PLAT CITY OF RIVERSIDE

These ties are for the purpose of perpetuating the found monumentation. No claim is made as to the relationship of the points or lines shown hereon to true boundary locations.



Sheet 1 of 1

Cadme MB: 49-8