

**SWING TIES**

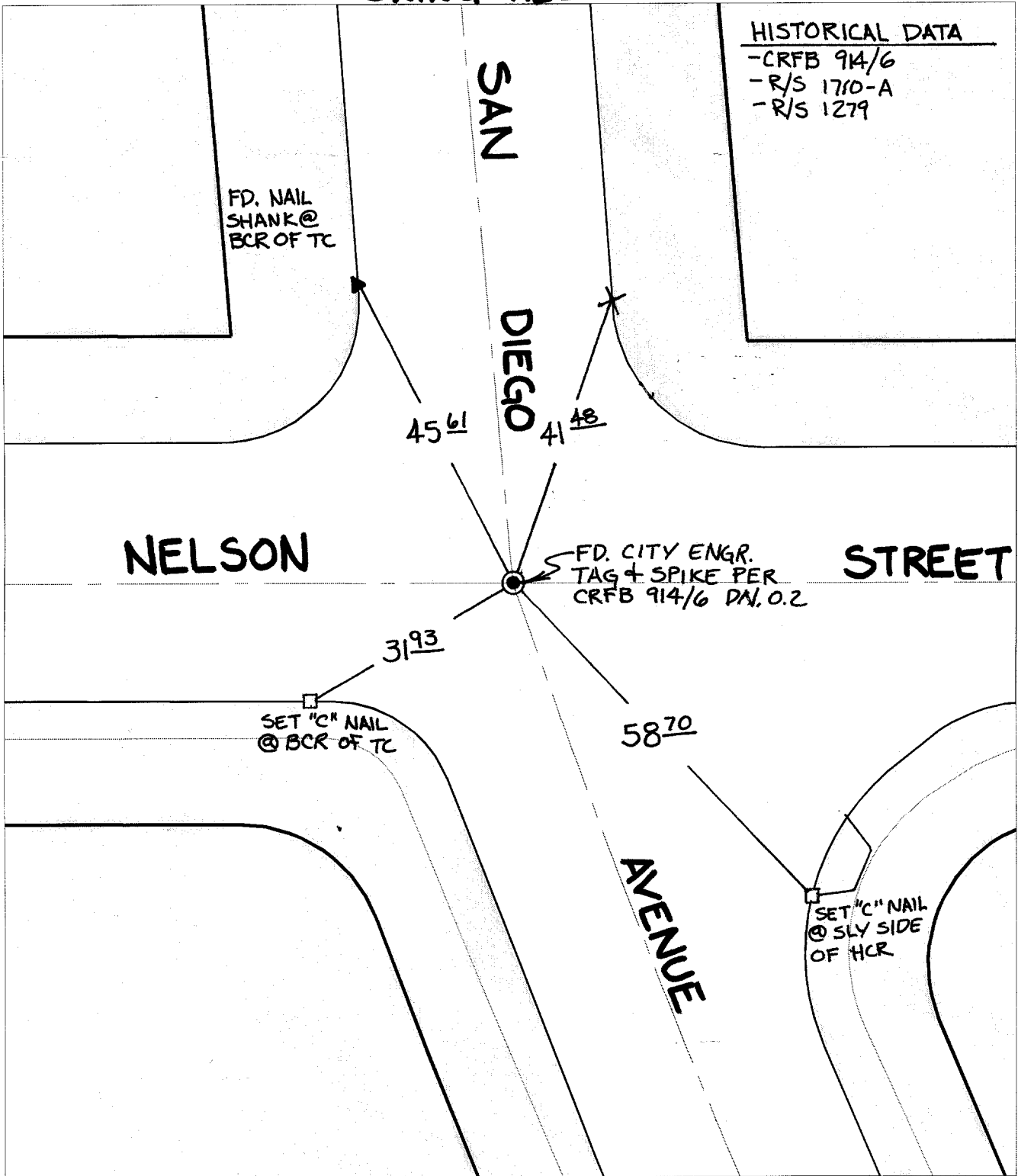

Street: 9890 TIF SAN DIEGO AVENUE  
 X-Street: NELSON STREET  
 OFFICIAL USE ONLY

- ✕ FD. Ramset Nail on T/C    ● FD. LD. & TK. on T/C
- FD. "C" Nail on T/C      ○ Set LD. & TK. on T/C

P.K. and City Engineer tag to be set @ surface after street construction is complete. (If possible)

Scale: 1" = 20'  
 Date: 05/07/01  
 Drawn by: SURVEY  
 F.B.:  
 TR-Sec: T2SR5W-34

**OFFICIAL TIE PLAT**  
 CITY OF RIVERSIDE

*These ties are for the purpose of perpetuating the found monumentation. No claim is made as to the relationship of the points or lines shown hereon to true boundary locations.*



Sheet 1 of 1  
 Cadme MB: 53-4