

**TRANSIT TIES**

HISTORICAL DATA  
CRFB 682/68

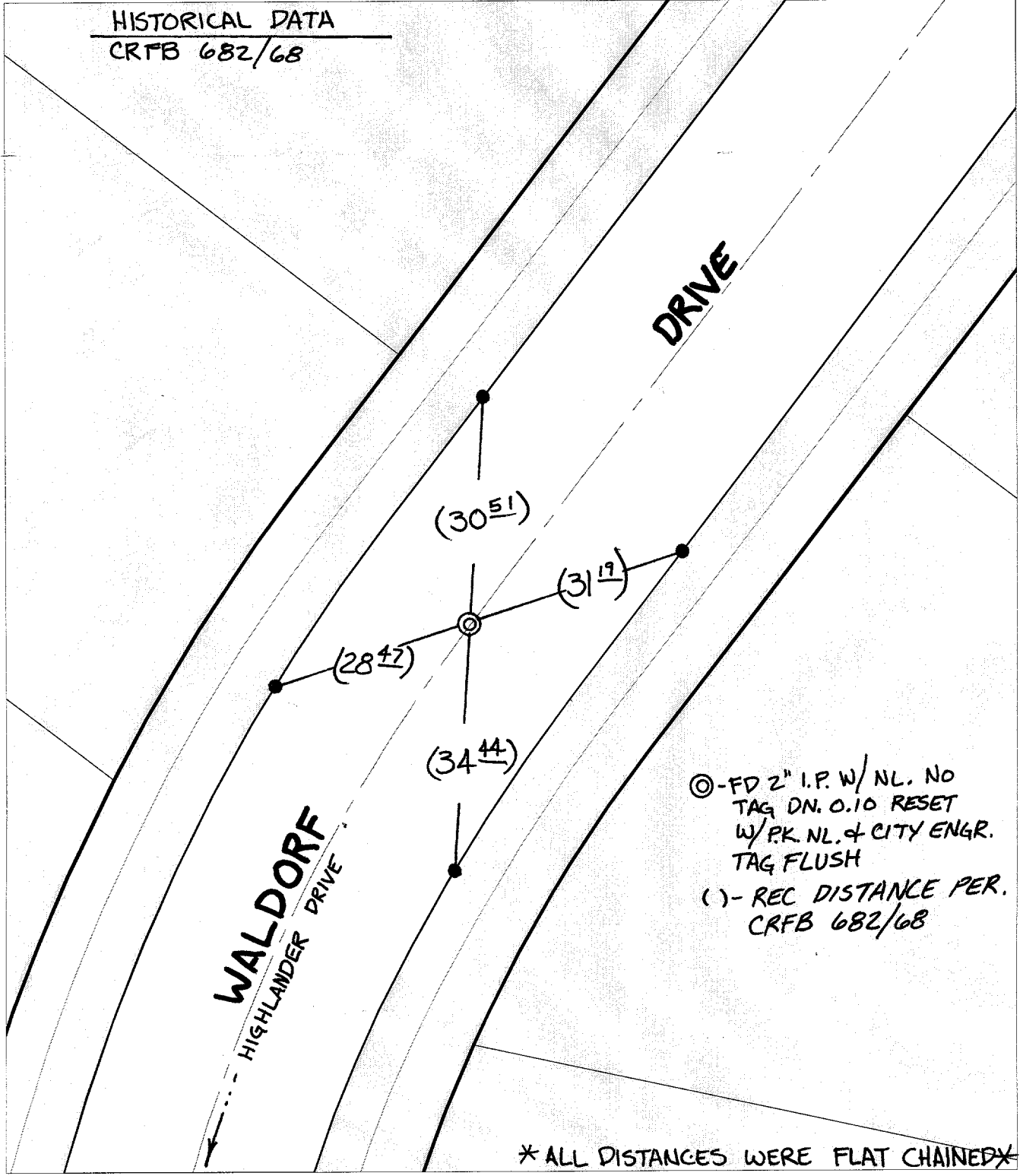

Street: 9909 TIF WALDORF DRIVE EC X-Street N'LY OF HIGHLANDER DR.  
OFFICIAL USE ONLY

⊗ - FD 2" I.P. W/ NL. NO TAG DN. 0.10 RESET W/ P.K. NL. & CITY ENGR. TAG FLUSH  
( ) - REC DISTANCE PER. CRFB 682/68

\* ALL DISTANCES WERE FLAT CHAINED \*

- ⊗ FD. Ramset Nail on T/C      ● FD. LD. & TK. on T/C      P.K. and City Engineer tag to be set @ surface after street construction is complete. (if possible)
- FD. "C" Nail on T/C      ○ Set LD. & TK. on T/C

Scale: 1" = 20'  
Date: 09/11/01  
Drawn by: SURVEY  
F.B.:  
TR-Sec: T2SR4W-20

**OFFICIAL TIE PLAT**  
CITY OF RIVERSIDE



*These ties are for the purpose of perpetuating the found monumentation. No claim is made as to the relationship of the points or lines shown hereon to true boundary locations.*

Sheet 1 of 1  
Cadme MB: 27-7