

TRANSIT TIES

HISTORICAL DATA

-TRACT 7622-1 C.L. TIES FB
1029/243
-MB 87/25-26

() - INDICATES REC. DISTANCE
PER. FB 1029/243

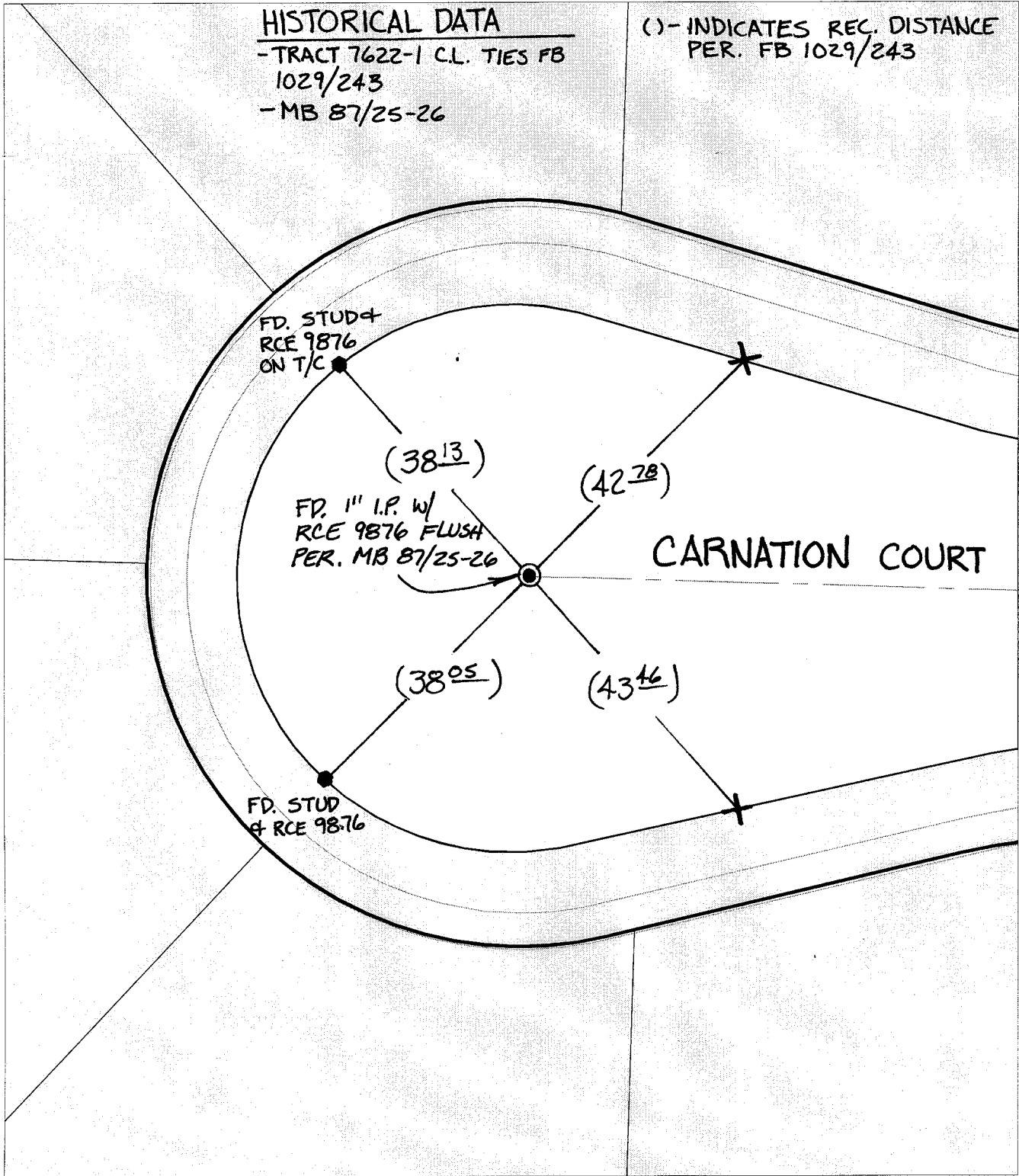

Street:
9925

TIF

CARNATION COURT

OFFICIAL USE ONLY

X-Street:

CUL-DE-SAC

- ✕ FD. Ramset Nail on T/C ● FD. LD. & TK. on T/C
- FD. "C" Nail on T/C ○ Set LD. & TK. on T/C

P.K. and City Engineer tag to be set @ surface after street construction is complete. (If possible)

Scale:
1" = 20'

Date: 04/06/77

Drawn by: SURVEY

F.B.:

TR-Sec: T2SR6W-36

OFFICIAL TIE PLAT CITY OF RIVERSIDE

These ties are for the purpose of perpetuating the found monumentation. No claim is made as to the relationship of the points or lines shown hereon to true boundary locations.



Sheet 1 of 1

Cadme MB: 50-3