

TRANSIT & SWING TIES

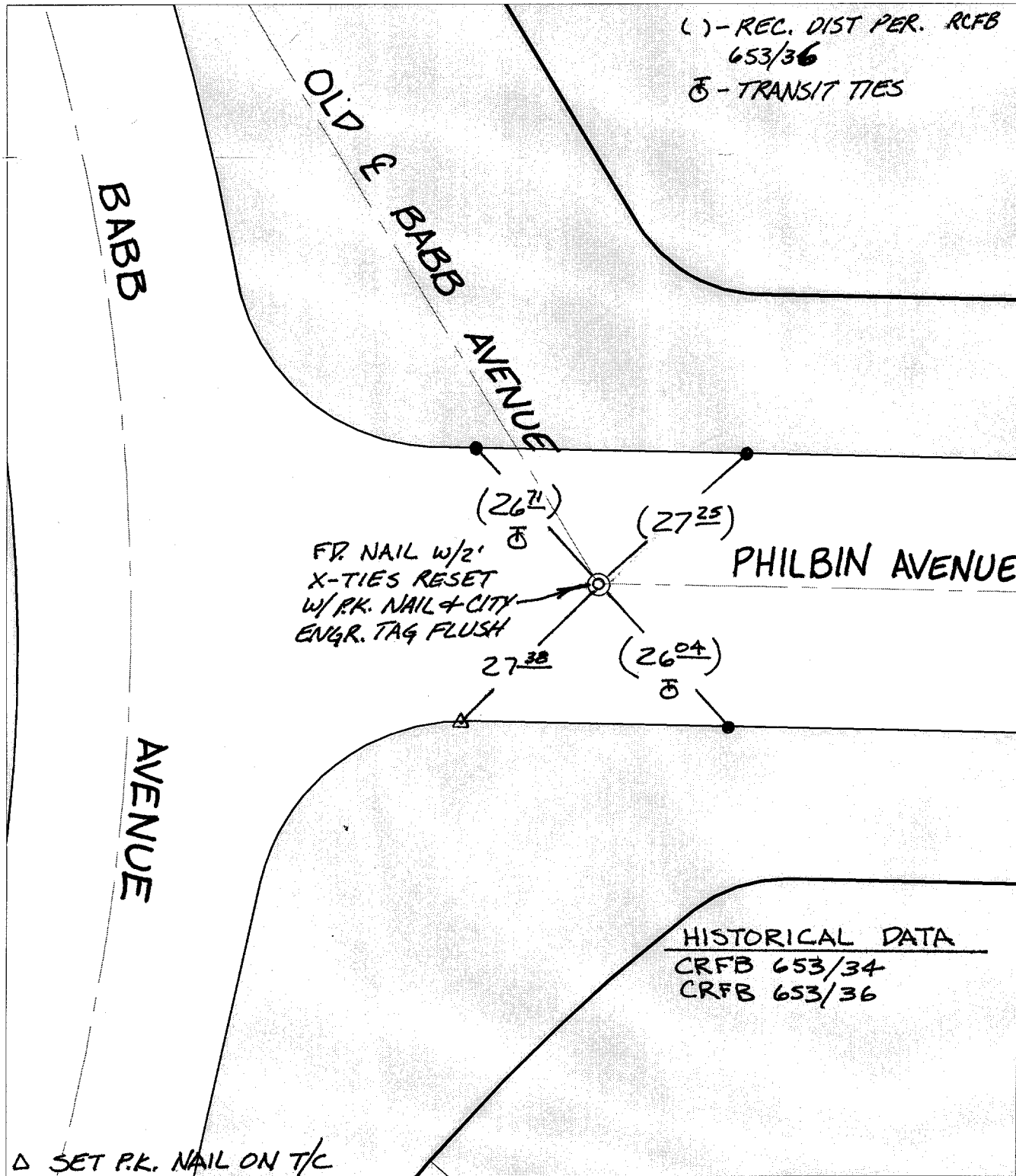

() - REC. DIST PER. RCFB
653/36
⊗ - TRANSIT TIES

FD. NAIL w/2'
X-TIES RESET
w/P.K. NAIL & CITY
ENGR. TAG FLUSH

HISTORICAL DATA
CRFB 653/34
CRFB 653/36

△ SET P.K. NAIL ON T/C

- ⊗ FD. Ramset Nail on T/C ● FD. LD. & TK. on T/C P.K. and City Engineer tag to be set @ surface after street construction is complete. (if possible)
- FD. "C" Nail on T/C ○ Set LD. & TK. on T/C

Street: C9942 PHILBIN AVE X-Street: BABB AVE (OLD CL)
TIF OFFICIAL USE ONLY

Scale: 1" = 20'
Date: 10/22/01
Drawn by: survey
F.B.:
TR-Sec: T3SR6W-1

OFFICIAL TIE PLAT CITY OF RIVERSIDE

These ties are for the purpose of perpetuating the found monumentation. No claim is made as to the relationship of the points or lines shown hereon to true boundary locations.



Sheet 1 of 1
Cadme MB: 49-8