

Street: BLAINE

#8

OFFICIAL USE ONLY

X-Street: INVERNESS ST.

996 TIF

CONYER
ALLEN
CRFB 963/

INDICATES FD. L & T.
IN CURB RET. UNLESS
OTHERWISE NOTED.

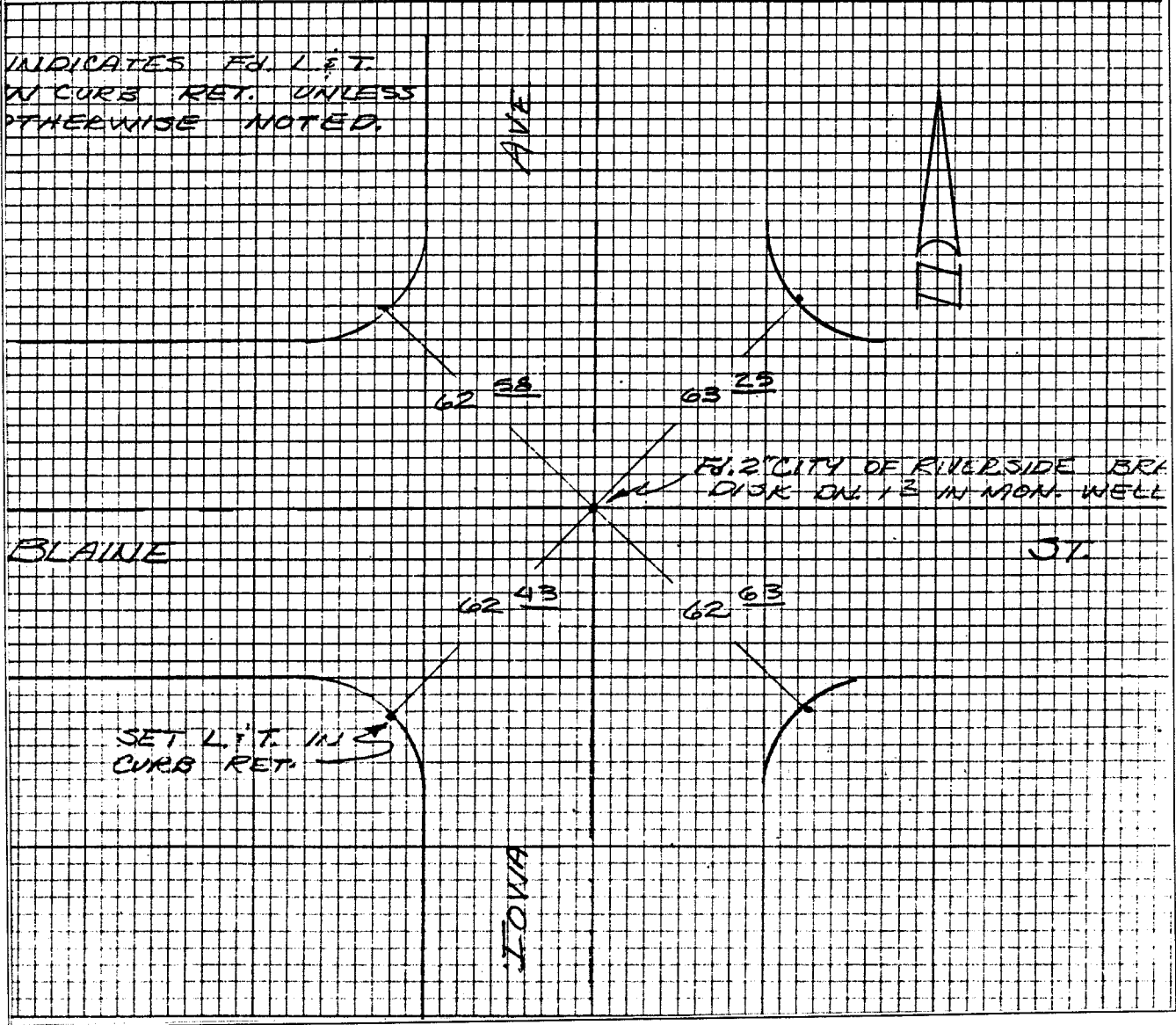

- ✕ FD. Ramset Nail on T/C
- FD. LD. & TK. on T/C
- FD. "C" Nail on T/C
- Set LD. & TK. on T/C

OFFICIAL TIE PLAT CITY OF RIVERSIDE

*These ties are for the purpose of perpetuating the found
monumentation. No claim is made as to the relationship of
the points or lines shown hereon to true boundary locations.*

Scale:
Date:
Drawn by:
W.O.:
F.B.:

Sheet 1 of 1
File No.: