

C10914.TIF

Street:

SEDGWICK AVENUE

X-Street: R. BNDY. S. OF CARLTON

OFFICIAL USE ONLY

TRANSIT TIES

REF.: CRFB 977/35
MB 24/49
MB 16/55

() - INDICATES REC.
DIST. PER. CRFB
977/35

⊙ - FD. NOTHING @
SURFACE RESET
W/ P.K. NAIL +
CITY ENGR. TAG
FLUSH

- ✕ FD. Ramset Nail on T/C ● FD. LD. & TK. on T/C
- FD. "C" Nail on T/C ○ Set LD. & TK. on T/C

P.K. and City Engineer tag to be set @
surface after street construction is
complete. (If possible)

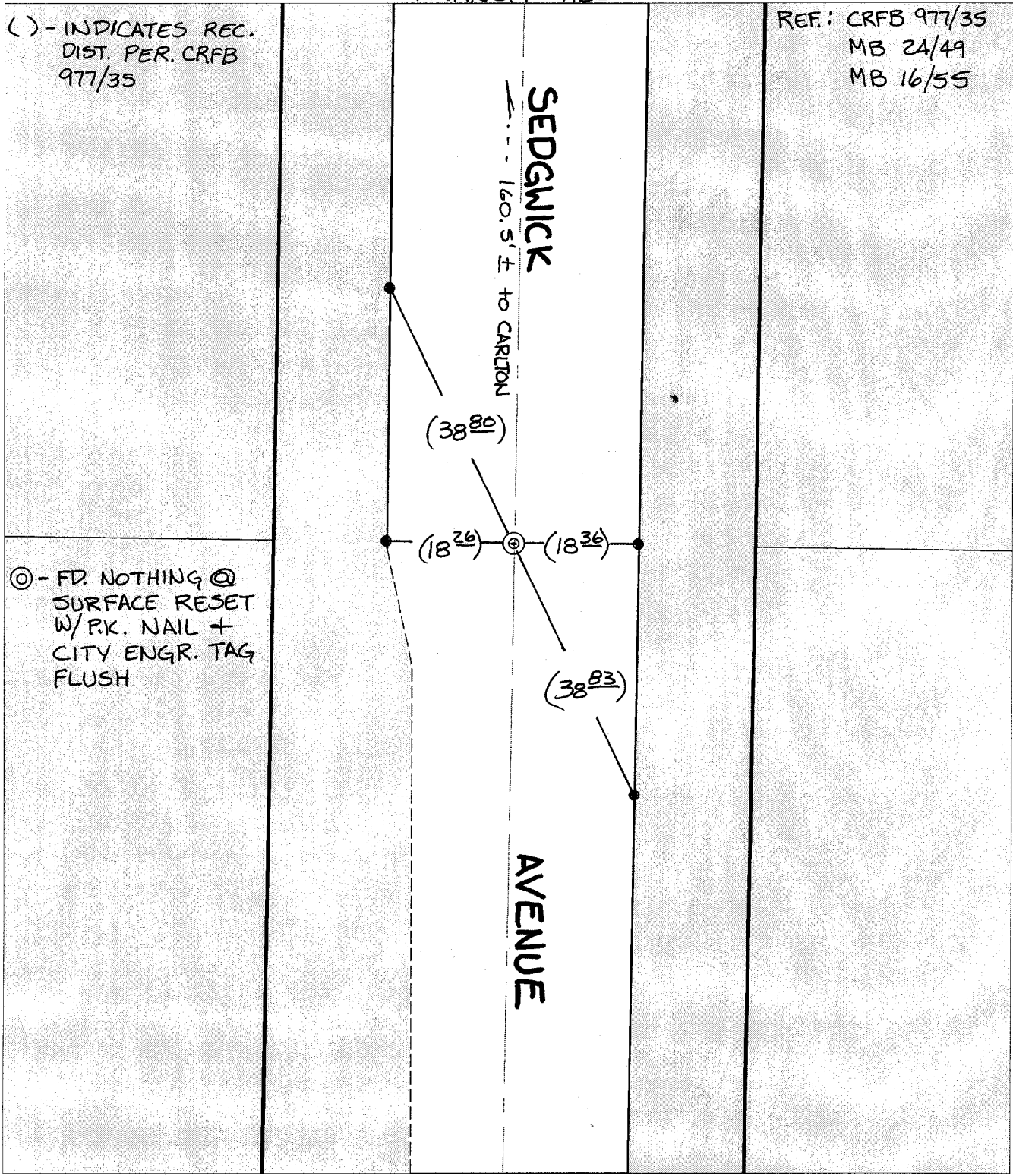

Scale: 1" = 20'

Date: 03/06/03

Drawn by: SURVEY

F.B.:

TR-Sec: T2SR5W-25

OFFICIAL TIE PLAT

CITY OF RIVERSIDE

*These ties are for the purpose of perpetuating the found
monumentation. No claim is made as to the relationship of
the points or lines shown hereon to true boundary locations.*



Sheet 1 of 1

Cadme MB: 40-5