

C10969.TIF

Street:

LAKEHILL PLACE

X-Street: B.C. SOUTH OF LAKEHILL
OFFICIAL USE ONLY

SWING TIES

150' to LAKEHILL COURT

LAKEHILL

PLACE

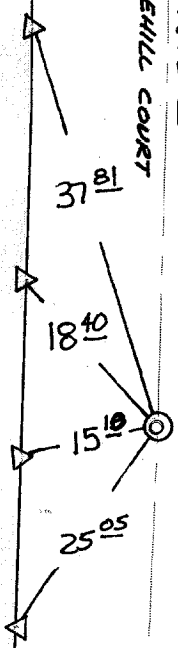

© F.D. 3/4" I.P.
D.N.O. 25' RESET
W/P.K. NAIL + CITY
ENGR. TAG FLUSH
3-06-03

△ SET P.K. NAIL ON T/C

- × FD. Ramset Nail on T/C
- FD. LD. & TK. on T/C
- FD. "C" Nail on T/C
- Set LD. & TK. on T/C

P.K. and City Engineer tag to be set @ surface after street construction is complete. (if possible)

Scale: 1" = 20'
 Date: 04/25/02
 Drawn by: SURVEY
 F.B.:
 TR-Sec: -

OFFICIAL TIE PLAT

CITY OF RIVERSIDE

These ties are for the purpose of perpetuating the found monumentation. No claim is made as to the relationship of the points or lines shown hereon to true boundary locations.



Sheet 1 of 1
 Cadme MB: 24-3