

11491.TIF

Street:

ALTADENA DRIVE

X-Street:

BISCAYNE AVENUE

OFFICIAL USE ONLY

TRANSIT & SWING TIES

FD NOTHING @ SURFACE

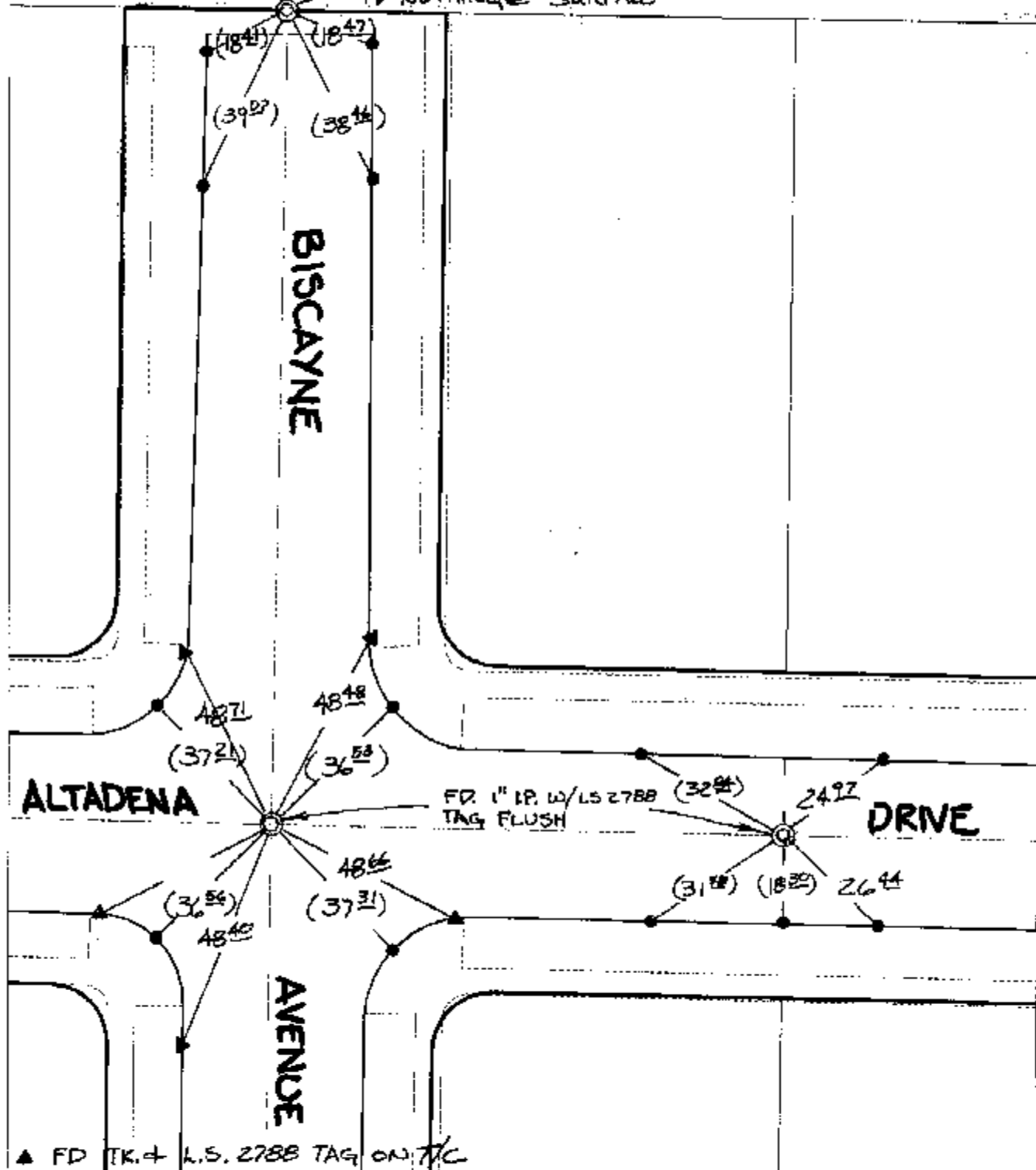

- ▲ FD TK. & L.S. 2788 TAG ON T/C
- × FD. Ramset Nail on T/C
- FD. LD. & TK. on T/C
- FD. "C" Nail on T/C
- Set LD. & TK. on T/C
- P.K. and City Engineer tag to be set @ surface after street construction is complete. (if possible)

Scale: 1" = 30'

Date: 08/20/02

Drawn by: SURVEY

F.B.:

TR-Sec: T2SR6W-36

## OFFICIAL TIE PLAT

### CITY OF RIVERSIDE

*These ties are for the purpose of perpetuating the found monumentation. No claim is made as to the relationship of the points or lines shown hereon to true boundary locations.*



Sheet 1 of 1

Cadme MB: 49-2