

Street:

INNER CIRCLE DRIVE (w/ly) X-Street: BC & EC N. OF KNUCKLE

OFFICIAL USE ONLY

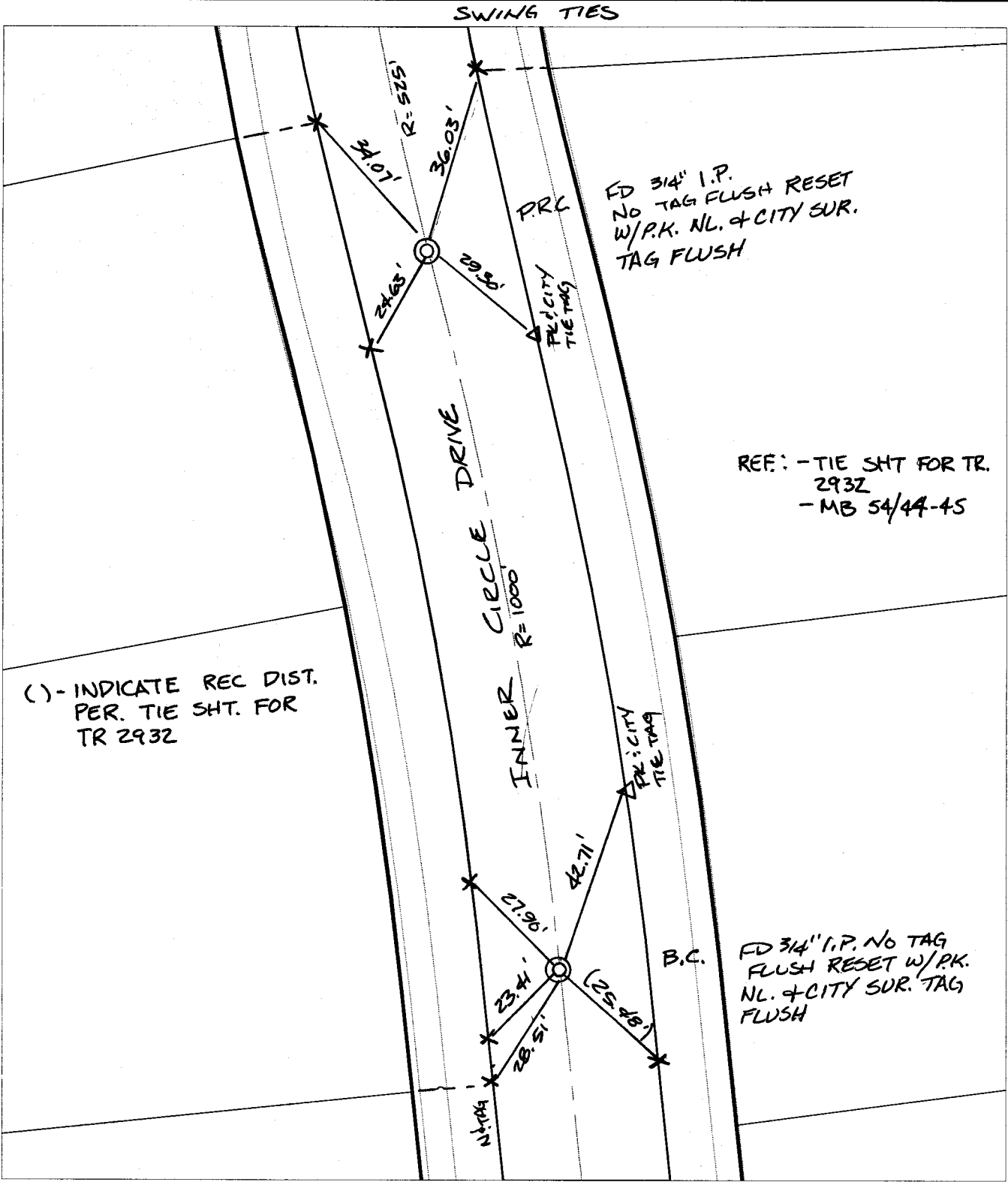

() - INDICATE REC DIST. PER. TIE SHT. FOR TR 2932

REF.: -TIE SHT FOR TR. 2932
-MB 54/44-45

FD 3/4" I.P. NO TAG FLUSH RESET W/PK. NL. & CITY SUR. TAG FLUSH

- ✕ FD. Ramset Nail on T/C
- FD. LD. & TK. on T/C
- FD. "C" Nail on T/C
- Set LD. & TK. on T/C
- P.K. and City Engineer tag to be set @ surface after street construction is complete. (If possible)

Scale: 1" = 30'

Date: 01/30/03

Drawn by: SURVEY

F.B.:

TR-Sec: T2SR4W-31

OFFICIAL TIE PLAT

CITY OF RIVERSIDE

These ties are for the purpose of perpetuating the found monumentation. No claim is made as to the relationship of the points or lines shown hereon to true boundary locations.



Sheet 1 of 1

Cadme MB: 56-3