

Street: GAINSBOROUGH DRIVE X-Street: BC SE OF HAWARDEN
OFFICIAL USE ONLY

SWING TIES

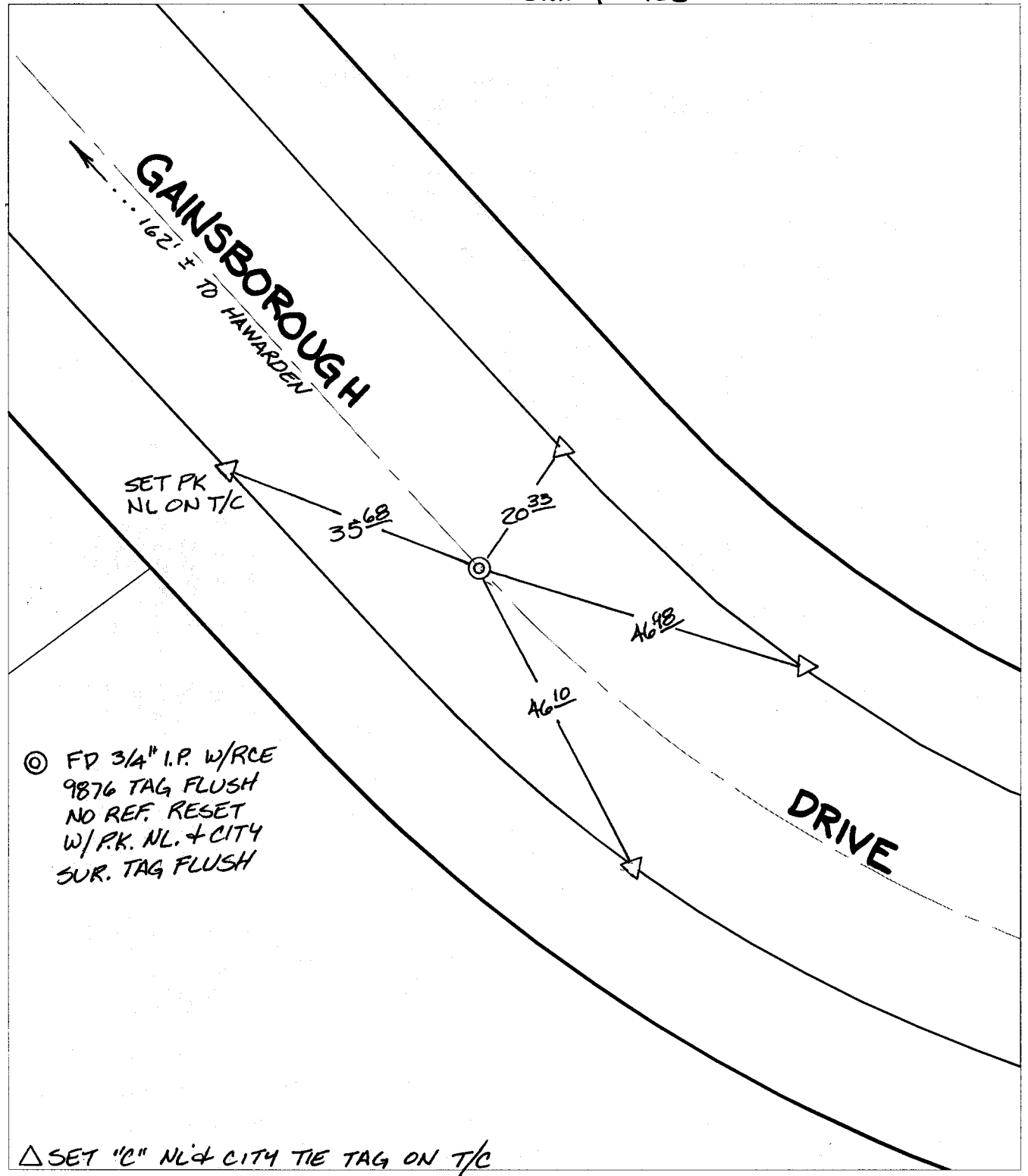

⊗ FD 3/4" I.P. W/RCE
 9876 TAG FLUSH
 NO REF. RESET
 W/P.K. NL. + CITY
 SUR. TAG FLUSH

△ SET "C" NL & CITY TIE TAG ON T/C

- × FD. Ramset Nail on T/C
 - FD. LD. & TK. on T/C
 - FD. "C" Nail on T/C
 - Set LD. & TK. on T/C
- P.K. and City Engineer tag to be set @ surface after street construction is complete. (If possible)

Scale: 1" = 20'
 Date: 02/24/04
 Drawn by: SURVEY
 F.B.:
 TR-Sec: T3SR5W-11

OFFICIAL TIE PLAT
CITY OF RIVERSIDE

These ties are for the purpose of perpetuating the found monumentation. No claim is made as to the relationship of the points or lines shown hereon to true boundary locations.

Sheet 1 of 1
 Cadme MB: 69-4