

Street:

QUENTON DRIVE

OFFICIAL USE ONLY

X-Street R BNDY S. OF BROOKWAY

TRANSIT + SWING TIES

( ) - RECORD DIST PER TIE SHT FOR TR 8006-1 MB 94/54-58

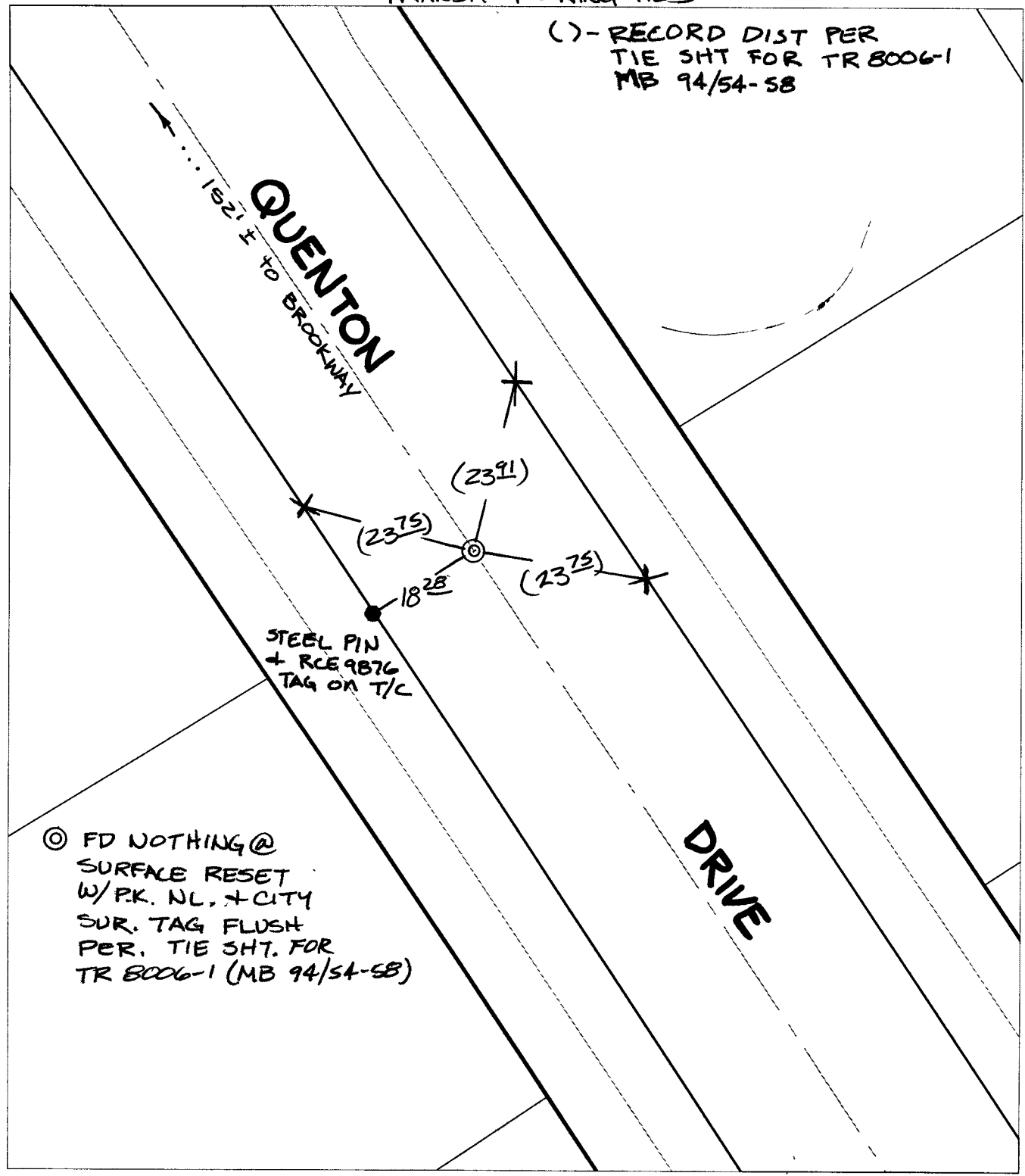

⊙ FD NOTHING @ SURFACE RESET W/PK. NL. + CITY SUR. TAG FLUSH PER. TIE SHT. FOR TR 8006-1 (MB 94/54-58)

- ✕ FD. Ramset Nail on T/C
- FD. LD. & TK. on T/C
- Set LD. & TK. on T/C
- FD. "C" Nail on T/C
- P.K. and City Engineer tag to be set @ surface after street construction is complete. (If possible)

Scale: 1" = 20'

Date: 11/20/04

Drawn by: survey

F.B.:

TR-Sec: T3SR6W-12

**OFFICIAL TIE PLAT**  
CITY OF RIVERSIDE

*These ties are for the purpose of perpetuating the found monumentation. No claim is made as to the relationship of the points or lines shown hereon to true boundary locations.*

Sheet 1 of 1

Cadme MB: 64-6