

Street:

BRODERICK DRIVE

OFFICIAL USE ONLY

X-Street:

BC & EC S. OF HOLE

TRANSIT + SWING TIES

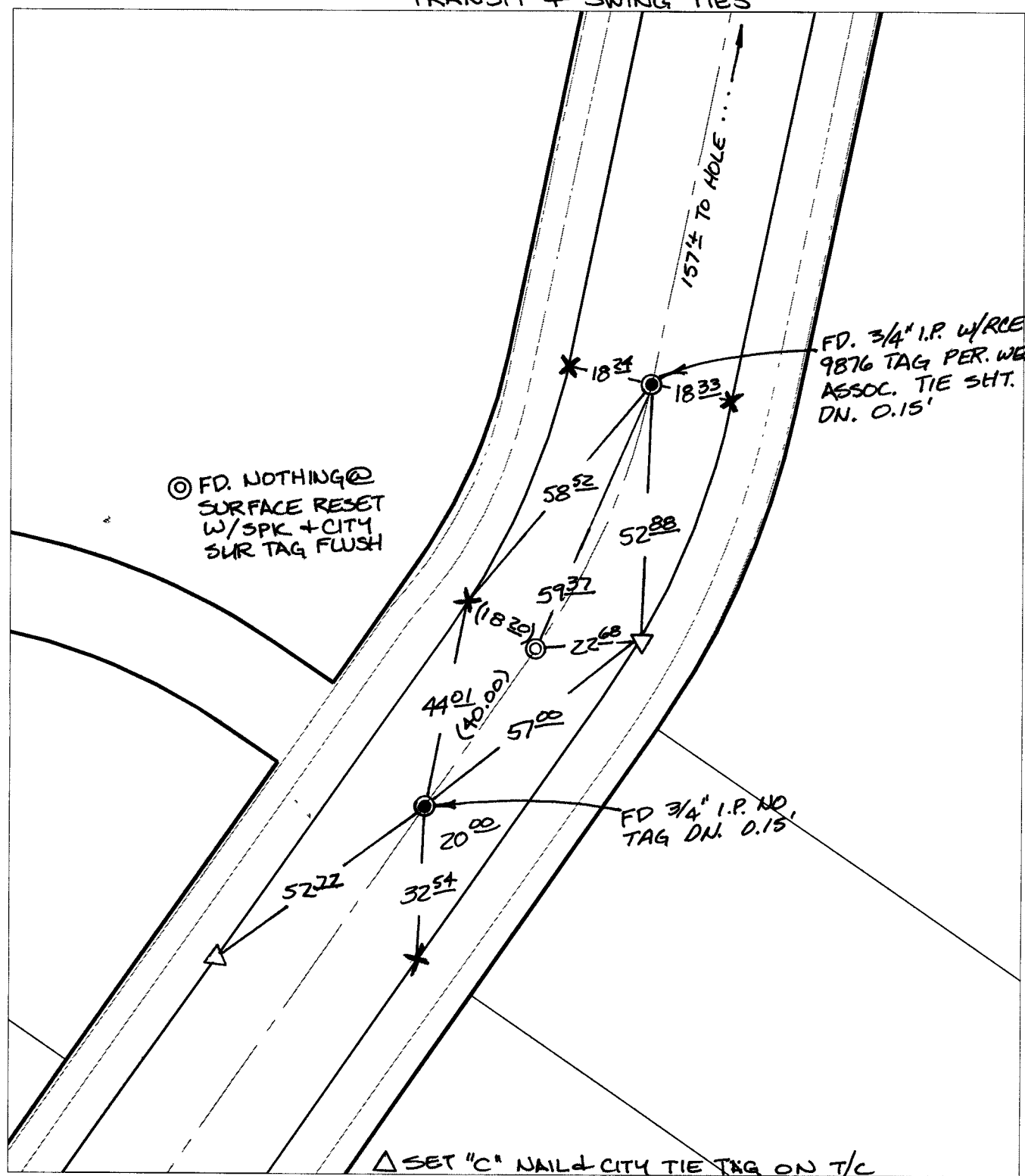

◎ FD. NOTHING @ SURFACE RESET W/SPK + CITY SUR TAG FLUSH

FD. 3/4" I.P. W/RCE 9876 TAG PER. WEBB ASSOC. TIE SH. DN. 0.15'

FD 3/4" I.P. NO. TAG DN. 0.15'

△ SET "C" NAIL & CITY TIE TAG ON T/C

- ✕ FD. Ramset Nail on T/C
- FD. LD. & TK. on T/C
- Set LD. & TK. on T/C
- FD. "C" Nail on T/C
- P.K. and City Engineer tag to be set @ surface after street construction is complete. (If possible)

Scale: 1" = 30'

Date: 11/20/04

Drawn by: survey

F.B.:

TR-Sec: T3SR6W-11

OFFICIAL TIE PLAT
CITY OF RIVERSIDE

These ties are for the purpose of perpetuating the found monumentation. No claim is made as to the relationship of the points or lines shown hereon to true boundary locations.



Sheet 1 of 1

Cadme MB: 64-7