

Street:

PENDLETON STREET

X-Street:

RUPLEY PLACE

OFFICIAL USE ONLY

SWING TIES

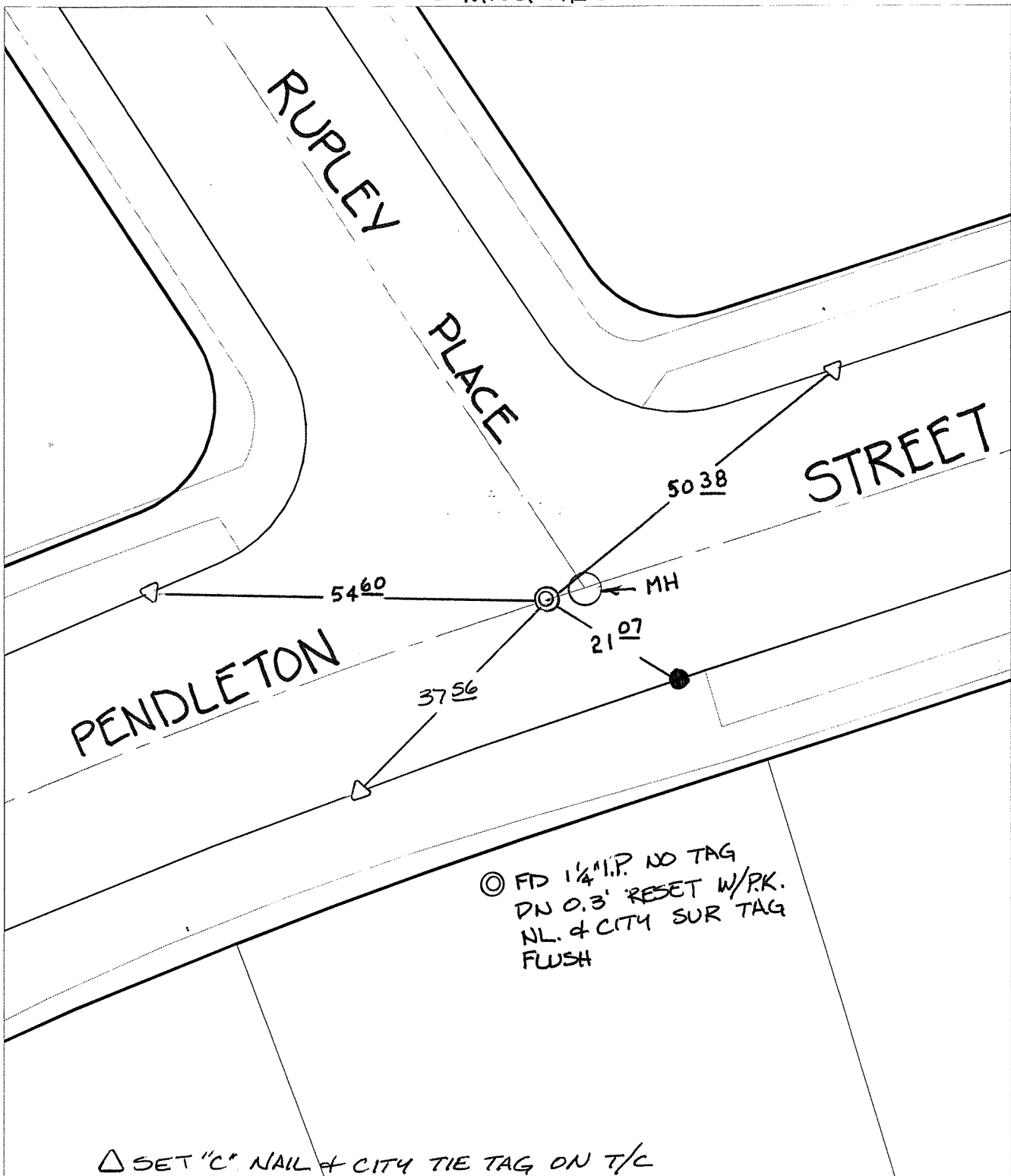

© FD 1 1/4" I.P. NO TAG  
 DN 0.3' RESET W/RK.  
 NL. & CITY SUR TAG  
 FLUSH

△ SET "C" NAIL & CITY TIE TAG ON T/C

- × FD. Ramset Nail on T/C    ● FD. LD. & TK. on T/C
- FD. "C" Nail on T/C      ○ Set LD. & TK. on T/C

P.K. and City Engineer tag to be set @ surface after street construction is complete. (If possible)

Scale: 1" = 20'

Date: 06/10/08

Drawn by: pw

F.B.:

TR-Sec: T3SR6W-14

## OFFICIAL TIE PLAT

### CITY OF RIVERSIDE

*These ties are for the purpose of perpetuating the found monumentation. No claim is made as to the relationship of the points or lines shown hereon to true boundary locations.*



Sheet 1 of 1

Cadme MB: 79-2