

Street:

LOCKEY AVENUE

OFFICIAL USE ONLY

X-Street:

HINES AVENUE

TRANSIT & SWING TIES

( ) REC. DIST. PER. CITY TIE SHT.

FD. NOTHING @ SURFACE RESET W/ P.K. NL. & CITY SUR TAG FLUSH

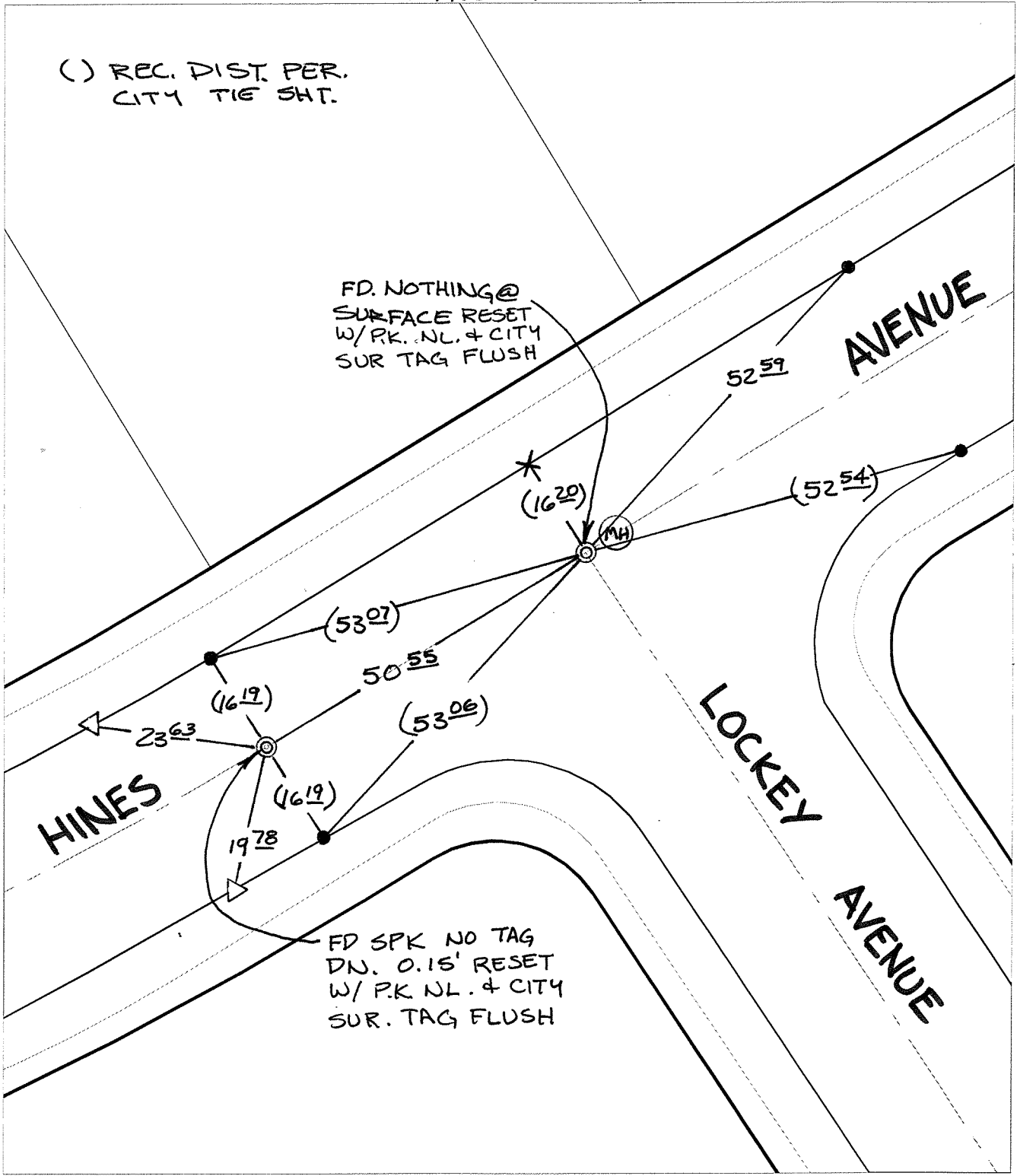

FD SPK NO TAG DN. 0.15' RESET W/ P.K. NL. & CITY SUR. TAG FLUSH

- × FD. Ramset Nail on T/C
- FD. LD. & TK. on T/C
- FD. "C" Nail on T/C
- Set LD. & TK. on T/C

P.K. and City Engineer tag to be set @ surface after street construction is complete. (If possible)

Scale: 1" = 20'

Date: 08/09/05

Drawn by: SURVEY

F.B.:

TR-Sec: T3SR6W-14

## OFFICIAL TIE PLAT

### CITY OF RIVERSIDE

*These ties are for the purpose of perpetuating the found monumentation. No claim is made as to the relationship of the points or lines shown hereon to true boundary locations.*



Sheet 1 of 1

Cadme MB: 64-8