

C/2417.71F

Street:

POLK ST

X-Street:  
OFFICIAL USE ONLY

PENDLETON ST

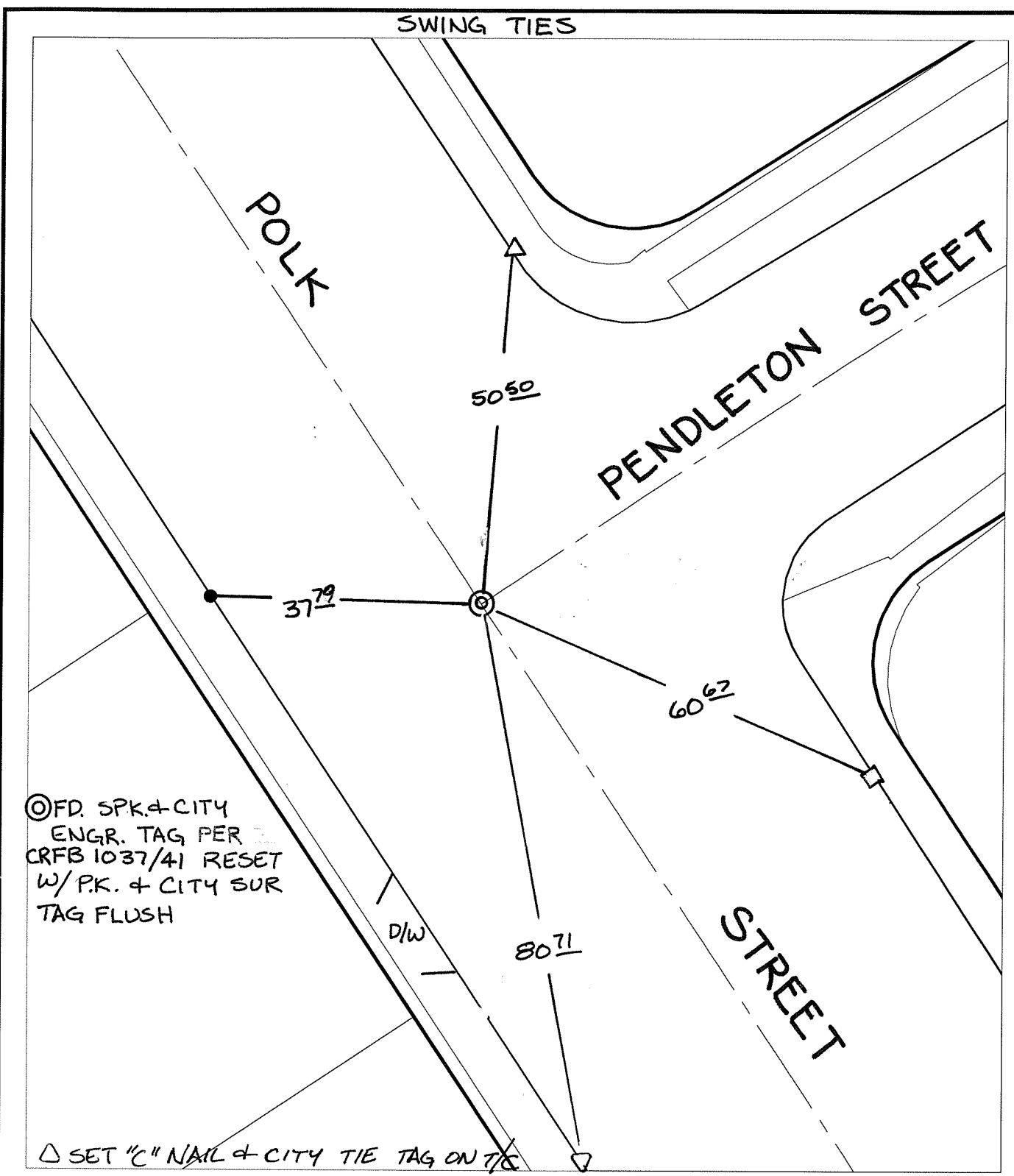

- ✕ FD. Ramset Nail on T/C    ● FD. LD. & TK. on T/C    P.K. and City Engineer tag to be set @ surface after street construction is complete. (if possible)
- FD. "C" Nail on T/C    ○ Set LD. & TK. on T/C

Scale: 1" = 20'

Date: 09/07/07

Drawn by: scurtis

F.B.:

TR-Sec: T3SR6W-14

**OFFICIAL TIE PLAT**  
CITY OF RIVERSIDE

*These ties are for the purpose of perpetuating the found monumentation. No claim is made as to the relationship of the points or lines shown hereon to true boundary locations.*

Sheet 1 of 1  
Cadme MB: 79-2