

C/2550. TIF

Street: HOLLY LANE
X-Street: TREBOR ROAD
OFFICIAL USE ONLY

SWING TIES

HISTORICAL DATA
CRFB 630/17

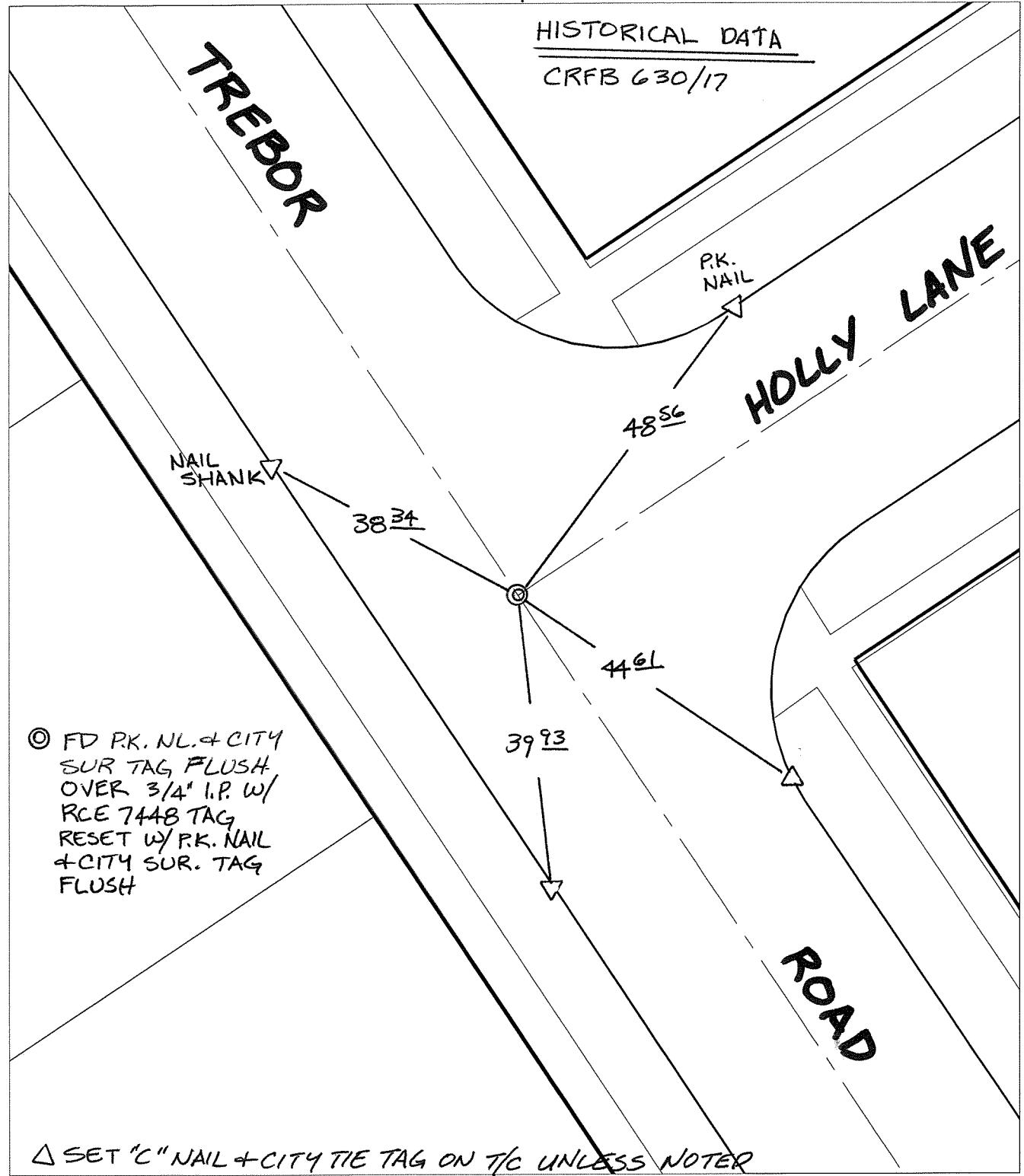

⊗ FD P.K. NL. & CITY
SUR TAG FLUSH
OVER 3/4" I.P. W/
RCE 7448 TAG
RESET W/ P.K. NAIL
& CITY SUR. TAG
FLUSH

△ SET "C" NAIL & CITY TIE TAG ON T/C UNLESS NOTED

- ⊗ FD. Ramset Nail on T/C
- FD. LD. & TK. on T/C
- FD. "C" Nail on T/C
- Set LD. & TK. on T/C

P.K. and City Engineer tag to be set @
surface after street construction is
complete. (If possible)

Scale: 1" = 20'
Date: 03/04/08
Drawn by: pw
F.B.:
TR-Sec: T3SR5W-6

OFFICIAL TIE PLAT
CITY OF RIVERSIDE

*These ties are for the purpose of perpetuating the found
monumentation. No claim is made as to the relationship of
the points or lines shown hereon to true boundary locations.*



Sheet 1 of 1
Cadme MB: 51-7