

C/2569. 71E

Street:

PARK SIERRA DRIVE

X-Street:

DIANA AVENUE

OFFICIAL USE ONLY

SWING TIES

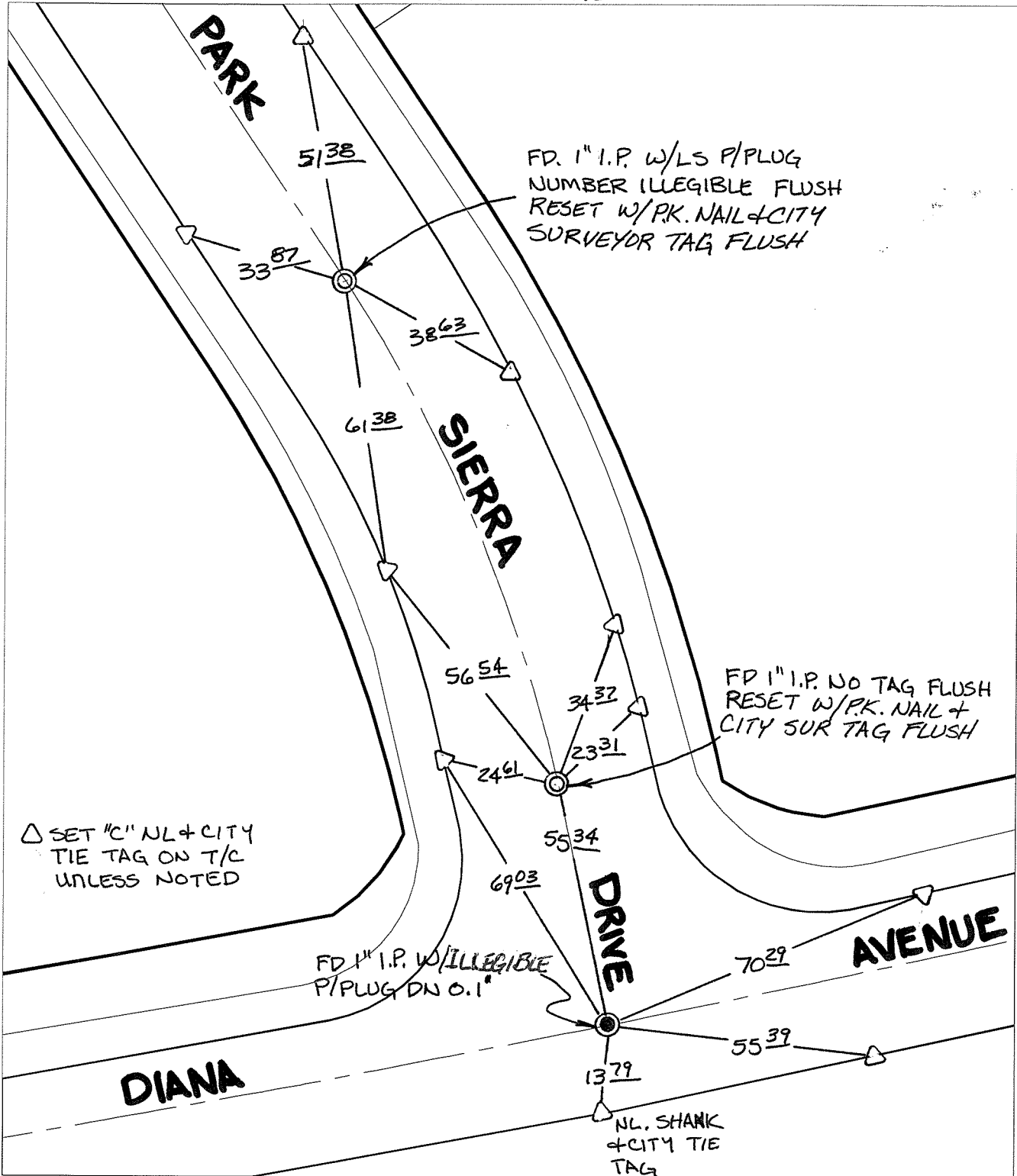

△ SET "C" NL + CITY TIE TAG ON T/C UNLESS NOTED

FD. 1" I.P. W/LS P/PLUG NUMBER ILLEGIBLE FLUSH RESET W/PK. NAIL + CITY SURVEYOR TAG FLUSH

FD. 1" I.P. NO TAG FLUSH RESET W/PK. NAIL + CITY SUR TAG FLUSH

FD. 1" I.P. W/ILLEGIBLE P/PLUG DN 0.1"

NL. SHANK + CITY TIE TAG

- × FD. Ramset Nail on T/C ● FD. LD. & TK. on T/C P.K. and City Engineer tag to be set @ surface after street construction is complete. (if possible)
- FD. "C" Nail on T/C ○ Set LD. & TK. on T/C

Scale: 1" = 30'

Date: 05/21/08

Drawn by: pw

F.B.:

TR-Sec: T3SR6W-24

OFFICIAL TIE PLAT

CITY OF RIVERSIDE

These ties are for the purpose of perpetuating the found monumentation. No claim is made as to the relationship of the points or lines shown hereon to true boundary locations.



Sheet 1 of 1
Cadme MB: 79-6