

# SWING TIES

C12604.TIF

STREET: MAGNOLIA AVENUE

OFFICIAL USE ONLY

X-STREET: MERRILL AVENUE

**HISTORICAL DATA**  
5278.TIF

FD PK & CITY ENGINEER  
TAG FLUSH FITS TIES PER  
5278.TIF  
SET P.K. NAIL &  
CITY SURVEYOR TAG  
FLUSH IN ASPHALT  
AFTER CONSTRUCTION  
04/26/2012

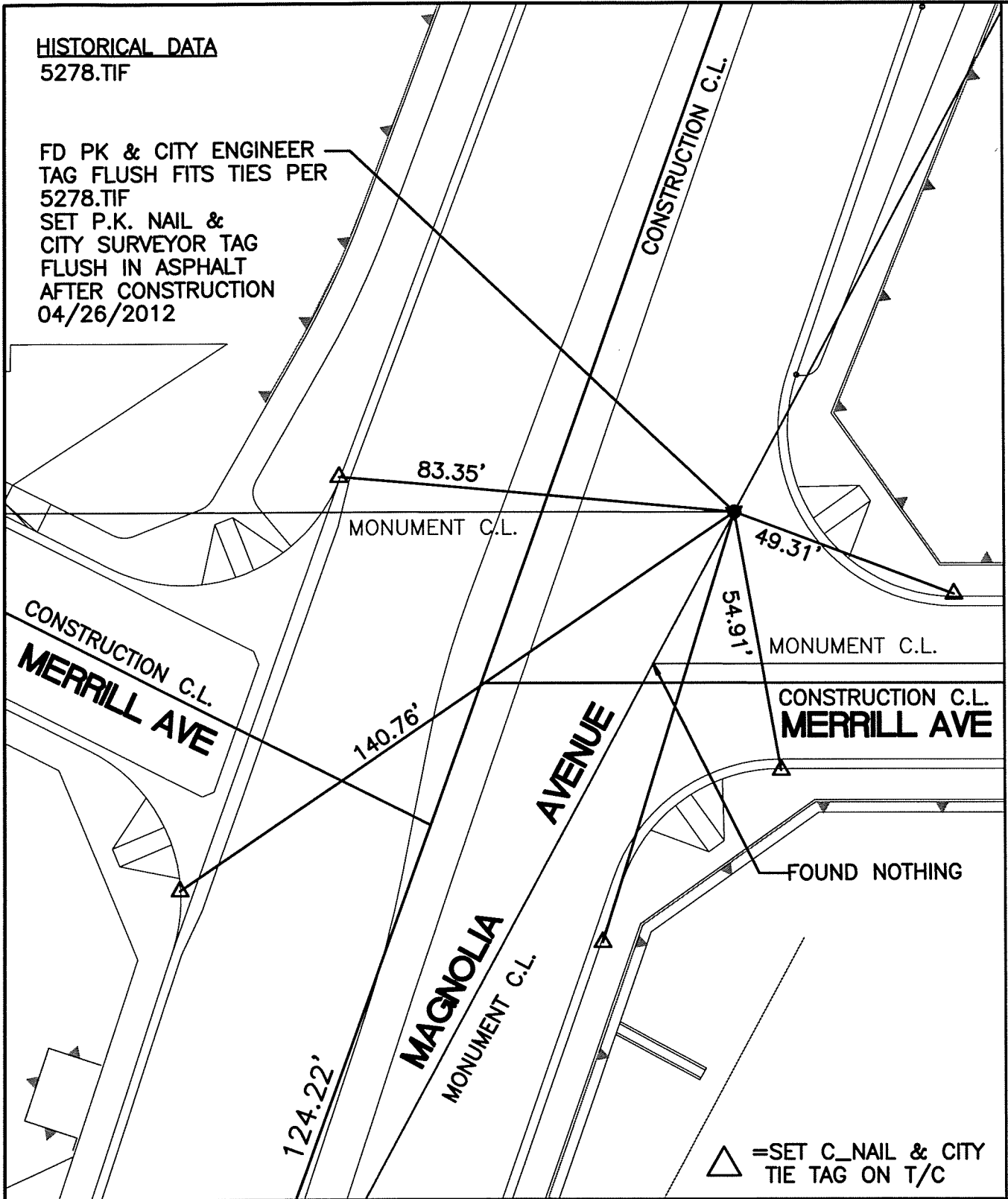

SCALE: 1"=30'  
DATE: 5/07/12  
DRAWN BY: B DURENTE  
F.B.: SEE HISTORICAL DATA  
SEC: 34 T.2S.,R.5W

**OFFICIAL TIE PLAT**  
CITY OF RIVERSIDE

THESE TIES ARE FOR THE PURPOSE OF PERPETUATING THE FOUND MONUMENTATION. NO CLAIM IS MADE AS THE RELATIONSHIP OF THE POINTS OR LINES SHOWN HEREON TO TRUE BOUNDARY LOCATIONS

SHEET 1 OF 1