

Street: CALIFORNIA AVENUE
 X-Street: JACKSON STREET
 OFFICIAL USE ONLY

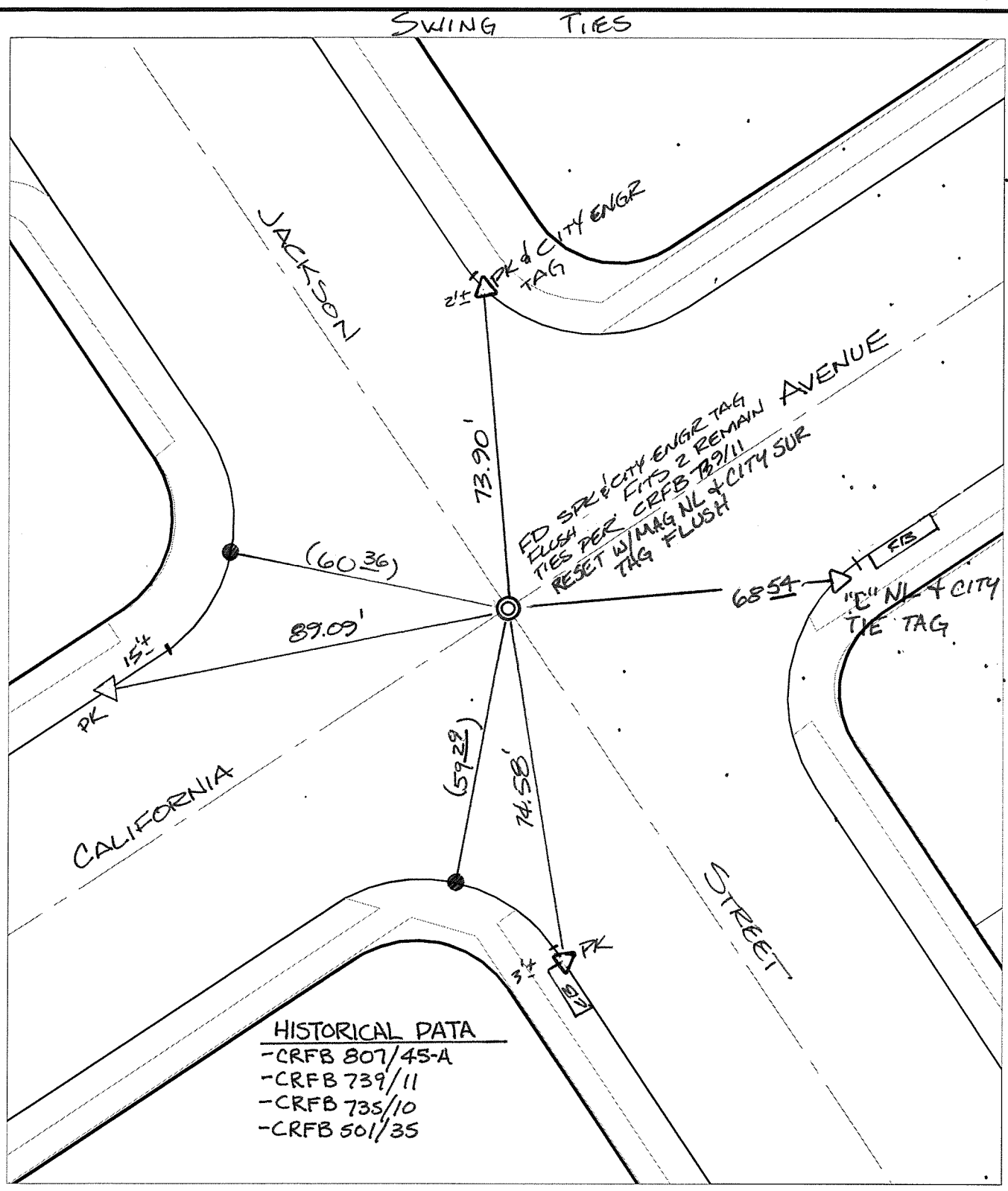

✕ FD. Ramset Nail on T/C ● FD. LD. & TK. on T/C P.K. and City Engineer tag to be set @
 ■ FD. "C" Nail on T/C ○ Set LD. & TK. on T/C surface after street construction is
 complete. (If possible)

Scale: 1" = 30'
 Date: 01/18/02
 Drawn by: SURVEY
 F.B.:
 TR-Sec: T3SR5W-6

OFFICIAL TIE PLAT
CITY OF RIVERSIDE
*These ties are for the purpose of perpetuating the found
 monumentation. No claim is made as to the relationship of
 the points or lines shown hereon to true boundary locations.*

Sheet 1 of 1
 Cadme MB: 66-1