

C/2715.71F

Street: WELLS AVENUE

X-Street: MONTGOMERY STREET
OFFICIAL USE ONLY

TRANSIT & SWING TIES

HISTORICAL DATA
SIERRA FOOTHILLS
NO. 11
CRFB 940/77,78

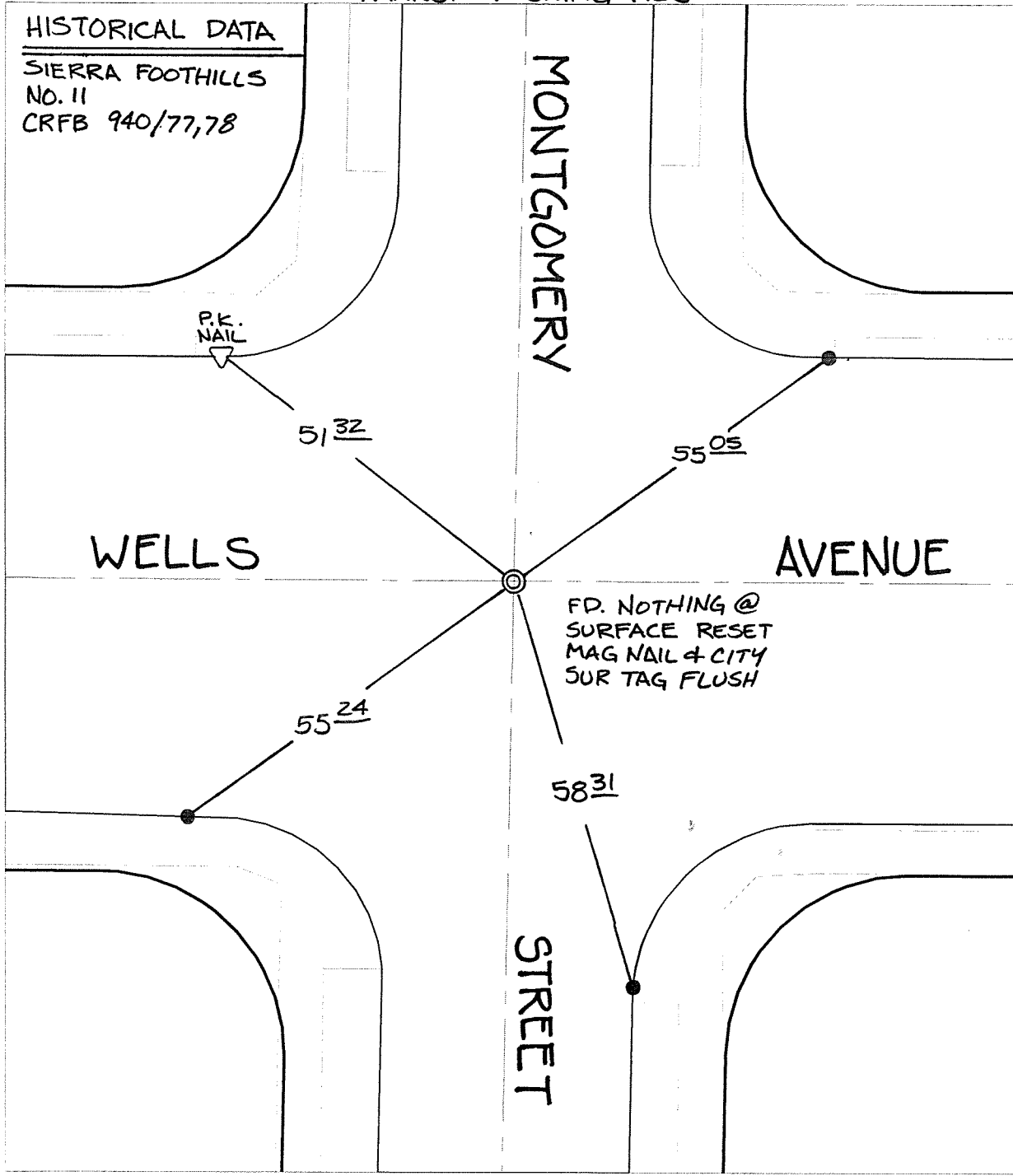

X FD. Ramset Nail on T/C ● FD. LD. & TK. on T/C P.K. and City Engineer tag to be set @
 ■ FD. "C" Nail on T/C ○ Set LD. & TK. on T/C surface after street construction is
 complete. (If possible)

Scale: 1" = 20'
 Date: 05/03/12
 Drawn by: pw
 F.B.:
 TR-Sec: T3SR6W-1

OFFICIAL TIE PLAT
CITY OF RIVERSIDE
*These ties are for the purpose of perpetuating the found
 monumentation. No claim is made as to the relationship of
 the points or lines shown hereon to true boundary locations.*

Sheet 1 of 1
 Cadme MB: 65-2