

C/2751.71F

Street:

HARRISON STREET

OFFICIAL USE ONLY

X-Street: TR BNDY N. OF DIANA

TRANSIT & SWING TIES

HARRISON

TR BNDY

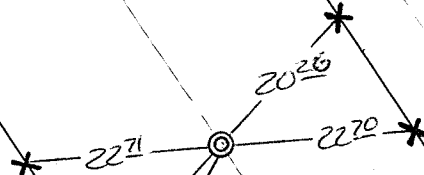

FD. 1" I.P. NO TAG FLUSH RESET W/P.K. NAIL & CITY SUR. TAG FLUSH

244.47' ± TO DIANA STREET

- ✕ FD. Ramset Nail on T/C
- FD. LD. & TK. on T/C
- FD. "C" Nail on T/C
- Set LD. & TK. on T/C

P.K. and City Engineer tag to be set @ surface after street construction is complete. (If possible)

Scale: 1" = 20'
 Date: 03/09/11
 Drawn by: pw
 F.B.:
 TR-Sec: T3SR5W-18

OFFICIAL TIE PLAT

CITY OF RIVERSIDE



These ties are for the purpose of perpetuating the found monumentation. No claim is made as to the relationship of the points or lines shown hereon to true boundary locations.

Sheet 1 of 1
 Cadme MB: 80-2