

C14198.TIF

R-1 = CITY OF RIVERSIDE OFFICIAL TIE PLAT CRFB 841/63 DATED 10-31-67  
 R-2 = CALTRANS RIGHT OF WAY MAP 67308-01  
 R-3 = CALTRANS RIGHT OF WAY MAP 63303-02  
 ( ) = RECORD DISTANCE PER R-1

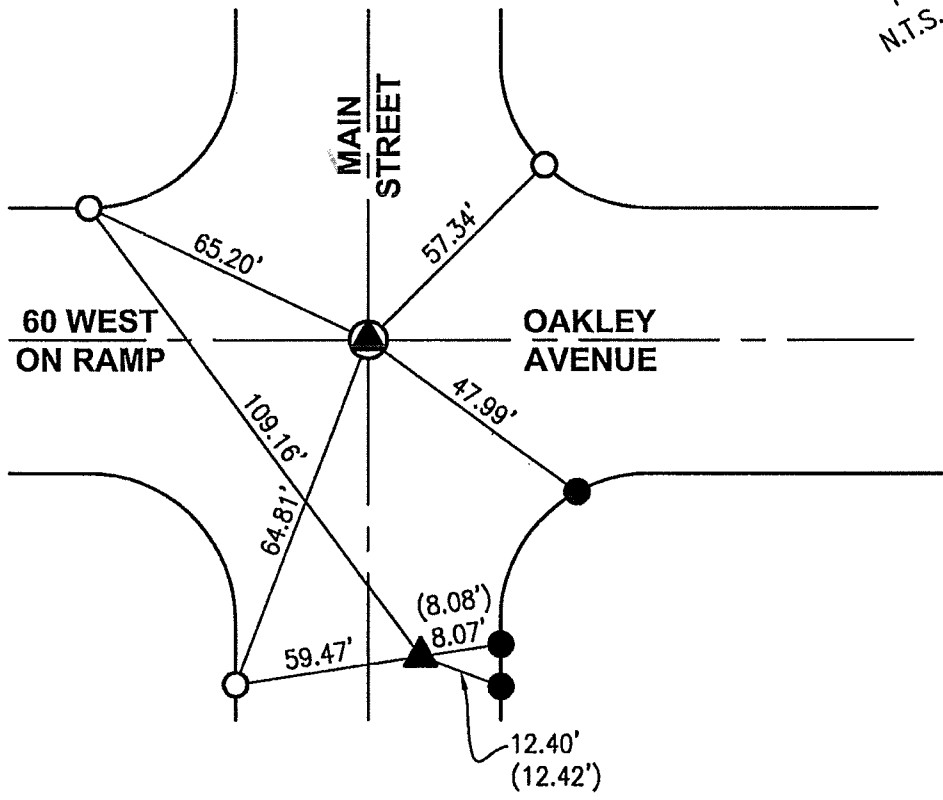

- ▲ FD. WELL MONUMENT WITH 2" BRASS DISK "DIVISION OF HIGHWAYS  $\oslash$  OAKLEY AVE 619+64.60 P.O.T.  $\oslash$  MAIN ST. 17+00.00 P.O.C." DOWN 1.0' PER R-3 BEFORE AND AFTER CONSTRUCTION.
- ▲ FD. WELL MONUMENT WITH 2.5" BRASS DISK "DIVISION OF HIGHWAYS  $\oslash$  MAIN-OAKLEY P.I." DOWN 1.2' PER R-1 & R2 BEFORE AND AFTER CONSTRUCTION.
- FD. L/T IN T.C. PER R-1.
- SET L/T "LS 5411" IN T.C.

THE PURPOSE OF THIS RECORD IS TO DOCUMENT THE PERPETUATION OF FOUND MONUMENT(S) PURSUANT TO THE PLS ACT SECTION 8771. NO CLAIM IS MADE REGARDING THE CORRECTNESS OF THE POSITION(S) OF SAID MONUMENT(S), NOR THE DIMENSIONAL RELATIONSHIP TO STREET CENTERLINES OR PROPERTY BOUNDARIES.

12-ALL-160