

"LA BONITA" TRACT

RIVERSIDE CO., CALIFORNIA.

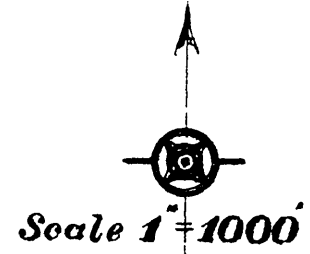

Being a Subdivision of Lots 2 & 3 and Part of Lots 1, 6, 7, 8 & 9 Section 11 Lots 1, 2, 3, 10, 11, 12, 13, 14, 22 & 23 and Part of Lots 15, 16, & 21, Section 14, and Lots 6, 7, 8, 9, 10 & 11 and Part of Lot 13 Section 13 T. 2 S. R. 6 W. S. B. B. & M., of the "Subdivision of a Portion of the Jurupa Ranch" as Recorded in Book 9, Page 26 of Maps Records of San Bernardino Co., California.

Surveyed by **F. C. FINKLE**
Civil Engineer
Scale (of Original)
660 Ft = 1 in.

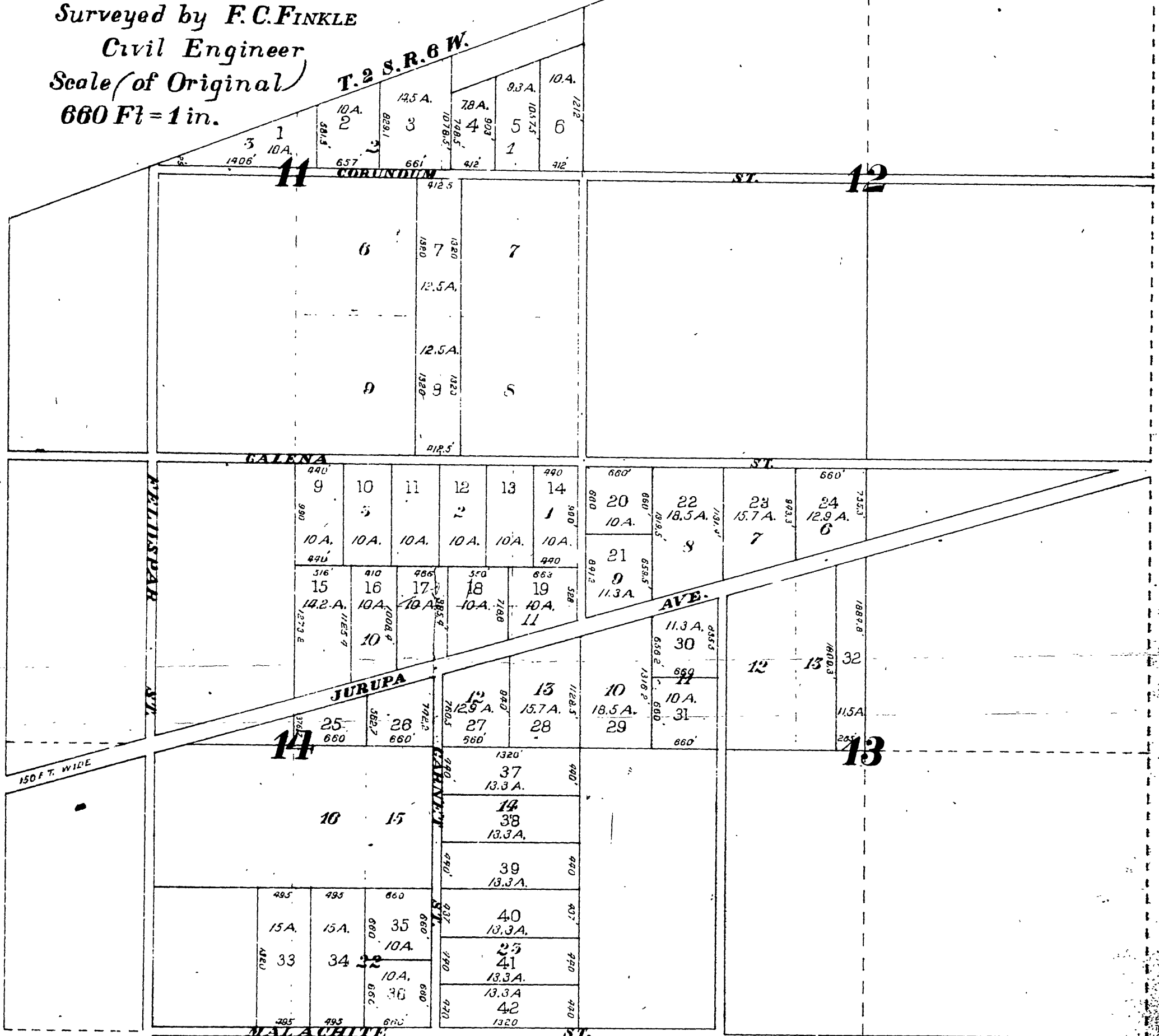

I W. S. Boggs Trustee do hereby execute and adopt the foregoing map of "La Bonita" Tract, being a subdivision of Lots 2 & 3 and a part of Lots 1, 6, 7, 8 & 9, Section 11, Lots 1, 2, 3, 10, 11, 12, 13, 14, 22, & 23 and part of Lots 15, 16, & 21, Section 14 and Lots 6, 7, 8, 9, 10 & 11 and part of Lot 13, Section 13, T. 2 S. R. 6 W. S. B. B. & M. of the "Subdivision of a portion of the Jurupa Ranch", as recorded in book 9 page 26 of maps, records of San Bernardino County California, as a full, true and correct map of Lands so far as the same are covered by said map. Witness my hand this 17 day of April 1894.

State of California
County of San Bernardino } ss
W. S. Boggs Trustee

Be it remembered that on this 17th day of April 1894 before me the undersigned a Notary Public in and for the County and State aforesaid came W. S. Boggs who is personally known to me to be the same person who executed the above instrument of writing and he duly acknowledged the execution of the same as Trustee.

In witness whereof I have hereunto set my hand and affixed my notarial seal the day and year above written.
S. F. Zombro NOTARY PUBLIC in and for San Bernardino County California

NO. 7.

Received for Record April 19, 1894, at 10 min. past 9 o'clock A.M. at request of C. W. Mettler. Recorded in Book No. 1 of Maps page 12, Records of Riverside County California Fees \$11.50 Pd.

E. H. GRUWELL Recorder
by C. O. Alkire Deputy Recorder

I hereby certify that the above is a full true and correct copy of the original.

E. H. GRUWELL RECORDER.

By **G. M. PEARSON** COUNTY SURVEYOR AND EX-OFFICIO DEPUTY RECORDER.

