

1/4 Sec. Cor. 1231.5 FT CENTER AVE

PALM AVE

ELIZA ST.

ST.

Sec. 33

Sec. 34

2 S.

5 W.

W. PLAT. OF E.

BLOCK 7 TIBBETS TRACT

SEC. 34-T 2 S R 5 W- S.B.M.

1" = 100'

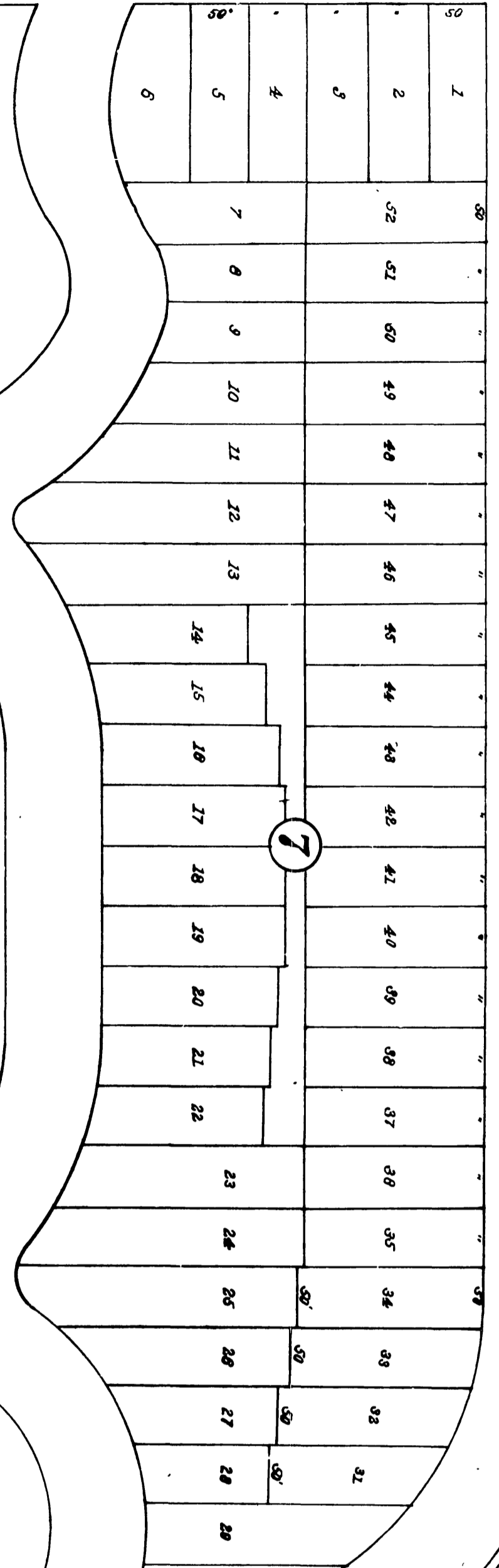

I hereby acknowledge the annexed plat to be a correct representation of a subdivision of a portion of Section 34 in Township Two South Range Five West 5 S. M.

State of California

County of Riverside 55.

On this 19th day of February in the year of our Lord 1900 before me, Philip M. ... of Notary Public in and for said County and State residing therein duly commissioned and sworn personally appeared Walter Tibbets known to me to be the person described in, whose name is subscribed to and who accepts the foregoing and he acknowledged to me that he executed the same.

In witness whereof I have hereunto subscribed my name and official seal the day and year first above written.

Philip M. ... Notary Public in and for the County of Riverside State of California

96

Filed at Request of W. S. Curtis ...

904