

36A

36
19

1	2	3	4	5	6	7	8	9	10	11	12
13	14	15	16	17	18	19	20	21	22	23	24

1	2	3	4	5	6	7	8	9	10	11	12
13	14	15	16	17	18	19	20	21	22	23	24

1	2	3	4	5	6	7	8	9	10	11	12
13	14	15	16	17	18	19	20	21	22	23	24

1	2	3	4	5	6	7	8	9	10	11	12
13	14	15	16	17	18	19	20	21	22	23	24

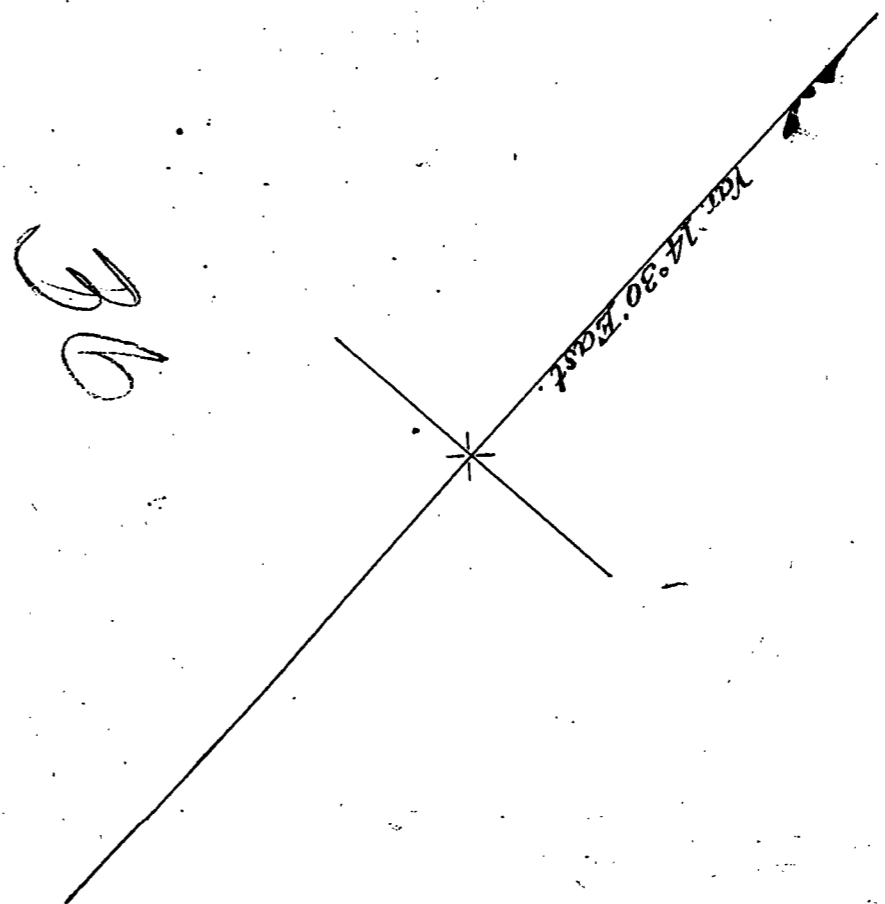

MAP
OF THE
CASA BLANCA
ADDITION

City of Riverside

BEING A SUBDIVISION OF BLOCK 66
OF THE LANDS OF

W. J. SAYWARD & S. C. EVANS

Surveyed by S. Weston

JAN 1886

SAN BERNARDINO CO., CAL.

Filed for Record, Oct. 14, 1886

County Recorder,

*Filed at request of Mr. S. Weston,
Oct 14th 1886 at 3:55 P.M.*

*Seamus Allen,
Co. Recorder,
By J. G. Adams, Jr.,
Deputy.*

