

These are a copy of the map showing the location and boundaries of the lots in Block B of the Riverside Cemetery, San Bernardino County, California, as surveyed by Goldsworthy & Hyatt, for the San Bernardino Cemetery Association, a map of which is on file in the County Recorder's Office of San Bernardino and State



of the CEMETERY

at

RIVERSIDE

Block A.

49 LOTS 18 FT. SQUARE.

ALLEYS ALL 4 1/2 FT. WIDE, EXCEPT THE TWO OUTSIDE, WHICH ARE 4 FT. WIDE.

Block B.

49 LOTS 18 FT. SQUARE.

ALLEYS ALL 4 1/2 FT. WIDE, EXCEPT THE TWO OUTSIDE, WHICH ARE 4 FT. WIDE.

Scale 20ft.=1in.

13th.

St.

Office of the County Recorder of San Bernardino County, California, as by Law require him by resolution of the Board of Trustees of said Association

San Bernardino Cemetery Association
By W. W. Brown President
Geo. M. Brown Treasurer

88

St.

St.

PINE

CEDAR

88

3

MB

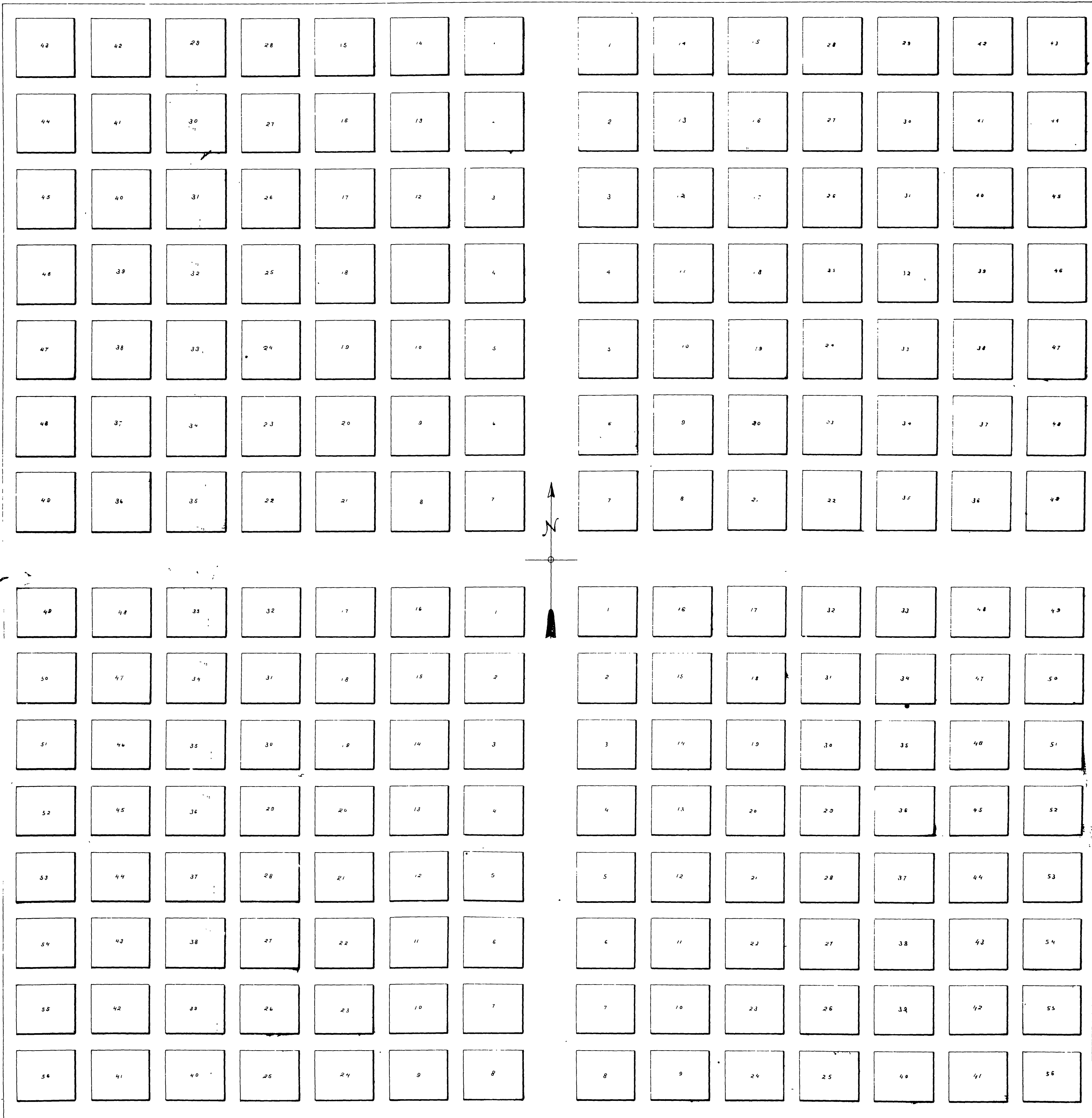

Block D.

58 LOTS 15 FT. x 18 FT.

ALLEYS ALL 4 1/2 FT. WIDE EXCEPT THE ONE ON SOUTH SIDE, WHICH IS 6 FT. WIDE, AND THE ONE ON WEST SIDE WHICH IS 4 FT. WIDE

THE DRIVES ARE 10 FT. WIDE

St.

Block C.

58 LOTS 15 FT. x 18 FT.

ALLEYS ALL 4 1/2 FT. WIDE EXCEPT THE ONE ON WEST SIDE, WHICH IS 5 1/2 FT. WIDE, AND THE ONE ON EAST SIDE WHICH IS 4 FT. WIDE