

**MAP OF**  
 — DIVISION "A" —  
**WASHINGTON SQUARE**  
 — being the —  
**CHASE NURSERY CO.**  
 — SUBDIVISION OF —  
**BLOCK 71 SAYWARD & EVANS TRACT.**  
 — surveyed by Kingsbury Sanson C.E. —  
 — JUNE 1902. —  
 — SCALE: 200 feet = 1 INCH. —

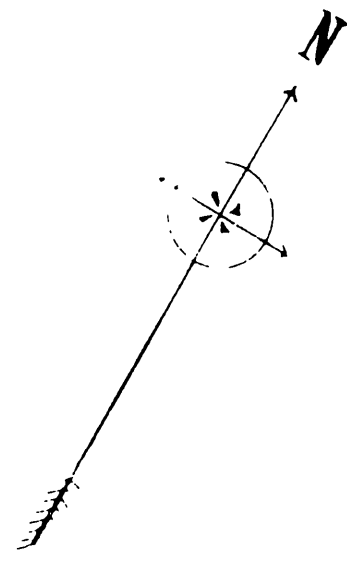

5.

Filed at Request of  
H. V. Chase  
 This 30 day of July 1907  
 at 10 Min past 10 o'clock A.M.  
H. P. [unclear] County Recorder  
 By [unclear] Deputy Recorder

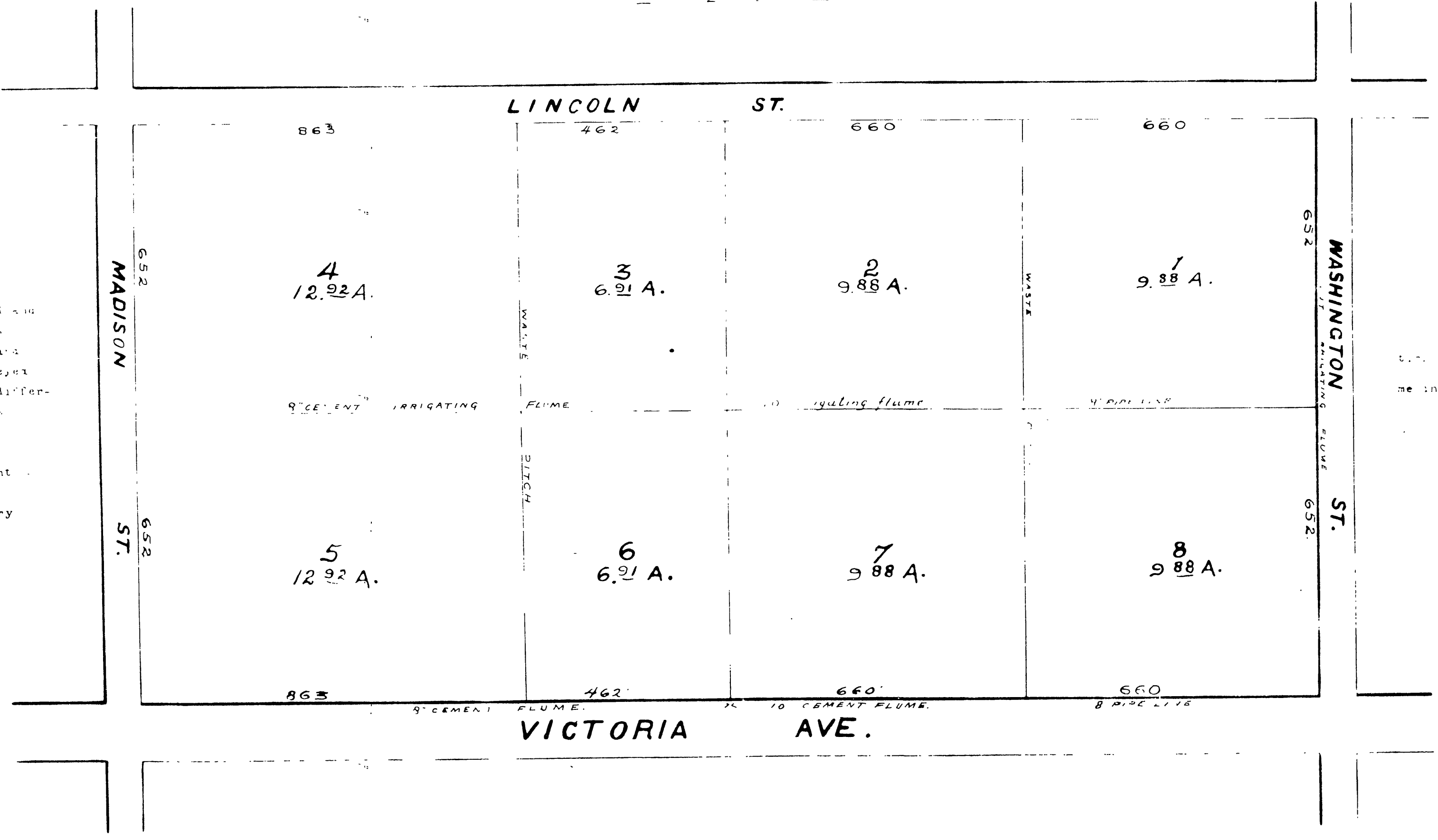

THE CHASE NURSERY COMPANY a corporation organized and existing under the laws of the State of California, by its President and Secretary, duly authorized, hereby execute and adopt this Map of Division "A" WASHINGTON SQUARE, as surveyed by Kingsbury Sanson C. E. in June 1902 to designate the different parts of said tract to represent as divided into lots by the CHASE NURSERY COMPANY

By H. V. Chase President  
W. B. Chase Secretary

I hereby certify that this Map is a correct representation of the survey of Division "A" WASHINGTON SQUARE, as made by me in June 1902.

Kingsbury Sanson

State of California ) ss  
 COUNTY OF RIVERSIDE )

On this 30 day of July 1907 in the year of our Lord one thousand nine hundred and seven and of the Independence of the United States for said County and State, residing therein duly constituted and sworn, personally appeared H. V. CHASE and W. B. CHASE, personally known to me to be the President and Secretary of the Corporation described in, and who executed the aforesaid and annexed instrument, and acknowledged to me that said Corporation created the same.

In witness whereof, I have hereunto set my hand and affixed my official seal, the day and year first above written.

[Signature]  
 County Public Assessor and for Riverside County, State of California.

— EXPLANATORY. —

All acreage is net. 2"x 2" reewood posts are placed at all corners.