

MAP OF
RESUBDIVISION
 of
BLOCK 3, RANGE 3
 of the City of Riverside,
 California.

Surveyed by
Kingsbury Sanborn, C.E.
 April, 1903.
 Scale 1 inch = 50 feet.

I hereby execute and adopt this Map of BLOCK 3, RANGE 3,
 as re-subdivided by KINGSBURY SANBORN C.E. in April, 1903 to
 designate the different parts of land which it represents as divid-
 ed into lots and streets.

L. V. W. Brown

State of California }
 COUNTY OF RIVERSIDE } s.s.
 On this 30th day of April, in the year of our Lord One Thousand Nine Hundred
 and three, before me Wm A. CORRELL a Notary Public in and for said County
 of Riverside, residing therein, duly commissioned and sworn, personally appeared
 L.V.W. BROWN, personally known to me to be the person described in, and
 whose name is subscribed to, and who executed the within instrument, and
 acknowledged to me that he executed the same freely and voluntarily.
 IN WITNESS WHEREOF, I have hereunto set my hand and official seal, at
 my office in Riverside, in the said County, the day and year in this Certificate
 first above written.

Wm A. Correll
 Notary Public in and for Riverside County State of California.

I hereby certify that this Map of BLOCK 3, RANGE 3, is a correct
 representation of the re-subdivision made by me in April, 1903.

Kingsbury Sanborn

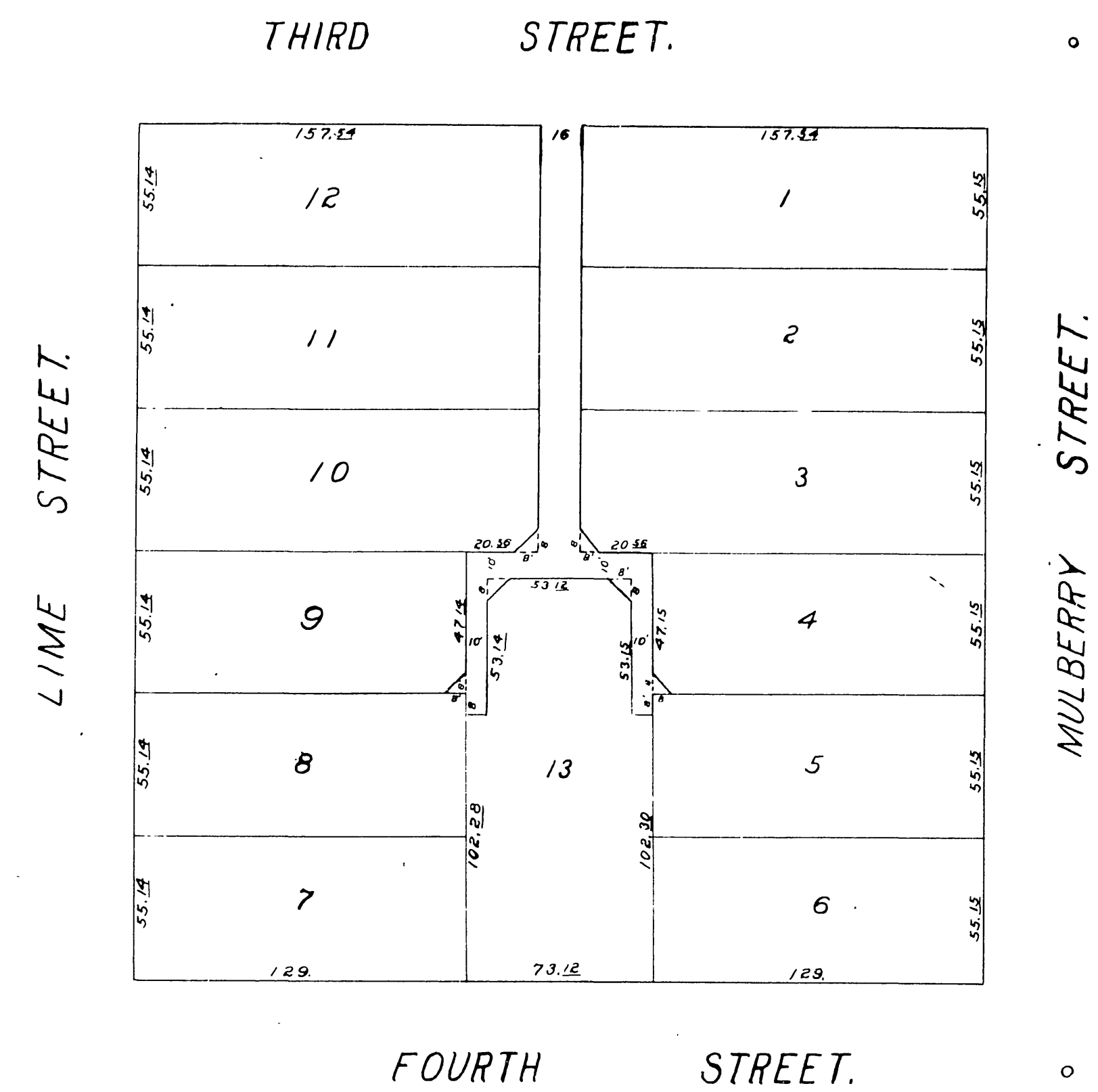
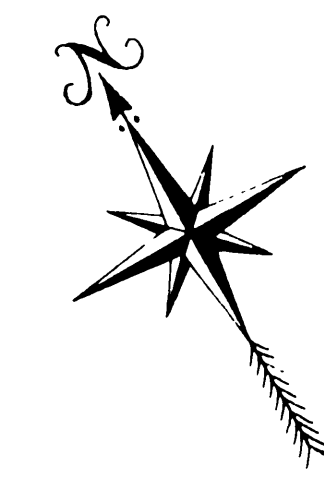

EXPLANATORY.
 2" x 2" redwood stakes are set at all corners and Cement Points
 placed at points delineated on the map by small circles.

MB 4/89

M.B. 4/89

RIVERSIDE CITY LIMITS
 BOOK 1