

S.B. CO. M.B. 5/50

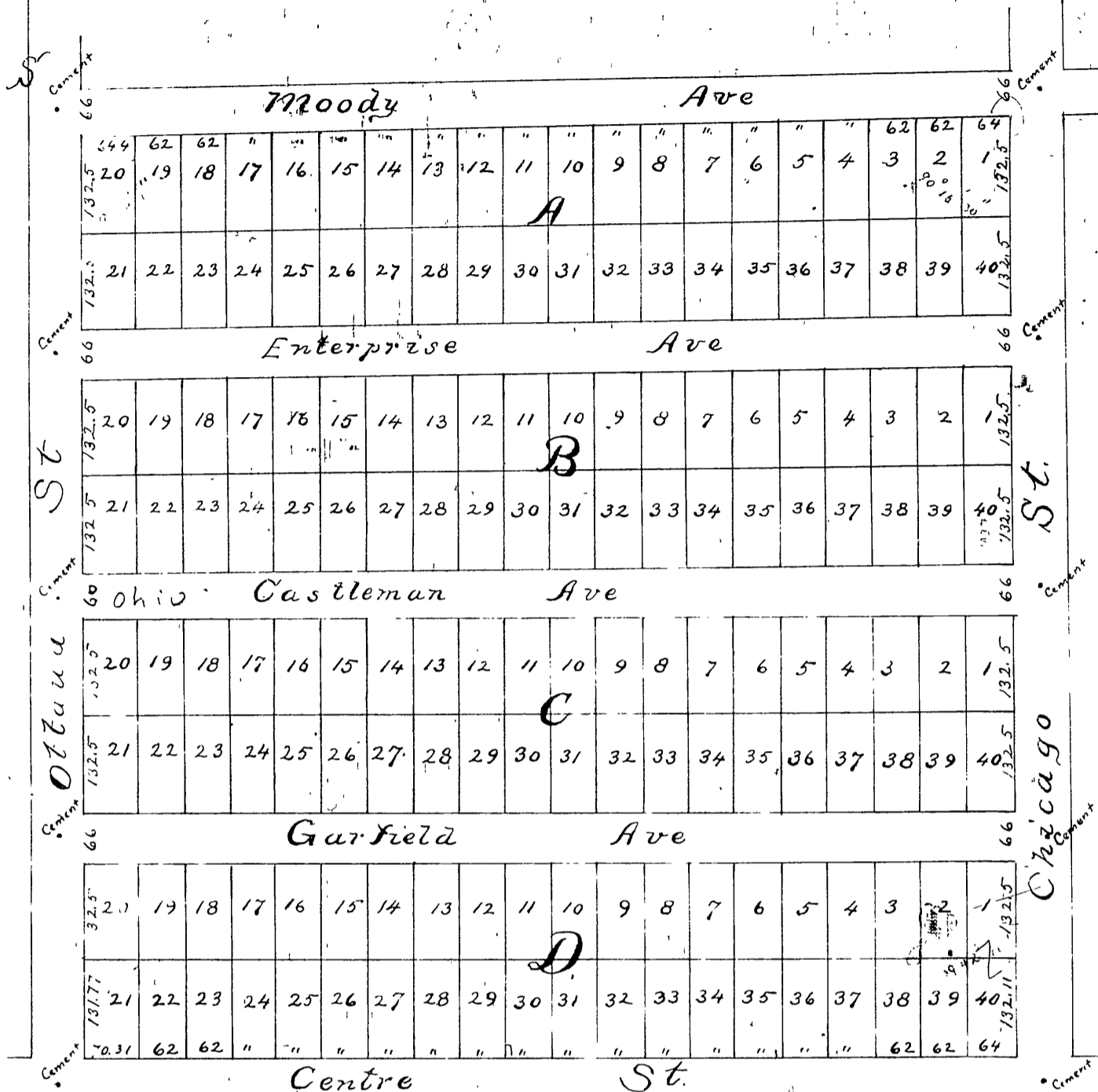

MAP OF GRAND VIEW PLACE Riverside San Bernardino California, Scale 200ft = 1inch August 1887

James W. Johnson C. E.

Being a subdivision of blocks 9, 10, 23 & 24
of Castleman addition to City of Riverside
Recorded at request of J. A. Studenbaker
Nov 1st 1887 at 9.10

Legare Allen
County Recorder

By W. P. Beave
Rep

November 1, 1887

J. A. Studenbaker

San Bernardino

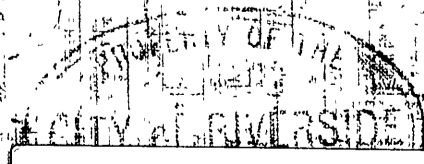

S.B. CO. M.B. 5/50

GRAND VIEW PLACE