

MAP OF THE DENNIS BLOCK

BEING A SUBDIVISION OF
BLOCK 4 RANGE 8
LYING IN THE CITY OF RIVERSIDE.
RIVERSIDE COUNTY CALIFORNIA
SURVEYED BY
ARTHUR B. WHITE C.E.
APRIL 1905.

SCALE 30 FT. = 1 INCH.

Know all men by these presents that I hereby execute and adopt this Map of The Dennis Block in the City of Riverside, California, subdivided as shown.

Ethel M. Dennis

State of California } ss
County of Riverside }

On this 11 day of May 1905 before me [REDACTED] a Notary Public in and for said County of Riverside, residing therein duly commissioned and sworn personally appeared [REDACTED] known to me to be the person whose name is subscribed to and who executed the within instrument, and acknowledged to me that she executed the same freely and voluntarily. In witness whereof I hereunto set my hand & Official Seal the day and year first above written.

[REDACTED]
Notary Public in and for Riverside County.

I hereby certify that this Map of the Dennis Block is a true and correct representation of the Survey made by me during April 1905.

[REDACTED]
Licensed Surveyor.

Resolved that the within Map be and hereby is adopted as the Official Map of the Dennis Block.

I hereby certify that the foregoing resolution was adopted by the Board of Trustees of the City of Riverside.

Attest [REDACTED] City Clerk

Book 1
RIVERSIDE CITY LIMITS

Note:— 2x2" Pine Stakes set at
1st corners 15" long.

o Cement Pt.

o Cement Pt.

ALMOND STREET

66'

66'

FIFTH STREET

66'

FOURTH STREET

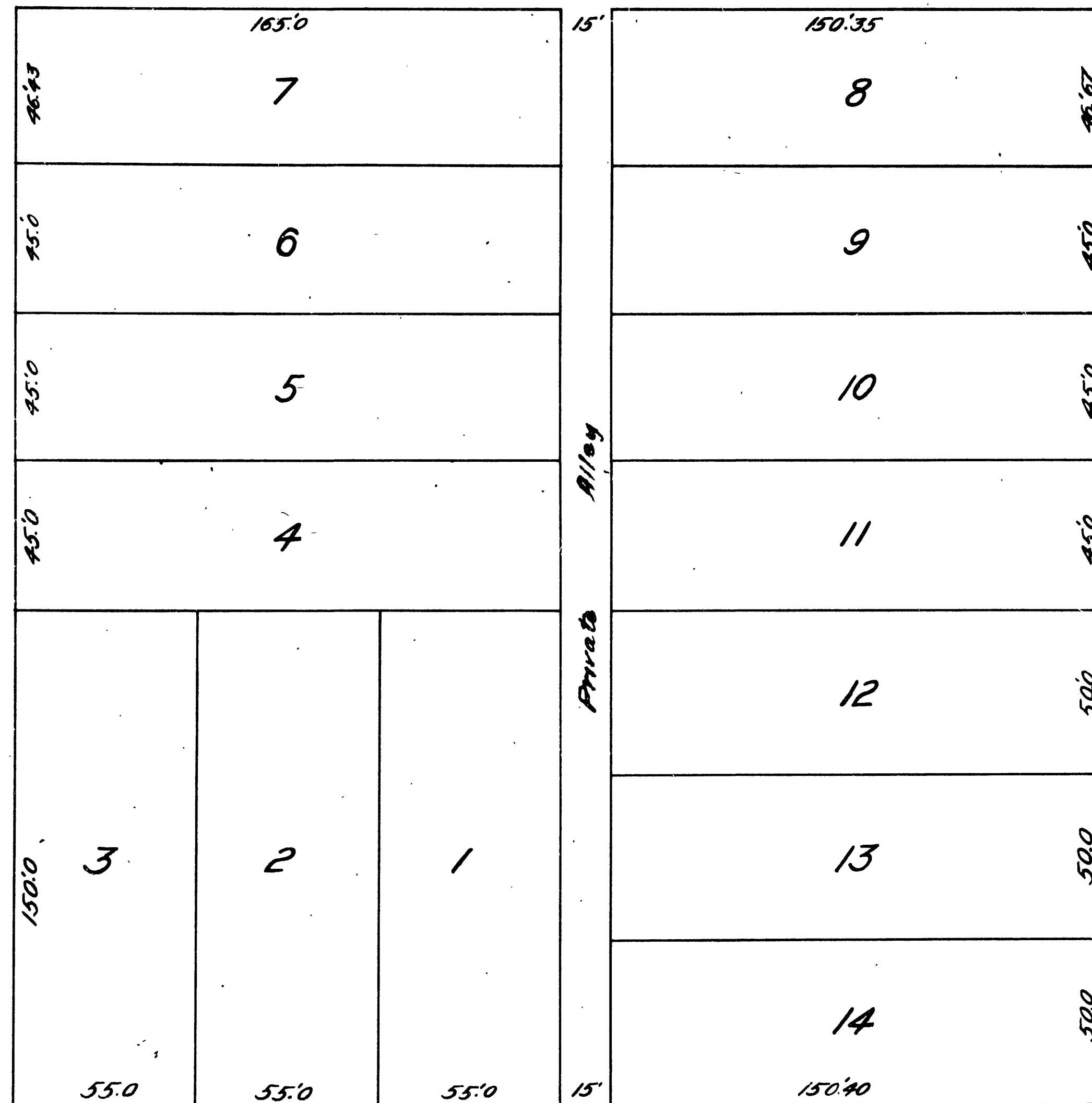

MARKET STREET

66'

MB
5
128

MB5/128

M.B. 5/128