

# Map of HARRIS & HENLEYS ORANGE VISTA TRACT

**FILED**  
MAR 1906  
I. S. LOGAN, Recorder,  
By \_\_\_\_\_ Deputy  
MB 5/143

Being a Subdivision of a portion of the South  $\frac{1}{2}$   
of the North-East  $\frac{1}{4}$  of the South-East  $\frac{1}{4}$  of Section 33.  
T. 2 S. R. 5 W. S. B. B. M.  
Surveyed by KINGSBURY SANBORN, C.E.  
MARCH 1906.  
Scale 1 Inch = 80 Feet.



We hereby execute and adopt this MAP of HARRIS & HENLEYS ORANGE VISTA TRACT as surveyed by KINGSBURY SANBORN, C.E. in MARCH, 1906 to designate the different parts of land which it represents as divided into lots, blocks and streets.

H. L. Harris  
Wm. P. Henley

STATE OF CALIFORNIA, } ss  
COUNTY OF LOS ANGELES, }

On this 16<sup>th</sup> day of MARCH in the year of our Lord One Thousand Nine Hundred and Six, before me Mary A. Connor a Notary Public in and for said County of Los Angeles, residing therein, duly commissioned and sworn, personally appeared H. L. HARRIS and Wm. P. HENLEY, personally known to me to be the persons described in and whose names are subscribed to and who executed the within instrument and acknowledged to me that they executed the same freely and voluntarily.

In WITNESS WHEREOF I have hereunto set my hand and official seal at my office in Los Angeles in the said County the day and year in this Certificate first above written.

Mary A. Connor  
Notary Public in and for Los Angeles County, State of California.

I hereby certify that this MAP of HARRIS & HENLEYS ORANGE VISTA TRACT is a correct representation of the survey made by me in MARCH, 1906.

Kingsbury Sanborn  
Licensed Surveyor.

RESOLVED:— That the within MAP be and is hereby adopted as the Official MAP of HARRIS & HENLEYS ORANGE VISTA TRACT.

I hereby certify that the foregoing Resolution was adopted by the BOARD of TRUSTEES of the CITY of RIVERSIDE this 13th day of MARCH, 1906.

Attest C. R. Stillbans  
City Clerk.

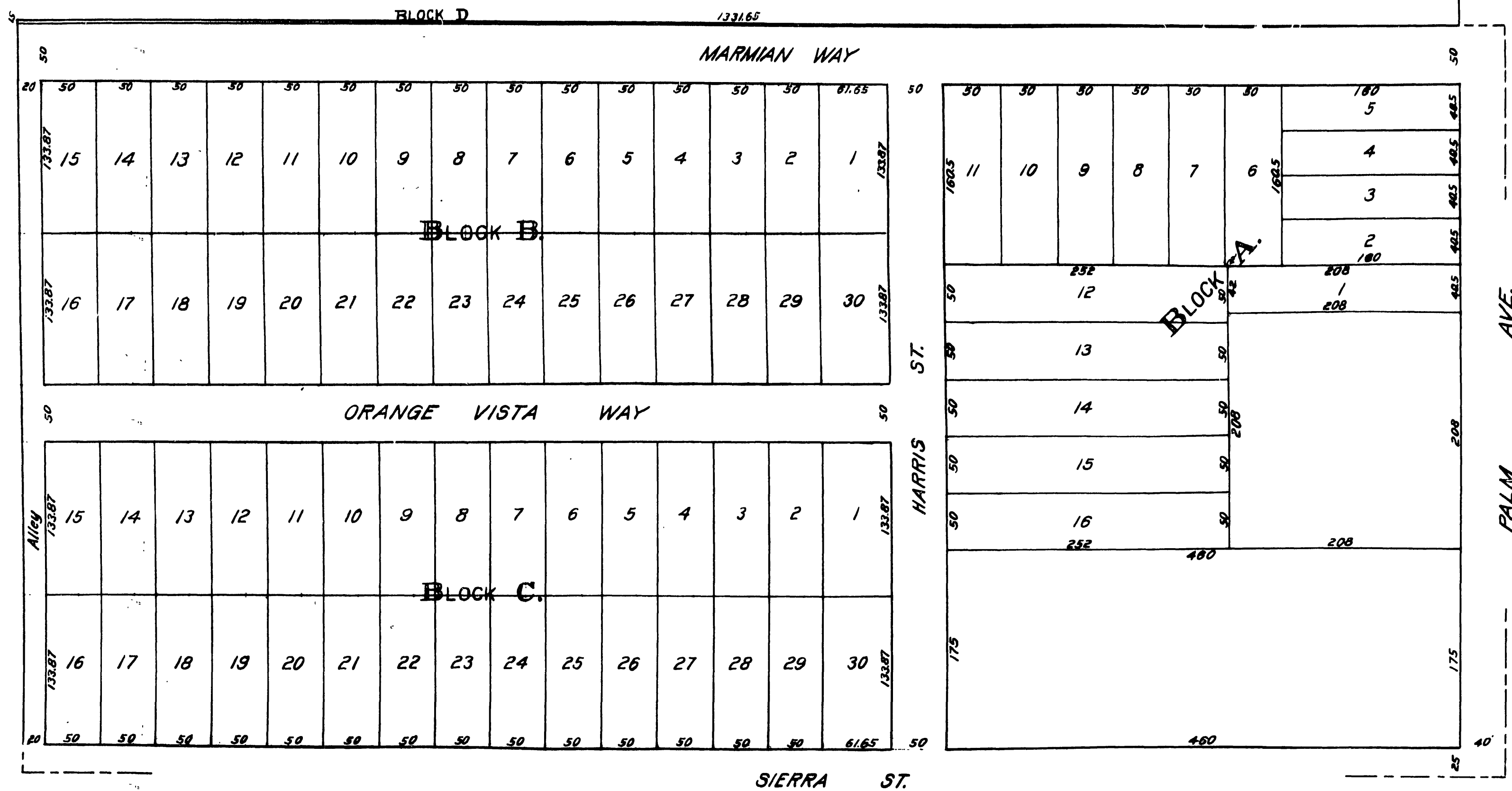

MB 5/143