

Know all men by these presents that I hereby execute and adopt this Map of the Fales Block in the City of Riverside, California subdivided as shown and dedicate all things to the use of the public to be treated as a Family of Fales

State of California County of Riverside On this 26<sup>th</sup> day of May 1906 before me E. E. Richard a Notary Public in and for said County of Riverside residing therein, duly commissioned W. H. Hill sworn personally to me to be the person whose name subscribed to and who executed the within instrument and acknowledged to me that she executed the same freely and voluntarily In witness whereof I hereunto set my hand and official Seal the day and year first above written

E. E. Richard  
Notary Public in and for Riverside County

I hereby certify that this Map of the Fales Block is a true and correct representation of the survey made by me during February 1906.

Arthur B. White  
Licensed Surveyor

Resolved that the within Map be and hereby is adopted as the Official Map of the Fales Block. I hereby certify that the foregoing resolution was adopted by the Board of Trustees of the City of Riverside.

Attest C. R. Stibbens  
City Clerk

F N STREET

13<sup>TH</sup> STREET

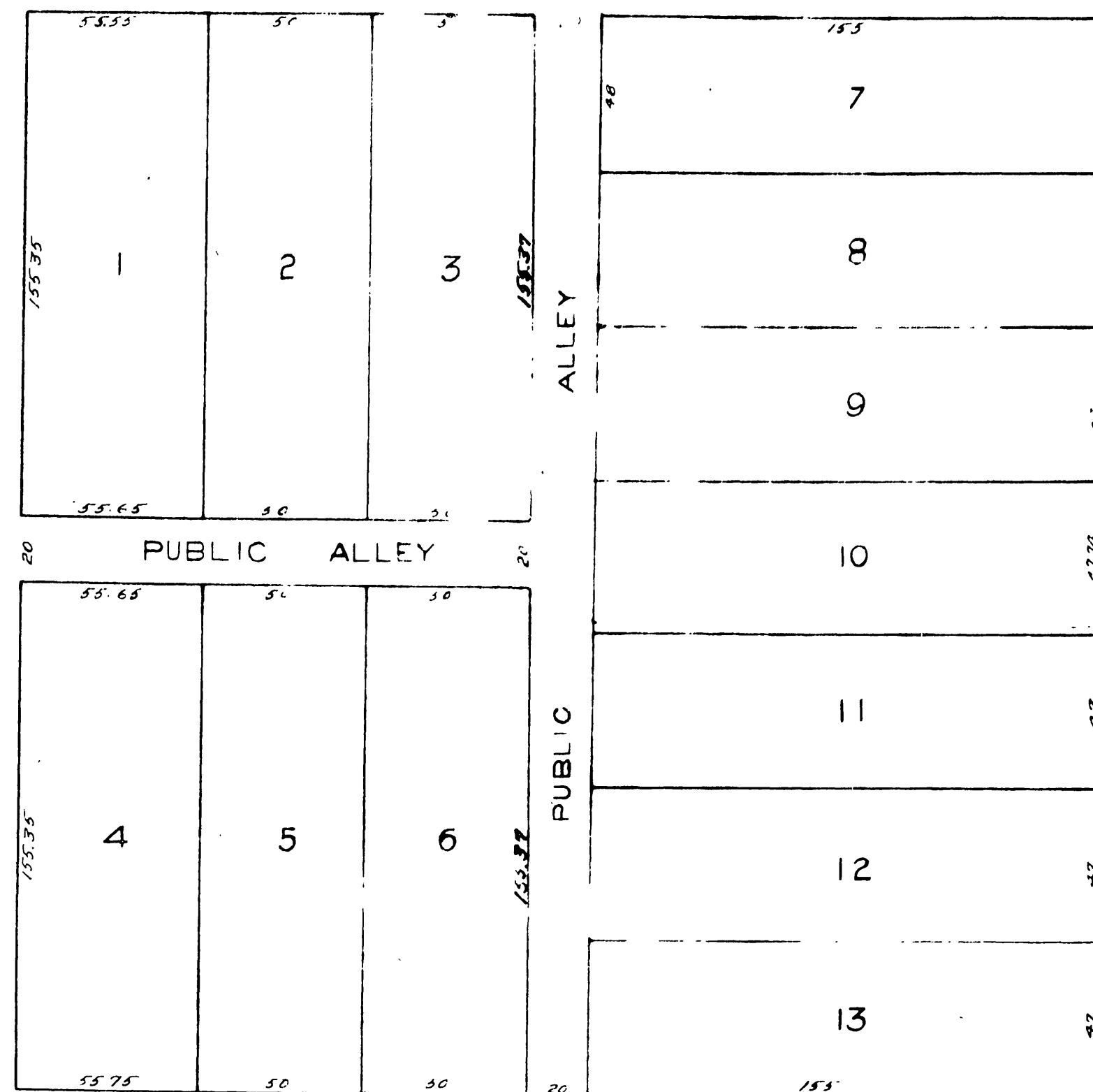

CEDAR STREET

21

**FILED**  
JUN 26 1906  
I. S. LOGAN, Recorder,  
Deputy

# MAP OF THE FALES BLOCK

BEING A SUBDIVISION OF BLOCK 12 RANGE 13 LYING IN THE CITY OF RIVERSIDE RIVERSIDE COUNTY, CALIFORNIA. SURVEYED BY ARTHUR B. WHITE C. E. FEB. 1906.

SCALE 40 FT = 1 INCH