

RE-SUBDIVISION OF
BLOCK 2
 BONNIE BRAE TRACT
 BLOCK 2 RANGE 9
 CITY OF RIVERSIDE, CALIFORNIA.

Surveyed by *KINGSBURY SANBORN, C.E.*

November, 1906

Scale 1 Inch = 40 Feet.

I hereby certify that this Map of Block 2 BONNIE BRAE TRACT is a correct representation of the survey made by me in November, 1906.

Kingsbury Sanborn
 Licensed Surveyor.

The RIVERSIDE TITLE AND TRUST COMPANY, a Corporation organized and existing under the laws of the State of California by its Vice President and Secretary duly authorized, hereby execute and adopt this Map of BLOCK 2 BONNIE BRAE TRACT as surveyed by *KINGSBURY SANBORN, C.E.* in November, 1906 to designate the different parts of land which it represents as divided into lots and alley.

THE RIVERSIDE TITLE AND TRUST COMPANY.
 By *Theo. D. Hewitt*, Vice President
 By *L. B. Scranton*, Secretary.

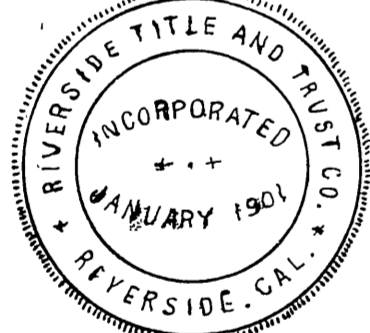

STATE OF CALIFORNIA, } ss.
 COUNTY OF RIVERSIDE

On this 8th day of November in the year one thousand nine hundred and six before me, *D. W. Lewis* a Notary Public in and for said County and State, personally appeared *Theo. D. HEWITT* known to me to be the Vice President, and *L. B. SCRANTON* known to me to be the Secretary of the corporation that executed the within instrument and known to me to be the persons who executed the within instrument on behalf of the corporation therein named and acknowledged to me that such corporation executed the same.

D. W. Lewis
 Notary Public in and for the County of Riverside, State of California.

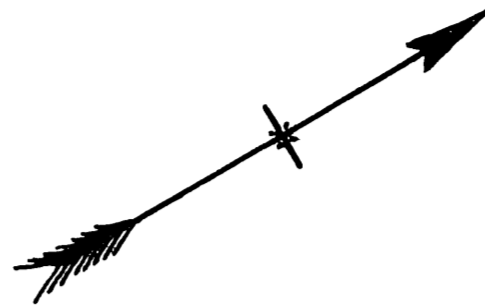
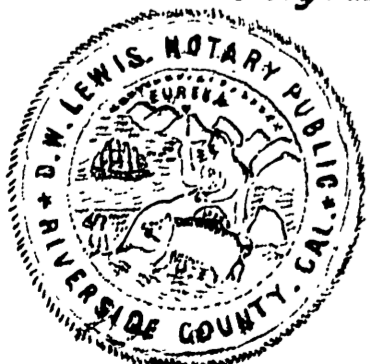

FILED
 NOV 7 1906
 NOV 3 1906
 I. S. LOGAN, Recorder,
 Deputy

See map

CHESTNUT STREET.

THIRD STREET.

SECOND STREET.

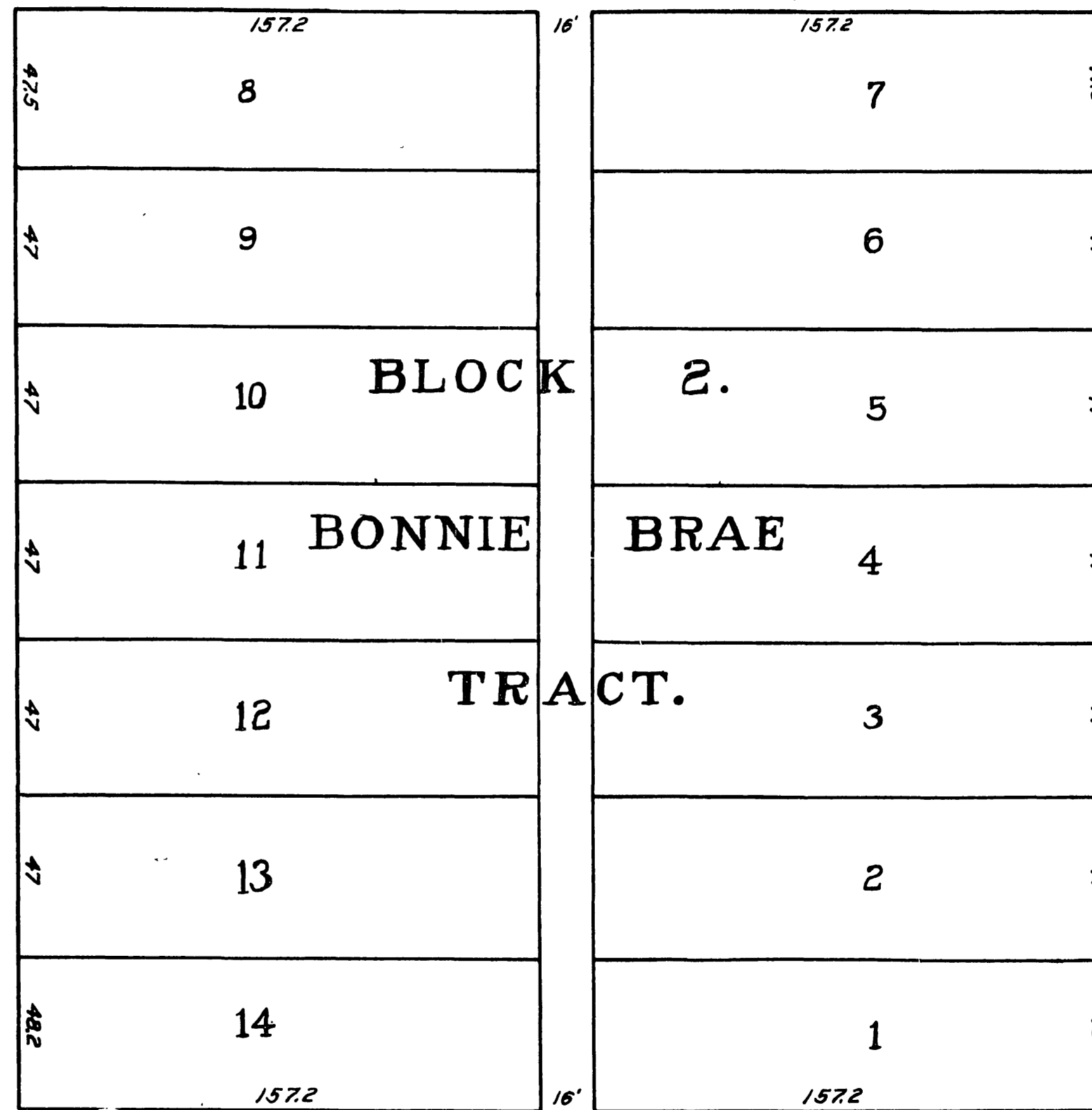

Note: - 2"x2" Redwood stakes are set at all corners except Block corners where 4"x4" redwood stakes are set, and cement points used are shown by small circles thus, o c.p.

ALMOND STREET.

RESOLVED That the within MAP be and is hereby adopted as the Official MAP OF BLOCK 2 BONNIE BRAE TRACT.
 I hereby certify that the foregoing RESOLUTION was adopted by the BOARD OF TRUSTEES OF THE CITY OF RIVERSIDE this 8th day of November, 1906.
C. N. Stillman
 City Clerk.

1772

M.B. 5/172

M.B. 5/172

5/172

Book 1

MB 5/172

172