

MAP SHOWING MOXLEY'S RESUBDIVISION

OF A PORTION OF BLOCK 9 RANGE 12 RIVERSIDE.

MB 6/92

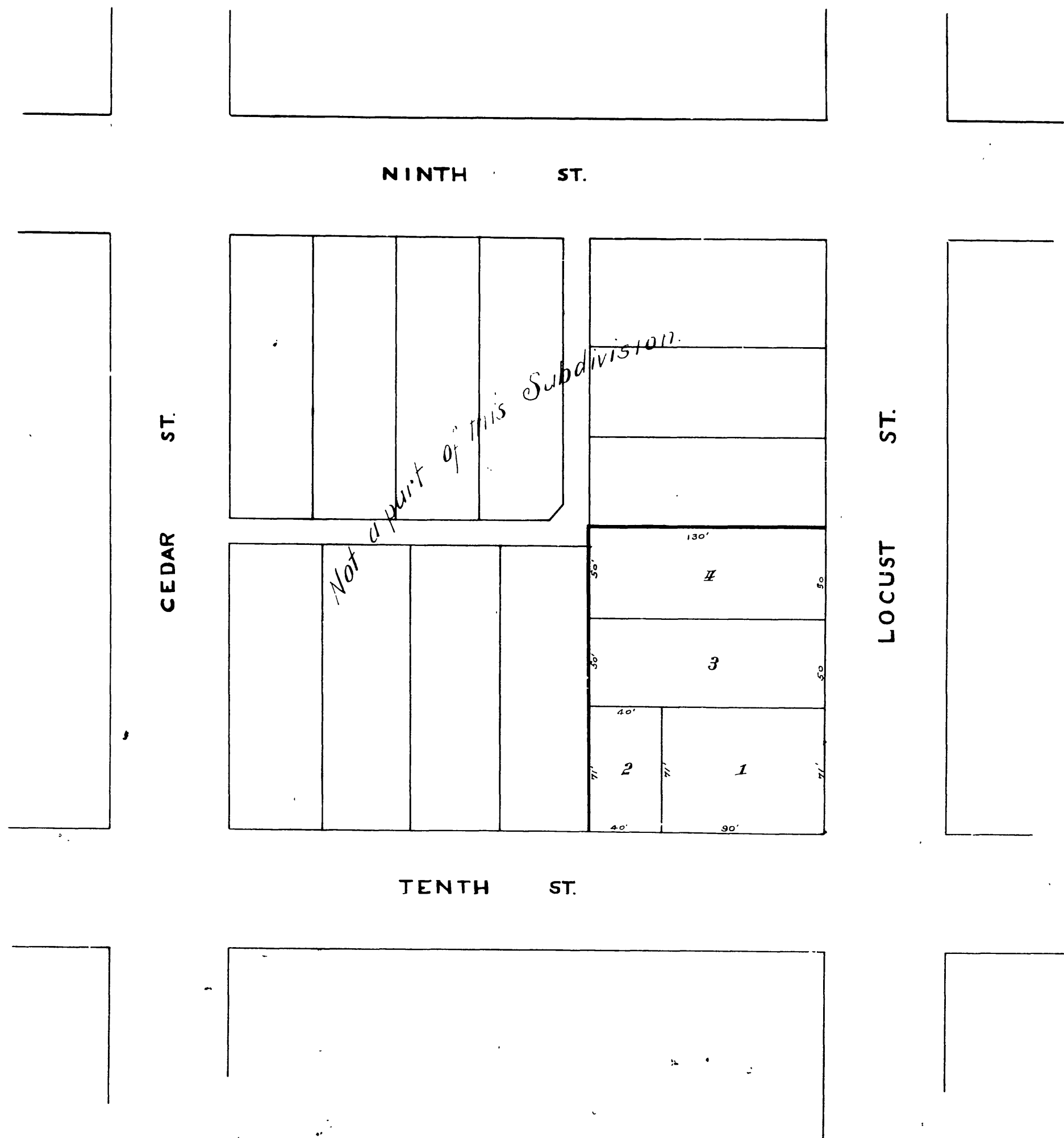
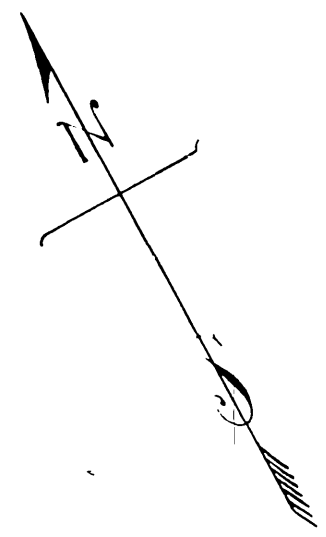

We hereby execute and adopt this Map of Moxley's Resubdivision of a portion of Block 9 Range 12 Riverside to designate the different parts of land which it represents, as divided into lots.

C. E. ...
Security Savings Bank of Riverside
Pres
Sec

State of California } ss.
County of Riverside }
On this 7th day of December in the year of our Lord One Thousand Nine Hundred and Nine before me L. B. Scranton, Notary Public in and for said County and State, residing therein duly commissioned and sworn, personally appeared O. E. Moxley personally known to me to be the person described in and whose name is subscribed to and who executed the within instrument and acknowledged to me that she executed the same freely and voluntarily.
In witness whereof, I have here unto set my hand and affixed my official seal at my office in Riverside in the said County the day and year in this certificate first above written.

L. B. Scranton
Notary Public, in and for the County of Riverside, State of California.

State of California } ss.
County of Riverside }
On this 7th day of December in the year of our Lord One thousand nine hundred and nine before me L. B. Scranton a Notary Public in and for said County and State personally appeared S. H. Herrick known to me to be the President and Wm. T. Dinsmore known to me to be the Secretary of the Corporation that executed the within instrument and known to me to be the persons who executed the within instrument on behalf of the corporation therein named and acknowledged to me that such corporation executed the same.

L. B. Scranton
Notary Public in and for the County of Riverside, State of California.

I hereby certify that there are no delinquent taxes against the property designated by this Map.
Dated Dec. 7, 1909
C. W. ...
County Auditor
C. W. ...
City Auditor

MB 6/92

76
MB 6/92