

# MAP OF LORETTA'S VICTORIA AVENUE TRACT

BEING A SUBDIVISION OF BLOCK 34 OF THE SANTA FE TRACT

RIVERSIDE, RIVERSIDE COUNTY CAL. NOVEMBER 1910 KINGSBURY SANBORN C.E.

Scale 1" = 50 FT

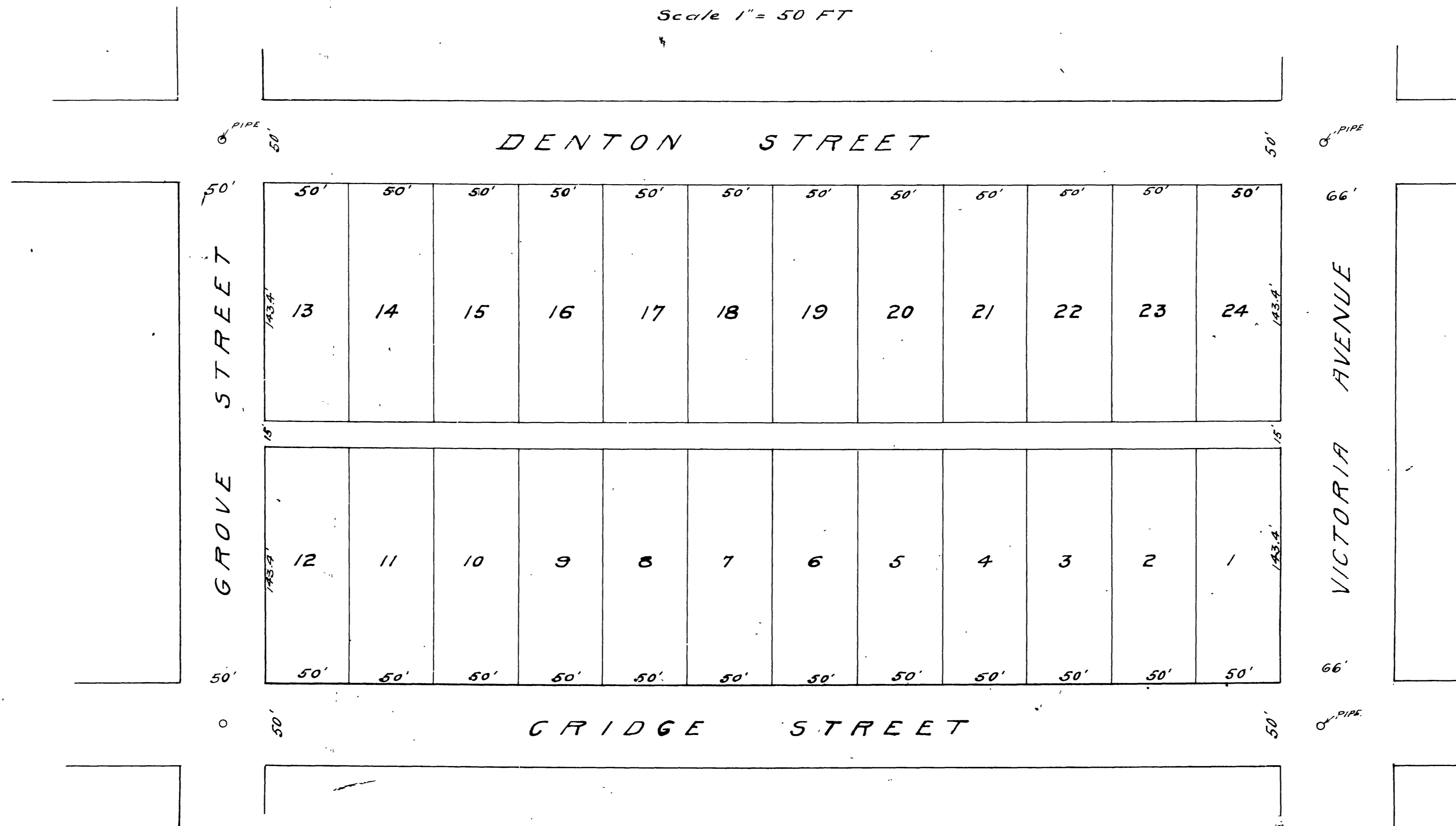

Filed Nov. 9, 1910.

in Riverside, Cal.

W. C. Brown, County Auditor

City Auditor

I hereby certify that this map is a correct representation of the survey made by me in November 1910

W. C. Brown  
Licensed Surveyor

I hereby certify that there are no delinquent taxes against the property designated on this map Nov. 4 1910

W. C. Brown  
County Auditor  
City Auditor

I hereby execute and adopt this map of the LORETTA'S VICTORIA AVENUE TRACT to designate the different parts of land which it represents as divided into lots and alley

signed in presence of  
W. C. Brown  
Nellie L. Kold

signed: F. J. Bahr

State of California, ss.  
County of Riverside

On this 4<sup>th</sup> day of November in the year of our Lord one thousand nine hundred and ten before me, Notary Public in and for the County of Riverside State of California, residing therein, duly commissioned and sworn, personally appeared F. J. Bahr personally known to me to be the person designated herein and who executed the within instrument, and acknowledged to me that he executed the same freely and voluntarily.

In witness whereof, I have hereunto set my hand and official seal, at my office in Riverside, in said County, the day and year in this certificate first above written

D. W. Lewis  
Notary Public in and for Riverside County  
State of California

Resolved: That the within map be and is hereby adopted as the official map of the LORETTA'S VICTORIA AVENUE TRACT, and that the streets and alley shown on said tract are hereby accepted as public streets and alley, and the City Clerk is hereby authorized and directed to attest said map by signing his name thereto as City Clerk of said City for and in behalf of the City and to affix the seal of the City thereto.

I hereby certify that the foregoing resolution was adopted by the Mayor and Common Council of the City of Riverside this 9<sup>th</sup> day of November 1910

Attest: W. C. Brown  
City Clerk