

NOTARY ACKNOWLEDGEMENT

STATE OF CALIFORNIA } s.s.
COUNTY OF RIVERSIDE }
On this 25 day of March 1958 before me, the undersigned, a Notary Public in and for said County and State, personally appeared Ray Schumburg known to me to be the Trust Officer and Alexine A. Schumburg known to me to be the ASST. Secretary of the Association that executed the within instrument and they acknowledged to me that they executed the same. WITNESS my hand and official seal.

Charles M. Miller
Notary Public in and for said County and State

My commission expires July 2 1958.

IN THE CITY OF RIVERSIDE

VILLA d'ESTE
UNIT NO 3

FILED

On April 15 1958
At 1:55 P.M.
Jack A. Ross
County Recorder
By O. D. Crumley
Deputy
Fee \$ 7.00
No. 27233
Filed by County Clerk
Subd. prec. by R.T. Co.

NOTARY ACKNOWLEDGEMENT

STATE OF CALIFORNIA } s.s.
COUNTY OF RIVERSIDE }
On this 25 day of March 1958, before me, the undersigned, a Notary Public in and for said County & State, personally appeared ARMAND E. BRUCE known to me to be the ASST. Secretary of the corporation that executed the within instrument and they acknowledged to me that they executed the same. WITNESS my hand and official seal.

Armand E. Bruce
Notary Public in and for said County & State

My commission expires 2-15-62.

BEING A SUBDIVISION OF A PORTION OF LOTS 6,7,8,10 AND 11, BLK. 8 R.L. AND I. CO LANDS AS RECORDED IN MAP BOOK I PAGE 70, RECORDS OF SAN BERNARDINO COUNTY, CALIFORNIA.

APRIL 1957

J. F. DAVIDSON, C. E.

SCALE 1" = 100

DIRECTOR OF PUBLIC WORKS CERTIFICATE

I hereby certify that I have examined the within map; that the subdivision shown hereon is substantially the same as it appeared on the tentative map and any approved alterations thereof; that all provisions of Chapter 128 (Subdivision Map Act) Statutes of California, 1943, and of Ordinance No. 1328 of the City of Riverside, California, and all amendments thereto have been complied with; that plans and specifications for drains, drainage, sewer and drainage works sufficient to protect all lots in said subdivision from flood or overflow have been approved by me; that all easements for sewers shown on said map are correct in form and contents and are approved; and I am satisfied that this map is technically correct. Dated this 9th day of April 1958

Director of Public Works

LIGHT AND WATER DEPARTMENT

I hereby certify that the subdivider named on this map has deposited with the Water Department of the City of Riverside sufficient funds to cover the cost of installing all necessary fire hydrants together with all water mains and laterals to the curb line on all streets shown on said map; that all P.U.E. shown on this map are sufficient for all requirements of the Electric Light and Water Departments of the City of Riverside and for the Department of Public Utilities of said City. Dated this 24th day of March 1958

Superintendent of Light and Water Dept., Riverside, Cal.

TAX BOND

I hereby certify that a bond in the sum of \$300.00 has been executed and filed with the Board of Supervisors of the County of Riverside, California, conditioned upon the payment of all taxes, State, County, City or local and all special assessments collected as taxes which at the time of filing of this map with the County Recorder, are a lien against said property, but not yet payable and said bond has been duly approved by said Board of Supervisors. Dated this 14th day of April 1958

County Clerk and ex-officio Clerk of the Board of Supervisors.
By Madeline Bauer Deputy

CITY CLERK'S CERTIFICATE

I, W. G. Waite, City Clerk of the City of Riverside, California, hereby certify that an undertaking satisfactory to the Council of said City guaranteeing the construction of required streets improvements in this subdivision was approved and filed in my office prior to the final acceptance of this subdivision map. WITNESS my hand and official seal of the City of Riverside, California, this 13th day of April 1958

City Clerk of the City of Riverside, California.

STREET SUPERINTENDENT'S CERTIFICATE

I hereby certify that according to the records of this office the property shown on this map is not subject to any special assessments which have not been paid in full. Dated this 25 day of May C.E. 1958

Street Superintendent

TAX COLLECTOR'S CERTIFICATE

I hereby certify that according to the records of this office as of this date, there are no liens against the property shown on this map for unpaid State, County, City or local taxes or special assessments collected as taxes, except taxes or special assessments now a lien but not yet payable, which are estimated to be \$300.00. Dated this 25 day of March 1958

V.M. Hyde County Tax Collector
By M. Strade Deputy

CITY PLANNING COMMISSION'S CERTIFICATE

I hereby certify that this map is approved by the Riverside City Planning Commission at its meeting held on the 21st day of November 1958

Planning Director, City of Riverside

CITY TREASURER'S CERTIFICATE

I hereby certify that according to the records of this office as of this date, the property shown on this map is not subject to any special assessments, bonds and/or liens which have not been paid in full. This certificate does not include any special assessments the bonds of which have not become a lien upon said property. Dated this 25th day of March 1958

City Treasurer

RESOLVED

That this map consisting of two (2) sheets, be and the same is hereby accepted as the official map of "VILLA d'ESTE No. 3" and the streets and easements offered hereon are accepted as public streets and easements and the City Clerk is hereby authorized and directed to affix said map by signing his name thereto as City Clerk of the City of Riverside, California, and to affix the official seal of the City thereto.

I hereby certify that the foregoing resolution was adopted by the Mayor and Council of the City of Riverside, California this 13th day of April 1958

City Clerk of the City of Riverside, California

NOTARY ACKNOWLEDGEMENT

STATE OF CALIFORNIA } s.s.
COUNTY OF RIVERSIDE }
On this 25 day of March 1958 before me, the undersigned, a Notary Public in and for said County and State, personally appeared W. G. MARTENS known to me to be the ASST. V.P. and H. P. HALL known to me to be the ASST. CAJON of the Association that executed the within instrument and they acknowledged to me that they executed the same. WITNESS my hand and official seal.

Notary Public in and for said County & State

My Commission Expires Oct 15 1961.

OWNER'S CERTIFICATE

We hereby certify that we are the owners of or have some right title or interest in the land included in the subdivision shown on the annexed map consisting of two (2) sheets; that we are the only persons whose consent is necessary to pass a clear title to said land; that we hereby consent to the making of said map and subdivision as shown within the colored border line and we hereby offer for dedication lots "A" to "I" inclusive for street purposes and for construction and maintenance of all public utilities, the five and ten foot easements shown by dashed lines and designated as "5' P.U.E." and "10' P.U.E." and five foot drainage easement designated as "5' Drain. Ease." HEEBS - ROEDER ENTERPRISES, INC. a corporation

Charles M. Miller Pres. Charles M. Miller Secy

SECURITY FIRST NATIONAL BANK, successor trustee under deed of trust W. G. Martens and H. P. Hall Trust Officers

PIONEER TITLE INSURANCE COMPANY, a corporation, Trustee under deed of trust

Assured R. Brown Cust. duty

BANK OF AMERICA - NATIONAL TRUST & SAVINGS ASSOCIATION, trustee under deed of trust

TITLE INSURANCE & TRUST CO., a corporation, trustee under deed of trust

Assured Robert Cust. duty

NOTARY ACKNOWLEDGEMENT

STATE OF CALIFORNIA } s.s.
COUNTY OF RIVERSIDE }
On this 25 day of March 1958 before me, the undersigned, a Notary Public in and for said County and State, personally appeared ARMAND E. BRUCE known to me to be the President and Secretary of the corporation that executed the within instrument and they acknowledged to me that they executed the same. WITNESS my hand and official seal.

Notary Public in and for said County and State

My commission expires 3-15-62

ENGINEER'S CERTIFICATE

I hereby certify that I am a Registered Civil Engineer of the State of California and that this map consisting of two (2) sheets correctly represents a survey made under my supervision during March of 1958; that all monuments shown hereon actually exist and their positions are correctly shown.

Registered Civil Engineer No. 862

IN THE CITY OF RIVERSIDE

# VILLA d' ESTE UNIT NO 3

BEING A SUBDIVISION OF A PORTION OF LOTS 6,7,8,10 AND 11, BLK.  
8 R.L. AND I. CO. LANDS. AS RECORDED IN MAP BOOK I PAGE 70,  
RECORDS OF SAN BERNARDINO COUNTY, CALIFORNIA.

APRIL 1937

J.F. DAVIDSON, C.E.

SCALE 1"=100'

**NOTARY ACKNOWLEDGEMENT**

STATE OF CALIFORNIA  
COUNTY OF RIVERSIDE

On this 22 day of APRIL 1937 before me, the undersigned  
a Notary Public in and for said County and State, personally appeared  
J.F. Davidson, known to me to be the J.F. Davidson, President of  
the Villa d'Este, Inc., known to me to be the Secretary of  
said corporation, and executed the within instrument and they  
advised me that they executed the same  
in full compliance with the law.

*J.F. Davidson*  
Notary Public in and for said County & State

**NOTARY ACKNOWLEDGEMENT**

STATE OF CALIFORNIA  
COUNTY OF RIVERSIDE

On this 22 day of APRIL 1937 before me, the undersigned  
a Notary Public in and for said County and State, personally appeared  
J.F. Davidson, known to me to be the J.F. Davidson, President of  
the Villa d'Este, Inc., known to me to be the Secretary of  
said corporation, and executed the within instrument and they  
advised me that they executed the same  
in full compliance with the law.

*J.F. Davidson*  
Notary Public in and for said County & State

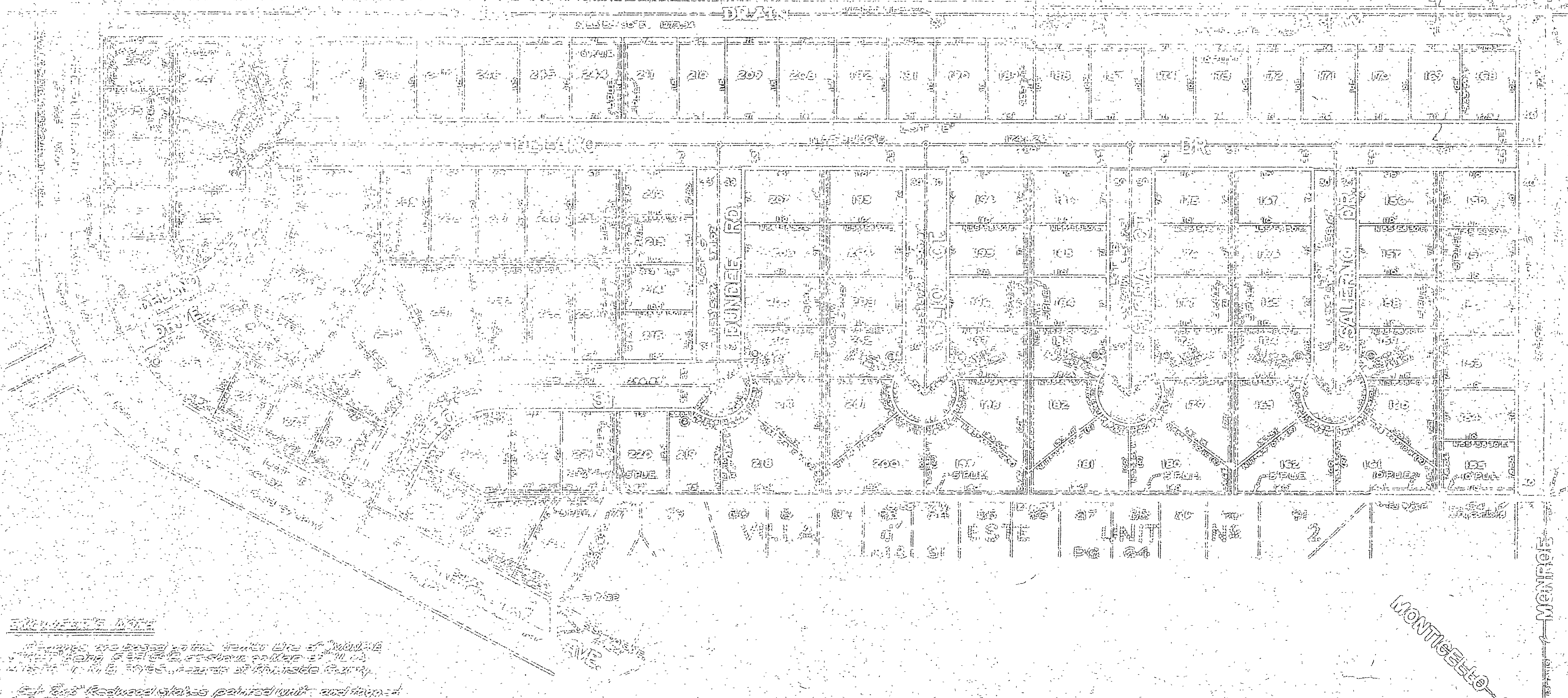

**REMARKS**

1. The lots are based on the center line of Monticello Ave. and Bundy Rd. as shown on the plan. The width of Monticello Ave. is 60 feet and the width of Bundy Rd. is 40 feet.

2. The lots are numbered 1 through 165.

3. The lots are shown with their respective dimensions.

NO.	R.	A.	T.	L.
1	15'	21' 2 1/2"	50'	10.00'
2	12'	20' 5 1/2"	40'	7.99'
3	12'	20' 0"	40'	7.99'
4	12'	165' 07' 1/2"	121' 4 1/2"	21.30'

CALIFORNIA

MONTICELLO AVE

AVENUE