

SIGNING AND STRIPING GENERAL NOTES:

- SIGNING AND STRIPING INSTALLATIONS SHALL CONFORM TO THE 2014 CALIFORNIA MANUAL ON UNIFORM TRAFFIC CONTROL DEVICES (CA MUTCD), THE STATE OF CALIFORNIA DEPARTMENT OF TRANSPORTATION (CALTRANS) STANDARD PLANS AND SPECIFICATIONS DATED 2010, AND ALL ADDENDUMS THERETO, AND THE CITY OF RIVERSIDE PUBLIC WORKS DEPARTMENT STANDARD DRAWINGS, CURRENT EDITION.
- ALL STRIPING, MARKINGS, AND LEGENDS SHALL BE REFLECTORIZED THERMOPLASTIC UNLESS OTHERWISE NOTED. THE CONTRACTOR SHALL PROVIDE AND INSTALL RAISED PAVEMENT MARKERS FOR ALL STRIPING, STRIPING, MARKINGS AND LEGENDS SHALL CONFORM TO THE LATEST CALTRANS STANDARD PLANS A20A THRU A20D AND A24A THRU A24E.
- AT LOCATIONS WHERE EXISTING PAINTED CURB IS TO BE RECONSTRUCTED, THE CONTRACTOR SHALL PAINT THE NEW CURB AS SHOWN ON THE PLANS WITHIN 10 WORKING DAYS OF CURB CONSTRUCTION OR AS DIRECTED BY ENGINEER. THE PAINT SHALL BE WATER-BASED WITH 2-YEAR GUARANTEE AGAINST COLOR FADING. PRIOR TO THE START OF CONSTRUCTION, THE CONTRACTOR SHALL SUBMIT TO THE CITY WRITTEN PROOF OF THE MANUFACTURER'S 2-YEAR GUARANTEE.
- ALL NEW STRIPING SHALL BE "CAT TRACKED" AND APPROVED BY THE ENGINEER PRIOR TO FINAL INSTALLATION. THE CONTRACTOR SHALL NOTIFY THE ENGINEER AFTER COMPLETING LAYOUT AND AT LEAST 3 WORKING DAYS BEFORE COMMENCING INSTALLATION OF STRIPING, MARKINGS AND MARKERS.
- TRAFFIC SIGN FACE SHALL BE 3M DIAMOND GRADE DG3 REFLECTIVE SHEETING (ASTM XI) OR APPROVED EQUAL WITH PROTECTIVE GRAFFITI OVERLAY FILM OR AS OTHERWISE NOTED. ALL WARNING SIGNS SHALL HAVE A FLUORESCENT YELLOW BACKGROUND AND SCHOOL SIGNS NOTED SHALL HAVE A FLUORESCENT YELLOW-GREEN BACKGROUND.
- SIGNS SHALL BE STANDARD SIZE UNLESS NOTED OTHERWISE. PRIOR TO INSTALLATION, NEW SIGNS SHALL BE APPROVED BY THE CITY OF RIVERSIDE. EXACT LOCATIONS OF SIGNS SHALL BE DETERMINED BY THE CITY ENGINEER.
- ALL EXISTING SIGNS AND POSTS TO BE REMOVED SHALL BE DELIVERED TO THE CITY OF RIVERSIDE SIGN DEPARTMENT.
- STRIPING SHALL BE APPLIED WITHIN 48 HOURS OF SURFACE COURSE REPLACEMENT ON STREETS OPEN TO THE PUBLIC. IN NO CASE SHALL A NEWLY PAVED STREET OPEN TO THE PUBLIC BE LEFT UNSTRIPED OVER A WEEKEND OR HOLIDAY.
- CONTRACTOR SHALL INSTALL NEW SIGN(S) AND/OR POST(S) PER CITY OF RIVERSIDE STANDARD DRAWING No. 664, SEE SPECIFICATIONS. 13. CONTRACTOR SHALL INSTALL NEW STREET NAME SIGNS AND POST PER CITY OF RIVERSIDE STANDARD DRAWING No. 662, SEE SPECIFICATIONS.
- ALL CONFLICTING STRIPING, PAVEMENT MARKINGS, LEGENDS, AND RAISED PAVEMENT MARKERS SHALL BE REMOVED EVEN IF NOT SHOWN ON PLANS. REMOVALS OF PAINTED STRIPING, PAVEMENT MARKINGS AND LEGENDS SHALL BE DONE BY WET SANDBLASTING. REMOVALS OF THERMOPLASTIC STRIPING, PAVEMENT MARKINGS AND LEGENDS SHALL BE REMOVED BY WET SANDBLASTING, GRINDING OR OTHER APPROVED METHOD AND SHALL NOT DAMAGE THE PAVEMENT. "BLACK OUT" OF EXISTING DELINEATION IS NOT PERMITTED. ALL DAMAGED PAVEMENT DUE TO REMOVALS SHALL BE REPAIRED AS NECESSARY TO MAINTAIN A SMOOTH AND UNIFORM SURFACE OR AS DIRECTED BY THE ENGINEER. ALL STRIPING REMOVALS AND LEGENDS SHALL BE "FOG SEALED".
- WHERE APPLICABLE, OUTBOUND LANE LINE DETAILS SHALL COMMENCE AT THE CROSSWALK, MEANING THE PAINTED PORTION OF THE DETAIL SHALL JOIN THE CROSSWALK.

SIGNING AND STRIPING LEGEND AND CONSTRUCTION NOTES:

- (E)** EXISTING TO REMAIN.
- (#)** INSTALL CALTRANS STRIPING DETAIL PER NUMBER NOTED, INCLUDING INSTALLATION OF RAISED PAVEMENT MARKERS.
- (PM)** INSTALL PAVEMENT MARKING OR ARROW AS NOTED.
- (RP)** REMOVE ALL EXISTING CONFLICTING TRAFFIC STRIPING AND MARKINGS AS NOTED, INCLUDING RAISED PAVEMENT MARKERS.
- (1-1)** SIGN LOCATION
- (IS)** FURNISH AND INSTALL ROADSIDE SIGN(S) OR SNS WITH/WITHOUT POST
- (RS)** REMOVE SIGN(S)
- (RL)** RELOCATE EXISTING SIGN(S) TO EXISTING POST OR INSTALL POST (IF APPLICABLE)
- (S)** EXISTING SIGNALIZED INTERSECTION
- (P)** PROPOSED SIGN (ONE POST)
- (E)** EXISTING SIGN (ONE POST)
- (C)** EXISTING SIGN (ON STREET LIGHT)
- (A)** EXISTING STREET NAME SIGN
- (1)** INSTALL MIDWEST GUARDRAIL SYSTEM PER CALTRANS STANDARD PLAN A77L1 WITH FIXED DELINEATORS, SEE DETAIL, AT EVERY OTHER POST
- (2)** CONTRACTOR SHALL INSTALL MIDWEST GUARDRAIL END TREATMENT PER CALTRANS STANDARD PLAN A77S1
- (3)** CONTRACTOR SHALL INSTALL GUARDRAIL EMBANKMENT TREATMENT PER CALTRANS STANDARD PLAN A77P1, TYPE 11B LAYOUT.

STRIPING/SIGNAGE QUANTITIES - ALL SHEET					
ITEM	DESCRIPTION	QUANTITY			UNIT
		SHEET 1	SHEET 2	SHEET 3	
1	DETAIL 22	920	1500	1205	3625 LF
2	DETAIL 29	0	985	1000	1985 LF
3	DETAIL 32	0	890	155	1045 LF
4	DETAIL 38	135	465	0	600 LF
5	DETAIL 39	1790	4565	3305	9660 LF
6	DETAIL 40	0	105	0	105 LF
7	DETAIL 41	0	110	0	110 LF
8	4" SOLID WHITE	0	0	50	50 LF
9	PAVEMENT LEGENDS/MARKINGS	30	120	0	150 SF
10	GUARDRAIL	0	2820	2055	4875 LF
11	GUARDRAIL DELINEATORS	0	94	69	163 EA
12	MIDWEST GUARDRAIL END TREATMENT	0	8	2	10 EA
13	GUARDRAIL EMBANKMENT TREATMENT	0	4	2	6 EA
14	SIGN WITH POST	0	1	2	3 EA

GUARDRAIL DELINEATOR DETAIL

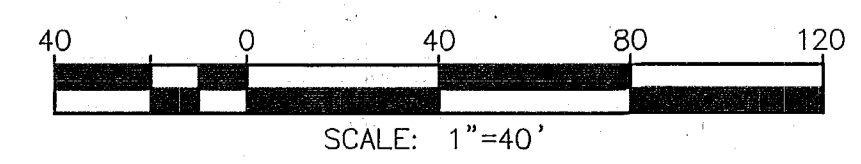
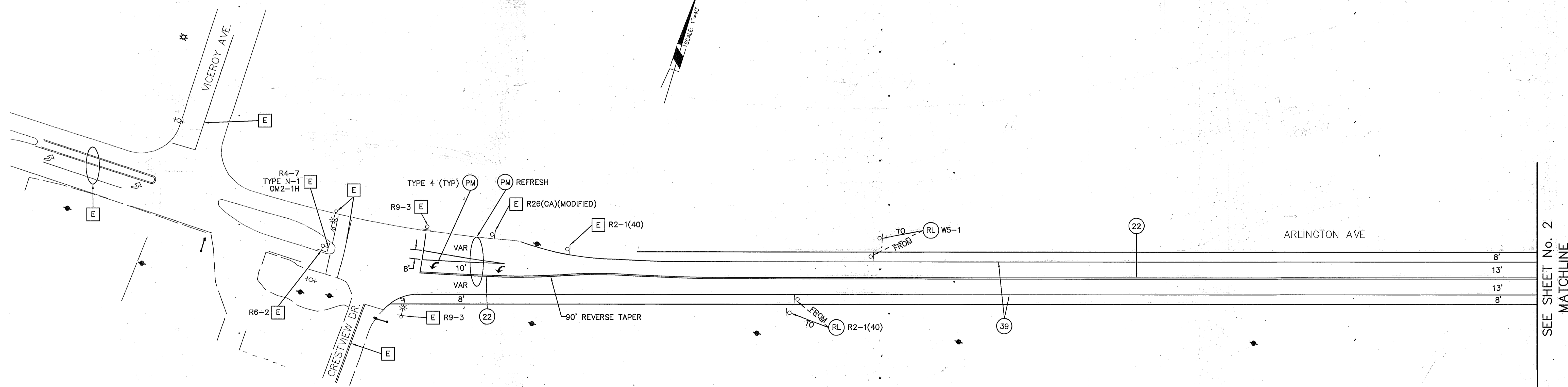
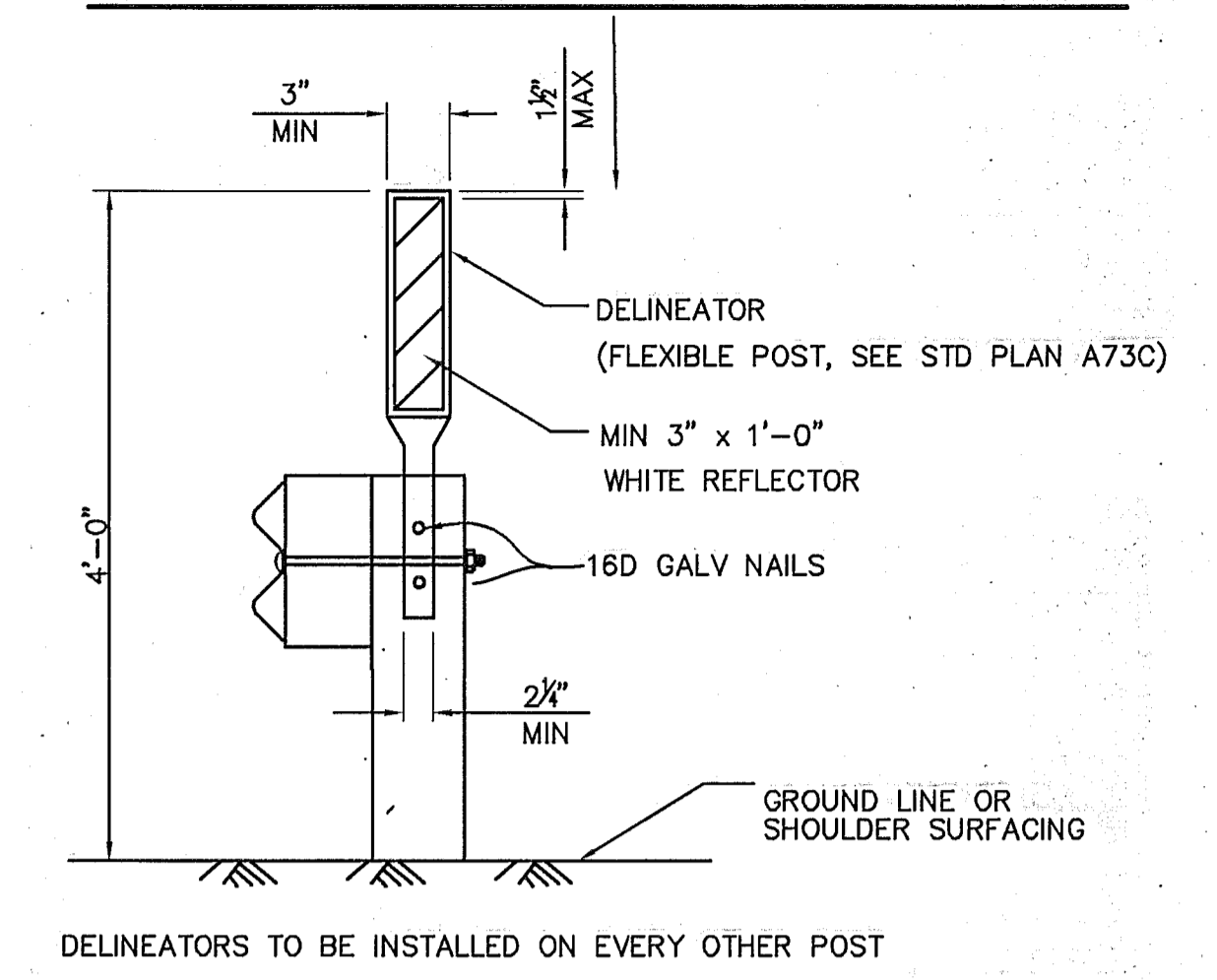

Under Ground Service Alert of Southern California
Call: TOLL FREE 1-800-227-2600
TWO WORKING DAYS BEFORE YOU DIG

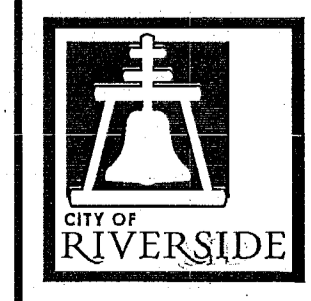

ENGINEER IN RESPONSIBLE CHARGE
GILBERT M. HERNANDEZ
R.C.E. No. 69170 EXPIRES 6-30-18
DATE 2-3-13

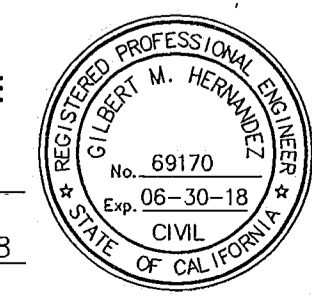

DESIGNED BY	MAB	DRAWN BY	MAB	CHECKED BY	GMH
MARK		REVISIONS		APPR. DATE	

CITY OF RIVERSIDE, CALIFORNIA DEPARTMENT OF PUBLIC WORKS

APPROVED BY	BY	DATE	APPROVED BY
ENGINEERING MANAGER	E.L.	8-8-17	[Signature]
TRAFFIC DIVISION	NM	8/8/17	CITY ENGINEER
CONSTRUCTION ADMIN.	DC	8/13/17	

DATE 8/10/17

SIGNING AND STRIPING PLAN
ARLINGTON AVENUE
FROM WESTLERLY CITY LIMITS
TO FAIRHAVEN DRIVE

SCALE: 1" = 40'

XL-740
SHEET 1 OF 3
FILE NAME: XL-740.DWG

SEE SHEET NO. 2 MATCHLINE

MATCHLINE
SEE SHEET No. 1

SEE BELOW LEFT
MATCHLINE

MATCHLINE
SEE ABOVE RIGHT

SEE SHEET No. 3
MATCHLINE

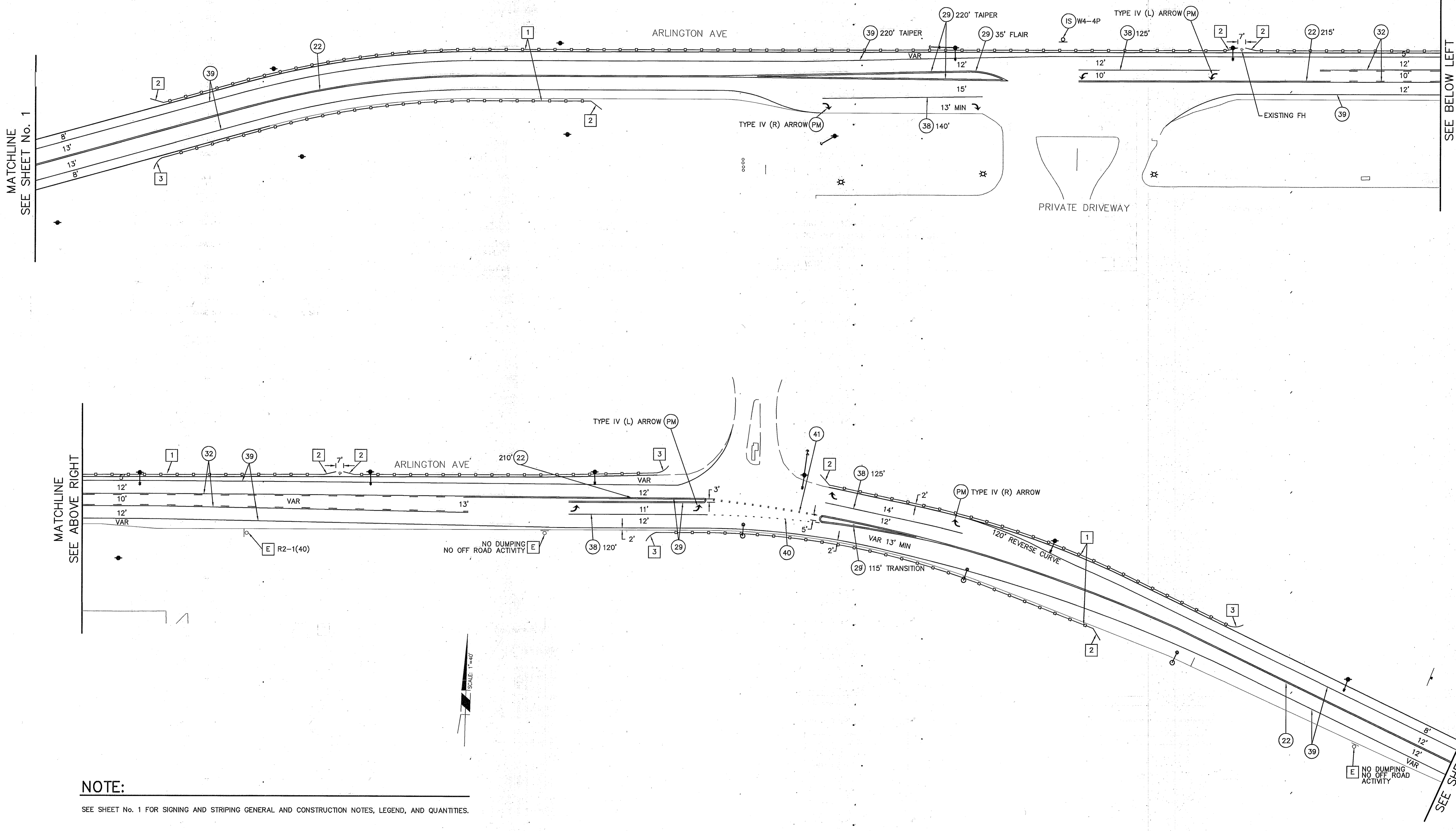

NOTE:
SEE SHEET No. 1 FOR SIGNING AND STRIPING GENERAL AND CONSTRUCTION NOTES, LEGEND, AND QUANTITIES.

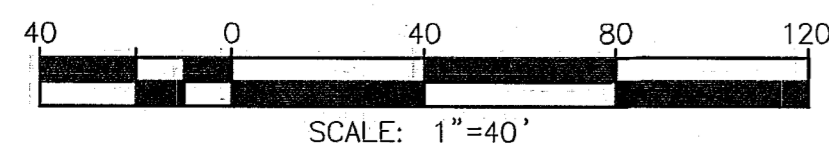

Under Ground Service Alert
of Southern California
Call: TOLL FREE
1-800
227-2600
TWO WORKING DAYS BEFORE YOU DIG

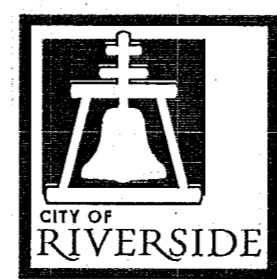

ENGINEER IN RESPONSIBLE CHARGE
GILBERT M. HERNANDEZ
R.C.E. No. 69170 EXPIRES: 6-30-18
DATE: 2-31-17



MARK	REVISIONS	APPR.	DATE

DESIGNED BY: MAB DRAWN BY: MAB CHECKED BY: GMH

CITY OF RIVERSIDE, CALIFORNIA
DEPARTMENT OF PUBLIC WORKS

APPROVED BY	BY	DATE	APPROVED BY
ENGINEERING MANAGER	E.L.	8/8/17	SOLTY ENGINEER
TRAFFIC DIVISION	N/A	8/13/17	
CONSTRUCTION ADMIN.	DC	8/3/17	
			DATE: 8/10/17

SIGNING AND STRIPING PLAN
ARLINGTON AVENUE
FROM WESTERLY CITY LIMITS
TO FAIRHAVEN DRIVE
SCALE: 1" = 40'

XL-740
SHEET 2 OF 3
FILE NAME: XL-740.DWG

G:\Admin\Comm\Design Projects\13-004 Arlington Avenue Improvements (City Limits to Fairhaven)\Design Plans\Traffic\XL740.dwg

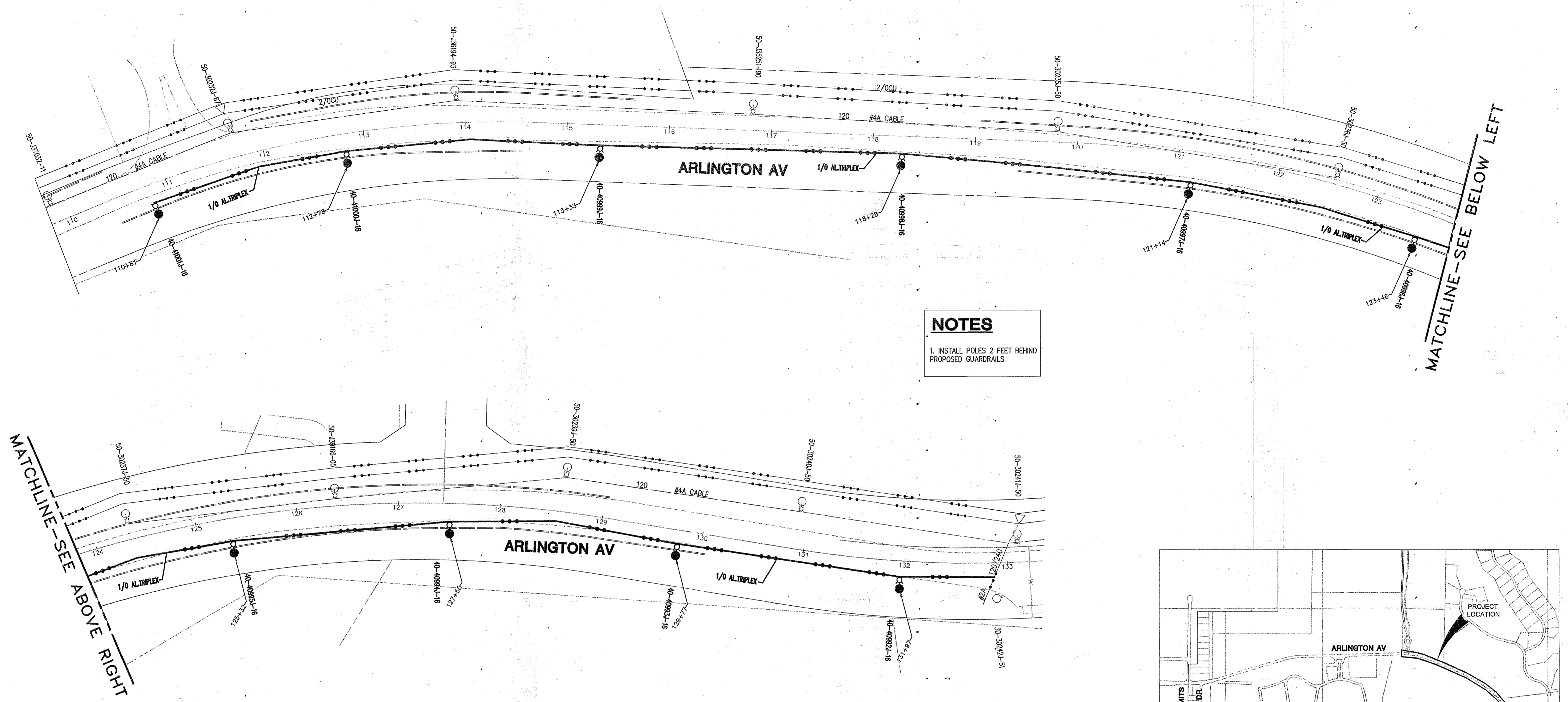

NOTES
 1. INSTALL POLES 2 FEET BEHIND PROPOSED GUARDRAILS

MATCHLINE - SEE BELOW LEFT

MATCHLINE - SEE ABOVE RIGHT

DEPARTMENT CONTRACTOR PARTICIPATION

- FOR ENGINEERING INFORMATION AND/OR STAKING, CONTACT GARY HIRONIMUS @ 951-826-5675.
- COORDINATE ALL WORK AND SWITCHING OPERATIONS WITH DISPATCH @ 951-351-6227.
- CONTACT UNDERGROUND SERVICE ALERT @ 1-800-227-2600 48 HOURS PRIOR TO DIGGING.
- REPLACE CROSSARMS, PINS, & INSULATORS AS MAY BE REQUIRED FOR RECONDUCTOR WORK.
- COORDINATE ALL OUTAGES WITH CUSTOMERS.
- ALL FACILITIES INSTALLED BY CONTRACTOR SHALL BE INSPECTED AND APPROVED BY THE DEPARTMENT CONSTRUCTION INSPECTOR @ 951-826-2335. ANY CHANGES SHALL BE APPROVED BY THE DEPARTMENT PRIOR TO EXECUTION.
- ALL CONTRACTORS WORKING ON OR AROUND THE DEPARTMENT'S OVERHEAD ELECTRICAL FACILITIES MUST HAVE THE PROPERLY QUALIFIED PERSONNEL AND EQUIPMENT TO PERFORM THE SPECIFIED WORK. THE CONTRACTOR WILL BE SOLELY RESPONSIBLE TO ESTABLISH AND MAINTAIN A SAFE WORKING ENVIRONMENT INCLUDING, BUT NOT LIMITED TO, WORK AROUND ENERGIZED HIGH VOLTAGE FACILITIES, TRAFFIC AND PROTECTION.
- THE CITY OBSERVER HAS THE AUTHORITY TO STOP THE CONTRACTOR'S WORK IF HE DETERMINES THAT ADEQUATE SAFETY PRECAUTIONS ARE NOT BEING TAKEN. HOWEVER, THE PRESENCE OF THE CITY OBSERVER DOES NOT RELIEVE THE CONTRACTOR OF HIS RESPONSIBILITY FOR INSURING SAFE AND APPROPRIATE WORK PRACTICES.
- ALL LANDSCAPING IN STREET R/W SHALL BE RETURNED TO ORIGINAL CONDITION.

PLAN LEGEND

- (xxx) APPROX. LENGTH OF POLE SPAN
- PROPOSED 3-WIRE FACILITIES
- - - - - EXISTING 2-WIRE FACILITIES
- EXISTING 3-WIRE FACILITIES
- EXISTING WOOD POLE
- NEW WOOD POLE
- ⊕ EXISTING MAST ARM STREET LIGHT
- ⊕ PROPOSED 139W LED MAST ARM STREET LIGHT MODEL # BXPCHT3MEF57K-ULSN
- ▽ EXISTING TRANSFORMER
- PROPOSED GUARDRAIL

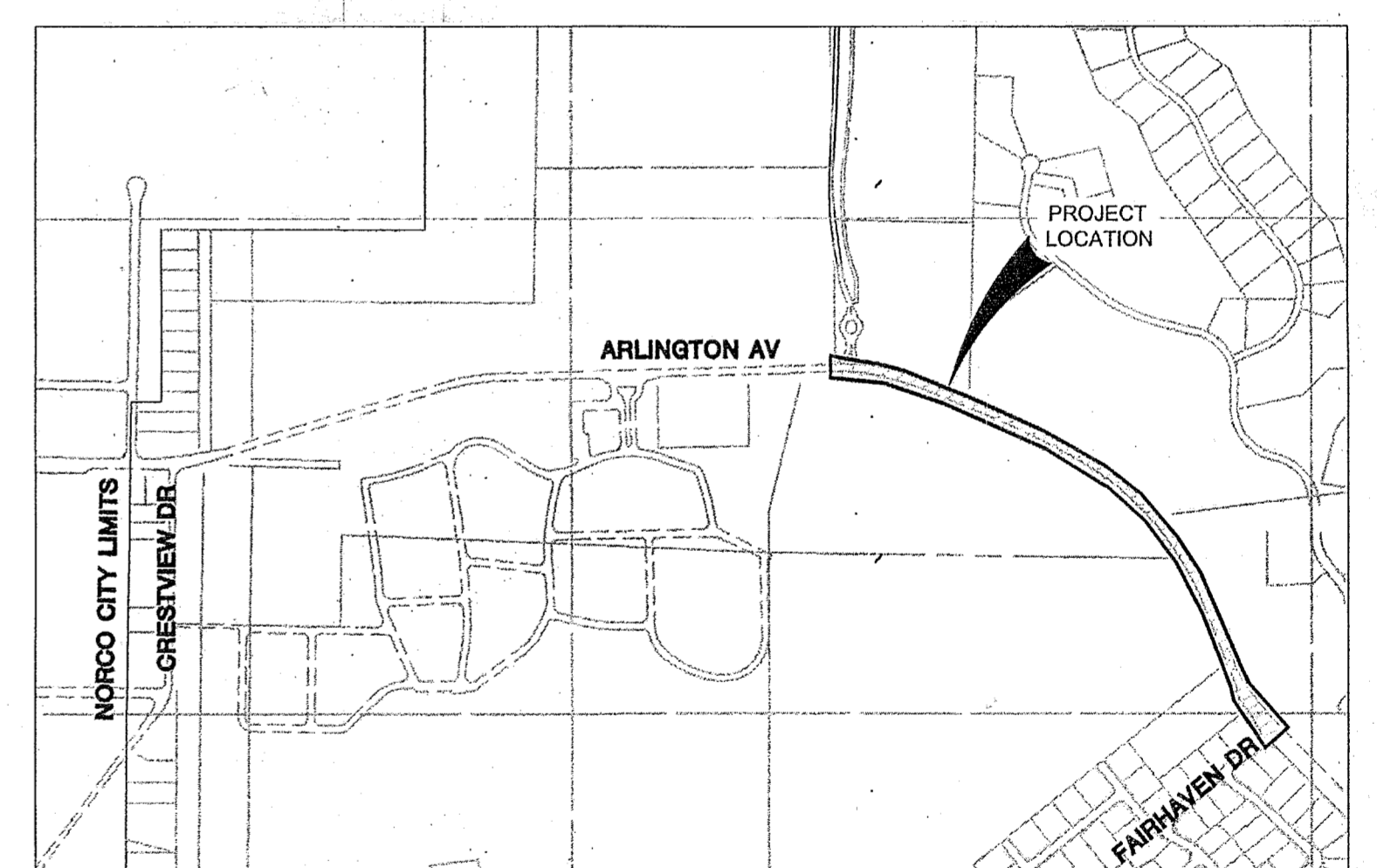
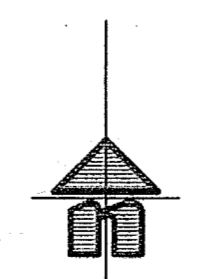

VICINITY MAP
 NTS

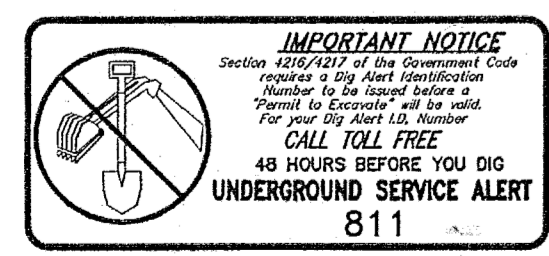

EST. DEM. REF DWGS:		CIRCUIT # 1281 & 1284	
NEW POWER POLES WITH MASTARMS FOR: ARLINGTON AVENUE WIDENING ARLINGTON AVE BETWEEN FAIRHAVEN DR AND CRESTVIEW DR			
SCALE 1" = 50'	DRAWN S.RIVERA	CITY OF RIVERSIDE DEPARTMENT OF PUBLIC UTILITIES	
DATE 03/09/2016	CHECKED [Signature]		
SPA NO.	APPROVED [Signature]	TASK # 01	UOL
MAP BK 47-2	BOARD DATE	WORK ORDER # 1619080	
PERMIT NO.	ACCT. 6130000-470637	DIV. 5	PROJECT/SUBPROJECT # 160023-8
ASBUILT/ APPROV.	REVISIONS	DATE	SHEET 1 OF 1