

# IN THE CITY OF RIVERSIDE, CALIFORNIA

# SIGNING & STRIPING PLAN

PALM AVE 10+82.75 TO 11+99.38

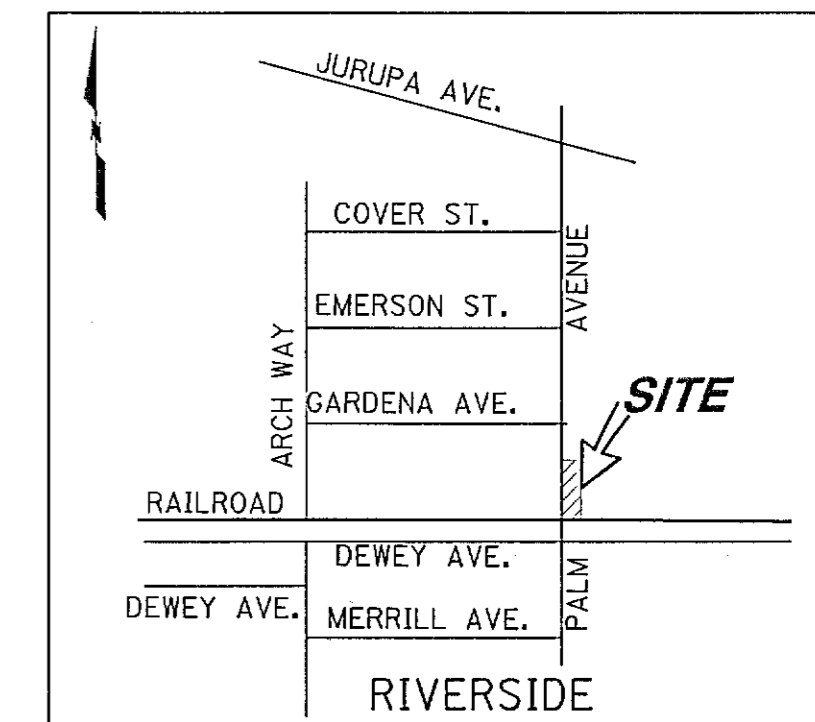

VICINITY MAP  
NOT TO SCALE

### GENERAL NOTES

1. NO PERSON SHALL PERFORM ANY CONSTRUCTION ACTIVITY OR INSTALL ANY OBJECTS WITHIN THE PUBLIC RIGHTS-OF-WAY OR EASEMENTS OF THE CITY OF RIVERSIDE WITHOUT A VALID CONSTRUCTION PERMIT OR, A STREET OPENING PERMIT OR AN ENCROACHMENT PERMIT ISSUED BY THE CITY'S PUBLIC WORKS DEPARTMENT.
2. IT SHALL BE THE RESPONSIBILITY OF THE CONTRACTOR TO CLEAR THE RIGHT-OF-WAY IN ACCORDANCE WITH THE PROVISIONS OF LAW AS IT AFFECTS EACH UTILITY INCLUDING IRRIGATION LINES AND APPURTENANCES AND AT NO COST TO THE CITY.
3. CONSTRUCTION SHALL BE IN ACCORDANCE WITH THE CITY OF RIVERSIDE PUBLIC UTILITIES DEPARTMENT WATER DIVISION, STANDARD DRAWINGS, ITS SUPPLEMENTAL NOTES, THE NFPA 24 STANDARDS AND THE STANDARD SPECIFICATIONS FOR PUBLIC WORKS CONSTRUCTION, CURRENT EDITION.
4. THE PRIVATE ENGINEER SIGNING THESE PLANS IS RESPONSIBLE FOR ASSURING THE ACCURACY AND ACCEPTABILITY OF THE WORK HEREON. IN THE EVENT OF DISCREPANCIES ARISING DURING CONSTRUCTION, THE PRIVATE ENGINEER SHALL BE RESPONSIBLE FOR DETERMINING AN ACCEPTABLE SOLUTION AND REVISING THE PLANS FOR APPROVAL BY THE CITY.
5. QUANTITIES SHOWN ARE FOR INFORMATION ONLY AND THE CITY OF RIVERSIDE IS NOT RESPONSIBLE FOR THEIR ACCURACY.
6. ALL FLAGGED ELEVATIONS SHALL BE STAKED IN THE FIELD BY THE PRIVATE ENGINEER.
7. THE CONTRACTOR SHALL CALL IN A LOCATION REQUEST TO UNDERGROUND SERVICE ALERT (USA), PHONE # 811, TWO WORKING DAYS BEFORE DIGGING. NO CONSTRUCTION PERMIT WILL BE ISSUED BY THE PUBLIC WORKS DEPARTMENT INVOLVING EXCAVATION FOR UNDERGROUND FACILITIES UNLESS THE APPLICANT HAS BEEN PROVIDED AN INQUIRY IDENTIFICATION NUMBER BY U.S.A.
8. CONTRACTOR IS TO VERIFY EXISTING UTILITY LOCATIONS AND ELEVATIONS PRIOR TO START OF CONSTRUCTION.
9. ALL TRAFFIC SIGNS SHALL BE INSTALLED PRIOR TO OPENING THE STREETS TO TRAFFIC.
10. ANY TRAFFIC CONTROL STRIPING OBLITERATED AND/OR BADLY WORN DURING CONSTRUCTION SHALL BE RESTORED BY CONTRACTOR WITHIN FIVE DAYS AFTER NOTIFICATION FROM THE CITY INSPECTORS.
11. FINAL STRIPING FOR TRAFFIC CONTROL AND/OR PAVEMENT MARKING TO BE THE RESPONSIBILITY OF THE DEVELOPER.
12. NO IMPROVEMENTS SHALL BE DONE WITHIN 25' OF THE RAILROAD TRACKS. ACTUAL START LOCATION OF ALL SIGNING AND STRIPING OR ANY OTHER IMPROVEMENTS SHALL BE VERIFIED ONSITE BY THE PUBLIC WORKS INSPECTOR.
13. CONTRACTOR TO VERIFY IN FIELD THAT ALL PROPOSED STRIPING MATCHES EXISTING STRIPING WIDTHS.

### GENERAL SIGNING AND STRIPING NOTES

1. SIGNING AND STRIPING INSTALLATIONS SHALL CONFORM TO THE CALIFORNIA MANUAL ON UNIFORM TRAFFIC CONTROL DEVICES (CA MUTCD), THE STATE OF CALIFORNIA DEPARTMENT OF TRANSPORTATION (CALTRANS) STANDARD PLANS AND SPECIFICATIONS DATED 2018, AND ALL ADDENDUMS THERETO, AND THE CITY OF RIVERSIDE PUBLIC WORKS DEPARTMENT STANDARD DRAWINGS, CURRENT EDITION.
2. ALL STRIPING, MARKINGS, AND LEGENDS SHALL BE REFLECTORIZED THERMOPLASTIC UNLESS OTHERWISE NOTED. THE CONTRACTOR SHALL PROVIDE AND INSTALL RAISED PAVEMENT MARKERS FOR ALL STRIPING, STRIPING, MARKINGS AND LEGENDS SHALL CONFORM TO THE LATEST CALTRANS STANDARD PLANS A20A THRU A20D AND A24A THRU A24E.
3. PRIOR TO FINAL ACCEPTANCE OF STREET IMPROVEMENTS, ALL PAVEMENT STRIPING AND STENCILING WITHIN THE PERIMETER OF THE CONSTRUCTION AREA SHALL BE RESTORED TO LIKE NEW CONDITION, IN A MANNER MEETING THE APPROVAL OF THE CITY OF RIVERSIDE.
4. THE CONTRACTOR SHALL RE-STRIP EXISTING STRIPING AND CURB MARKINGS OBLITERATED BY NEW CONSTRUCTION, WHETHER OR NOT SHOWN ON THE PLANS FOR REPLACEMENT, AT NO COST TO THE CITY.
5. AT LOCATIONS WHERE EXISTING PAINTED CURB IS TO BE RECONSTRUCTED, THE CONTRACTOR SHALL PAINT THE NEW CURB AS SHOWN ON THE PLANS WITHIN 10 WORKING DAYS OF CURB CONSTRUCTION OR AS DIRECTED BY ENGINEER. THE PAINT SHALL BE WATER-BASED WITH 2-YEAR GUARANTEE AGAINST COLOR FADING. PRIOR TO THE START OF CONSTRUCTION, THE CONTRACTOR SHALL SUBMIT TO THE CITY WRITTEN PROOF OF THE MANUFACTURER'S 2-YEAR GUARANTEE.
6. ALL NEW STRIPING SHALL BE "CAT TRACKED" AND APPROVED BY THE ENGINEER PRIOR TO FINAL INSTALLATION. THE CONTRACTOR SHALL NOTIFY THE ENGINEER AFTER COMPLETING LAYOUT AND AT LEAST 3 WORKING DAYS BEFORE COMMENCING INSTALLATION OF STRIPING, MARKINGS AND MARKERS.
7. TRAFFIC SIGN FACE SHALL BE 3M DIAMOND GRADE DG3 REFLECTIVE SHEETING (ASTM XI) OR APPROVED EQUAL WITH PROTECTIVE GRAFFITI OVERLAY FILM OR AS OTHERWISE NOTED. ALL WARNING SIGNS SHALL HAVE A FLUORESCENT YELLOW BACKGROUND AND SCHOOL SIGNS NOTED SHALL HAVE A FLUORESCENT YELLOW-GREEN BACKGROUND.
8. SIGNS SHALL BE STANDARD SIZE UNLESS NOTED OTHERWISE. PRIOR TO INSTALLATION, NEW SIGNS SHALL BE APPROVED BY THE CITY OF RIVERSIDE. EXACT LOCATIONS OF SIGNS SHALL BE DETERMINED BY THE CITY ENGINEER.
9. ALL EXISTING SIGNS AND SIGN POSTS TO BE REMOVED SHALL BE DELIVERED TO THE CITY OF RIVERSIDE SIGN DEPARTMENT.
10. WHEN PAINT IS SPECIFIED, TRAFFIC STRIPES AND MARKINGS SHALL BE APPLIED IN TWO COATS. A MINIMUM OF SEVEN DAYS SHALL BE PROVIDED BETWEEN FIRST AND SECOND COATS.
11. STRIPING SHALL BE APPLIED WITHIN 48 HOURS OF SURFACE COURSE REPLACEMENT ON STREETS OPEN TO THE PUBLIC. IN NO CASE SHALL A NEWLY PAVED STREET OPEN TO THE PUBLIC BE LEFT UNSTRIPED OVER A WEEKEND OR HOLIDAY.
12. CONTRACTOR SHALL INSTALL NEW SIGN(S) AND/OR POST(S) PER CITY OF RIVERSIDE STANDARD DRAWING NO. 664, SEE SPECIFICATIONS.
13. ALL CONFLICTING STRIPING, PAVEMENT MARKINGS, LEGENDS, AND RAISED PAVEMENT MARKERS SHALL BE REMOVED EVEN IF NOT SHOWN ON PLANS. REMOVALS OF PAINTED STRIPING, PAVEMENT MARKINGS AND LEGENDS SHALL BE DONE BY WET SANDBLASTING. REMOVALS OF THERMOPLASTIC STRIPING, PAVEMENT MARKINGS AND LEGENDS SHALL BE REMOVED BY WET SANDBLASTING, GRINDING OR OTHER APPROVED METHOD AND SHALL NOT DAMAGE THE PAVEMENT. "BLACK OUT" OF EXISTING DELINEATION IS NOT PERMITTED. ALL DAMAGED PAVEMENT DUE TO REMOVALS SHALL BE REPAIRED AS NECESSARY TO MAINTAIN A SMOOTH AND UNIFORM SURFACE OR AS DIRECTED BY THE ENGINEER. ALL STRIPING REMOVALS AND LEGENDS SHALL BE "FOG SEALED".
14. WHERE APPLICABLE, OUTBOUND LANE LINE DETAILS SHALL COMMENCE AT THE LIMIT LINE, MEANING THE PAINTED PORTION OF THE DETAIL SHALL JOIN THE LIMIT LINE.

### WORK TO BE DONE

THESE IMPROVEMENTS CONSIST OF THE FOLLOWING WORK TO BE DONE ACCORDING TO THESE PLANS, THE CURRENT CITY OF RIVERSIDE STANDARDS AND SPECIFICATIONS, AND THE LATEST EDITION OF THE STANDARD SPECIFICATIONS FOR PUBLIC WORK CONSTRUCTION ("GREEN BOOK"), CALTRANS STANDARD PLANS (2018 EDITION); AND 2014 CA MUTCD.

### PRIVATE ENGINEER'S NOTE TO CONTRACTOR

ALL CONTRACTORS AND SUBCONTRACTORS PERFORMING WORK SHOWN ON OR RELATED TO THESE PLANS SHALL CONDUCT THEIR OPERATIONS SO THAT ALL EMPLOYEES ARE PROVIDED A SAFE PLACE TO WORK AND THE PUBLIC IS PROTECTED. ALL CONTRACTORS AND SUBCONTRACTORS SHALL COMPLY WITH THE OCCUPATIONAL SAFETY AND HEALTH REGULATIONS OF THE U.S. DEPARTMENT OF LABOR AND THE STATE OF CALIFORNIA DEPARTMENT OF INDUSTRIAL RELATIONS CONSTRUCTION SAFETY ORDERS. THE CIVIL ENGINEER SHALL NOT BE RESPONSIBLE IN ANY WAY FOR THE CONTRACTOR'S AND SUBCONTRACTOR'S COMPLIANCE WITH SAID REGULATIONS AND ORDERS.

CONTRACTOR FURTHER AGREES THAT HE SHALL ASSUME SOLE AND COMPLETE RESPONSIBILITY FOR JOB-SITE CONDITIONS DURING THE COURSE OF CONSTRUCTION OF THIS PROJECT, INCLUDING SAFETY OF ALL PERSONS AND PROPERTY, THAT THIS REQUIREMENT SHALL APPLY CONTINUOUSLY AND NOT BE LIMITED TO NORMAL WORKING HOURS, AND THAT THE CONTRACTOR SHALL DEFEND, INDEMNIFY AND HOLD THE OWNER AND CIVIL ENGINEER HARMLESS FROM ANY AND ALL LIABILITY, REAL OR ALLEGED, IN CONNECTION WITH THE PERFORMANCE OF WORK ON THIS PROJECT, EXCEPTION FOR LIABILITY ARISING FROM THE SOLE NEGLIGENCE OF THE OWNER OR ENGINEER.

THE EXISTENCE AND APPROXIMATE LOCATIONS OF ANY UNDERGROUND UTILITIES OR STRUCTURES SHOWN ON THESE PLANS ARE OBTAINED BY A SEARCH OF THE AVAILABLE RECORDS. THE CIVIL ENGINEER ASSUMES NO LIABILITY AS TO THE EXACT LOCATION OF SAID LINES NOR FOR UTILITY OR IRRIGATION LINES WHOSE LOCATIONS ARE NOT SHOWN. THE CONTRACTOR SHALL BE RESPONSIBLE FOR NOTIFYING ALL UTILITY AND IRRIGATION COMPANIES PRIOR TO WORK OR EXCAVATION TO DETERMINE THE EXACT LOCATIONS OF ALL LINES AFFECTING THIS WORK, WHETHER OR NOT SHOWN HERE ON, AND FOR ANY DAMAGE OR PROTECTION TO THESE LINES.

### APPLICANT/DEVELOPER CIVIL ENGINEER

FRONTERA REAL ESTATE INVESTMENTS  
1770 IOWA AVENUE, SUITE 230  
SAN DIEGO, CA 92108  
ATTN: BRYAN GRISSINGER  
(619) 756-4622

RICK ENGINEERING COMPANY  
1770 IOWA AVENUE, SUITE 100  
RIVERSIDE, CA 92507  
ATTN: KRISTIN WERKSMAN, PE  
(951) 782-0707

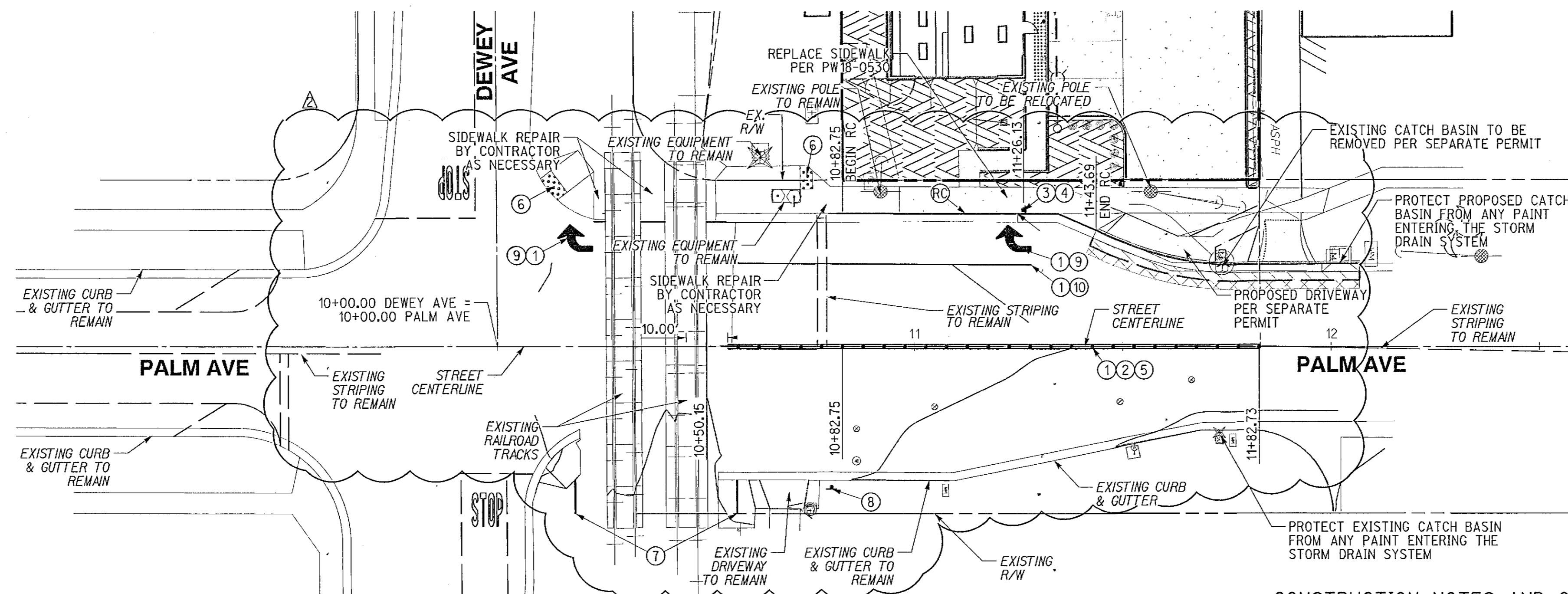

### NOTICE TO CONTRACTOR

THE EXISTENCE AND LOCATIONS OF ALL UNDERGROUND UTILITIES (UTILITY PIPES, STRUCTURES, ETC.) SHOWN ON THESE PLANS (MAIN LINES ONLY - NO SERVICE LATERALS) WERE ASCERTAINED BY A REVIEW OF RECORDS PROVIDED BY THESE MEMBER AGENCIES AND ARE APPROXIMATE. NEITHER THE OWNER NOR THE ENGINEER ASSUMES ANY RESPONSIBILITY FOR UTILITIES NOT SHOWN OR NOT IN THE LOCATION SHOWN. THE CONTRACTOR IS REQUIRED TO TAKE DUE PRECAUTIONARY MEASURES TO PROTECT THE UTILITY LINES SHOWN AND ANY OTHER LINES NOT OF RECORD OR NOT SHOWN ON THESE PLANS. LOCATIONS OF UTILITIES SHALL BE VERIFIED BY THE CONTRACTOR PRIOR TO COMMENCEMENT OF CONSTRUCTION. CALL UNDERGROUND SERVICE ALERT (U.S.A.) 811 AT LEAST 2 WORKING DAYS PRIOR TO COMMENCEMENT OF CONSTRUCTION.

### ENGINEER'S NOTES

PRIVATE ENGINEER WILL NOT BE PROVIDING INSPECTION SERVICES OR CONSTRUCTION REVIEW. THESE FUNCTIONS ARE THE RESPONSIBILITY OF THE CITY AND/OR THE GENERAL CONTRACTOR. ENGINEER ACCEPTS NO LIABILITY FOR SUCH FUNCTIONS OR WORK THEREOF.

### DECLARATION OF RESPONSIBLE CHARGE

I HEREBY DECLARE THAT I AM THE ENGINEER OF WORK FOR THIS PROJECT, THAT I HAVE EXERCISED RESPONSIBLE CHARGE OVER THE PROJECT AS DEFINED IN SECTION 6703 OF THE BUSINESS AND PROFESSIONS CODE, AND THAT THE DESIGN IS CONSISTENT WITH THE CURRENT STANDARD. I UNDERSTAND THAT THE CHECK OF THE PROJECT DRAWINGS AND SPECIFICATIONS BY THE CITY OF RIVERSIDE IS CONFINED TO A REVIEW ONLY AND DOES NOT RELIEVE ME, AS ENGINEER OF WORK, OF MY RESPONSIBILITIES FOR PROJECT DESIGN.

RICK ENGINEERING COMPANY  
1770 IOWA AVENUE, SUITE 100  
RIVERSIDE, CA 92507

BY: Kristin M Werkman DATED: 1/26/21  
KRISTIN M WERKSMAN R.C.E. 69317

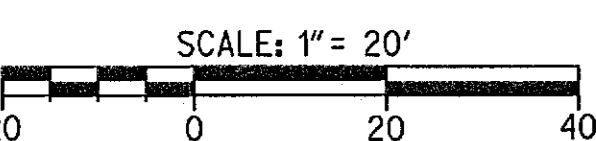

**CAUTION:**  
EXACT LOCATION OF EXISTING UNDERGROUND FACILITIES IS UNKNOWN. CONTRACTOR TO VERIFY IN FIELD.



Call at least 2 working days prior to excavating.

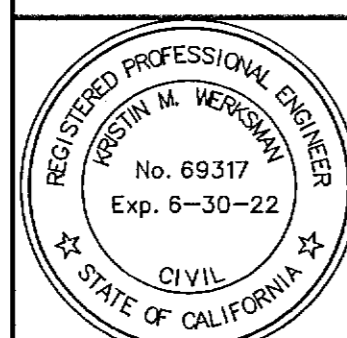

PREPARED UNDER THE DIRECTION OF

Kristin M. Werkman 1/26/21  
KRISTIN M WERKSMAN DATE  
REGISTERED CIVIL ENGINEER NO. 69317

**RICK ENGINEERING COMPANY**  
1770 IOWA AVENUE - SUITE 100  
RIVERSIDE, CA 92507  
951.782.0707  
(PAX)951.782.0723  
rickengineering.com  
San Diego - Chicago - San Luis Obispo - Bakersfield - Sacramento - Phoenix - Tucson

CITY BUSINESS TAX CERTIFICATE NO. 35225 EXP. DATE 7/31/21

BENCH MARK: CITY OF RIVERSIDE BRASS DISK STAMPED "602-4-69" ELEV. 805.43, IN A CONCRETE POST 81.6 FEET NORTH OF THE CENTERLINE OF DEWEY AVENUE; 4.5 FEET WEST OF THE CENTERLINE OF ARCH WAY PRODUCE; 58 FEET NORTHWEST OF POWER POLE #464609-H, 33.7 FEET NORTH OF THE RAIL OF THE U.P. RAILROAD, 2.5 FEET SOUTH OF A 5 FOOT CINDERBLOCK WALL, 2.5 FEET NORTHWEST OF A WOODEN GUARD POST AND 2 FEET LOWER THAN THE TRACK. DATUM NAVD 88

| MARK        | BY | DATE     | REVISIONS               | APPR       | DATE  |
|-------------|----|----------|-------------------------|------------|-------|
| REC         | MM | 9/9/20   | REVISED STREET STRIPING |            |       |
| DESIGNED BY | MM | DRAWN BY | MM                      | CHECKED BY | KW/JB |

**CITY OF RIVERSIDE, CALIFORNIA**  
PUBLIC WORKS DEPARTMENT

|                     |         |
|---------------------|---------|
| APPROVED BY         | DATE    |
| ENGINEERING MANAGER |         |
| TRAFFIC DIVISION    | NM 1/28 |
| PRINCIPAL ENGINEER  | SC 2/10 |

APPROVED BY: Gilbert M. Hernandez  
CITY ENGINEER - GILBERT M. HERNANDEZ  
DATE: 2/1/2021

|                                     |              |
|-------------------------------------|--------------|
| SIGNING & STRIPING PLAN             | PW18-0620    |
| PALM AVENUE<br>10+82.75 TO 11+99.38 | XL-787       |
| SCALE<br>HORIZ: 1"=20'              | SHEET 1 OF 1 |
| VERT: NONE                          | FILE NO.     |

# IN THE CITY OF RIVERSIDE, CALIFORNIA

# SIGNING & STRIPING PLAN

## PALM AVE 10+50.37 TO 11+99.38

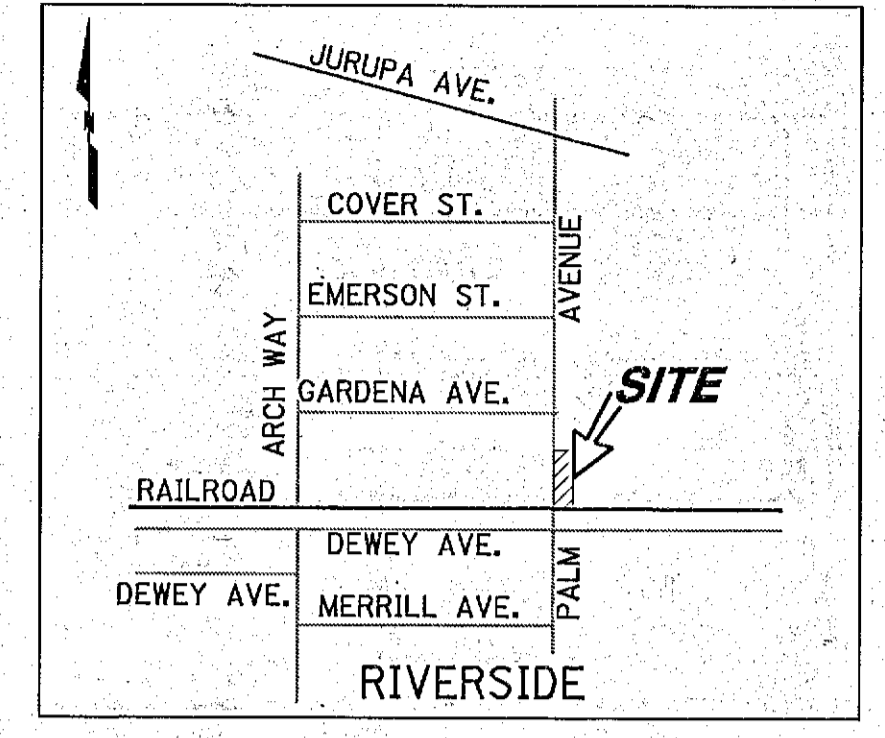

VICINITY MAP  
NOT TO SCALE

### GENERAL NOTES

1. NO PERSON SHALL PERFORM ANY CONSTRUCTION ACTIVITY OR INSTALL ANY OBJECTS WITHIN THE PUBLIC RIGHTS-OF-WAY OR EASEMENTS OF THE CITY OF RIVERSIDE WITHOUT A VALID CONSTRUCTION PERMIT OR, A STREET OPENING PERMIT OR AN ENCROACHMENT PERMIT ISSUED BY THE CITY'S PUBLIC WORKS DEPARTMENT.
2. IT SHALL BE THE RESPONSIBILITY OF THE CONTRACTOR TO CLEAR THE RIGHT-OF-WAY IN ACCORDANCE WITH THE PROVISIONS OF LAW AS IT AFFECTS EACH UTILITY INCLUDING IRRIGATION LINES AND APPURTENANCES AND AT NO COST TO THE CITY.
3. CONSTRUCTION SHALL BE IN ACCORDANCE WITH THE CITY OF RIVERSIDE PUBLIC UTILITIES DEPARTMENT WATER DIVISION, STANDARD DRAWINGS, ITS SUPPLEMENTAL NOTES, THE NFPA 24 STANDARDS AND THE STANDARD SPECIFICATIONS FOR PUBLIC WORKS CONSTRUCTION, CURRENT EDITION.
4. THE PRIVATE ENGINEER SIGNING THESE PLANS IS RESPONSIBLE FOR ASSURING THE ACCURACY AND ACCEPTABILITY OF THE WORK HEREON. IN THE EVENT OF DISCREPANCIES ARISING DURING CONSTRUCTION, THE PRIVATE ENGINEER SHALL BE RESPONSIBLE FOR DETERMINING AN ACCEPTABLE SOLUTION AND REVISING THE PLANS FOR APPROVAL BY THE CITY.
5. QUANTITIES SHOWN ARE FOR INFORMATION ONLY AND THE CITY OF RIVERSIDE IS NOT RESPONSIBLE FOR THEIR ACCURACY.
6. ALL FLAGGED ELEVATIONS SHALL BE STAKED IN THE FIELD BY THE PRIVATE ENGINEER.
7. THE CONTRACTOR SHALL CALL IN A LOCATION REQUEST TO UNDERGROUND SERVICE ALERT (USA), PHONE # 811, TWO WORKING DAYS BEFORE DIGGING. NO CONSTRUCTION PERMIT WILL BE ISSUED BY THE PUBLIC WORKS DEPARTMENT INVOLVING EXCAVATION FOR UNDERGROUND FACILITIES UNLESS THE APPLICANT HAS BEEN PROVIDED AN INQUIRY IDENTIFICATION NUMBER BY U.S.A.
8. CONTRACTOR IS TO VERIFY EXISTING UTILITY LOCATIONS AND ELEVATIONS PRIOR TO START OF CONSTRUCTION.
9. ALL TRAFFIC SIGNS SHALL BE INSTALLED PRIOR TO OPENING THE STREETS TO TRAFFIC.
10. ANY TRAFFIC CONTROL STRIPING OBLITERATED AND/OR BADLY WORN DURING CONSTRUCTION SHALL BE RESTORED BY CONTRACTOR WITHIN FIVE DAYS AFTER NOTIFICATION FROM THE CITY INSPECTORS.
11. FINAL STRIPING FOR TRAFFIC CONTROL AND/OR PAVEMENT MARKING TO BE THE RESPONSIBILITY OF THE DEVELOPER.

### GENERAL SIGNING AND STRIPING NOTES

1. SIGNING AND STRIPING INSTALLATIONS SHALL CONFORM TO THE CALIFORNIA MANUAL ON UNIFORM TRAFFIC CONTROL DEVICES (CA MUTCD), THE STATE OF CALIFORNIA DEPARTMENT OF TRANSPORTATION (CALTRANS) STANDARD PLANS AND SPECIFICATIONS DATED 2018, AND ALL ADDENDUMS THERE TO, AND THE CITY OF RIVERSIDE PUBLIC WORKS DEPARTMENT STANDARD DRAWINGS, CURRENT EDITION.
2. ALL STRIPING, MARKINGS, AND LEGENDS SHALL BE REFLECTORIZED THERMOPLASTIC UNLESS OTHERWISE NOTED. THE CONTRACTOR SHALL PROVIDE AND INSTALL RAISED PAVEMENT MARKERS FOR ALL STRIPING, STRIPING, MARKINGS AND LEGENDS SHALL CONFORM TO THE LATEST CALTRANS STANDARD PLANS A20A THRU A20D AND A24A THRU A24E.
3. PRIOR TO FINAL ACCEPTANCE OF STREET IMPROVEMENTS, ALL PAVEMENT STRIPING AND STENCILING WITHIN THE PERIMETER OF THE CONSTRUCTION AREA SHALL BE RESTORED TO LIKE NEW CONDITION, IN A MANNER MEETING THE APPROVAL OF THE CITY OF RIVERSIDE.
4. THE CONTRACTOR SHALL RE-STRIP EXISTING STRIPING AND CURB MARKINGS OBLITERATED BY NEW CONSTRUCTION, WHETHER OR NOT SHOWN ON THE PLANS FOR REPLACEMENT, AT NO COST TO THE CITY.
5. AT LOCATIONS WHERE EXISTING PAINTED CURB IS TO BE RECONSTRUCTED, THE CONTRACTOR SHALL PAINT THE NEW CURB AS SHOWN ON THE PLANS WITHIN 10 WORKING DAYS OF CURB CONSTRUCTION OR AS DIRECTED BY ENGINEER. THE PAINT SHALL BE WATER-BASED WITH 2-YEAR GUARANTEE AGAINST COLOR FADING. PRIOR TO THE START OF CONSTRUCTION, THE CONTRACTOR SHALL SUBMIT TO THE CITY WRITTEN PROOF OF THE MANUFACTURER'S 2-YEAR GUARANTEE.
6. ALL NEW STRIPING SHALL BE "CAT TRACKED" AND APPROVED BY THE ENGINEER PRIOR TO FINAL INSTALLATION. THE CONTRACTOR SHALL NOTIFY THE ENGINEER AFTER COMPLETING LAYOUT AND AT LEAST 3 WORKING DAYS BEFORE COMMENCING INSTALLATION OF STRIPING, MARKINGS AND MARKERS.
7. TRAFFIC SIGN FACE SHALL BE 3M DIAMOND GRADE D03 REFLECTIVE SHEETING (ASTM XI) OR APPROVED EQUAL WITH PROTECTIVE GRAFFITI OVERLAY FILM OR AS OTHERWISE NOTED. ALL WARNING SIGNS SHALL HAVE A FLUORESCENT YELLOW BACKGROUND AND SCHOOL SIGNS NOTED SHALL HAVE A FLUORESCENT YELLOW-GREEN BACKGROUND.
8. SIGNS SHALL BE STANDARD SIZE UNLESS NOTED OTHERWISE. PRIOR TO INSTALLATION, NEW SIGNS SHALL BE APPROVED BY THE CITY OF RIVERSIDE. EXACT LOCATIONS OF SIGNS SHALL BE DETERMINED BY THE CITY ENGINEER.
9. ALL EXISTING SIGNS AND SIGN POSTS TO BE REMOVED SHALL BE DELIVERED TO THE CITY OF RIVERSIDE SIGN DEPARTMENT.
10. WHEN PAINT IS SPECIFIED, TRAFFIC STRIPES AND MARKINGS SHALL BE APPLIED IN TWO COATS. A MINIMUM OF SEVEN DAYS SHALL BE PROVIDED BETWEEN FIRST AND SECOND COATS.
11. STRIPING SHALL BE APPLIED WITHIN 48 HOURS OF SURFACE COURSE REPLACEMENT ON STREETS OPEN TO THE PUBLIC. IN NO CASE SHALL A NEWLY PAVED STREET OPEN TO THE PUBLIC BE LEFT UNSTRIPED OVER A WEEKEND OR HOLIDAY.
12. CONTRACTOR SHALL INSTALL NEW SIGN(S) AND/OR POST(S) PER CITY OF RIVERSIDE STANDARD DRAWING NO. 664, SEE SPECIFICATIONS.
13. ALL CONFLICTING STRIPING, PAVEMENT MARKINGS, LEGENDS, AND RAISED PAVEMENT MARKERS SHALL BE REMOVED EVEN IF NOT SHOWN ON PLANS. REMOVALS OF PAINTED STRIPING, PAVEMENT MARKINGS AND LEGENDS SHALL BE DONE BY WET SANDBLASTING. REMOVALS OF THERMOPLASTIC STRIPING, PAVEMENT MARKINGS AND LEGENDS SHALL BE REMOVED BY WET SANDBLASTING, GRINDING OR OTHER APPROVED METHOD AND SHALL NOT DAMAGE THE PAVEMENT. "BLACK OUT" OF EXISTING DELINEATION IS NOT PERMITTED. ALL DAMAGED PAVEMENT DUE TO REMOVALS SHALL BE REPAIRED AS NECESSARY TO MAINTAIN A SMOOTH AND UNIFORM SURFACE OR AS DIRECTED BY THE ENGINEER. ALL STRIPING REMOVALS AND LEGENDS SHALL BE "FOG SEALED".
14. WHERE APPLICABLE, OUTBOUND LANE LINE DETAILS SHALL COMMENCE AT THE LIMIT LINE, MEANING THE PAINTED PORTION OF THE DETAIL SHALL JOIN THE LIMIT LINE.

### CONSTRUCTION NOTES AND QUANTITIES ESTIMATES

|  |        |
|--|--------|
| 1. SANDBLAST ALL EXISTING CONFLICTING TRAFFIC STRIPING AND MARKINGS, INCLUDING RAISED PAVEMENT MARKERS. CONTRACTOR SHALL FOG SEAL STRIPING REMOVALS. | 1 LS   |
| 2. INSTALL TYPE IV (R) ARROW PER FIGURE A24A OF CALTRANS STANDARD PLANS 2018   | 2 EA   |
| 3. INSTALL TYPE IV (L) ARROW PER FIGURE A24A OF CALTRANS STANDARD PLANS 2018   | 2 EA   |
| 4. INSTALL 6" DASHED YELLOW STRIPE PER DETAIL 1 OF CALTRANS STANDARD PLANS 2018  | 30 LF  |
| 5. INSTALL 6" SOLID DOUBLE YELLOW STRIPE PER DETAIL 22 OF CALTRANS STANDARD PLANS 2018   | 115 LF |
| 6. INSTALL 8" SOLID WHITE CHANNELIZING STRIPE PER DETAIL 38 OF CALTRANS STANDARD PLANS 2018  | 268 LF |
| 7. INSTALL THERMOPLASTIC 24" SOLID WHITE LIMIT LINE MARKING  | 24 LF  |
| 8. INSTALL 6" SOLID WHITE RIGHT EDGE LINE PER DETAIL 27B OF CALTRANS STANDARD PLANS 2018   | 110 LF |
| 9. INSTALL 6" WHITE DASHED LANE LINE EXTENSION THROUGH INTERSECTION PER DETAIL 27C OF CALTRANS STANDARD PLANS 2018                                   | 90 LF  |
| 10. INSTALL 6" YELLOW DASHED CENTERLINE EXTENSION THROUGH INTERSECTION PER DETAIL 41 OF CALTRANS STANDARD PLANS 2018                                 | 45 LF  |
| 11. INSTALL TYPE I ARROW PER FIGURE A24A OF CALTRANS STANDARD PLANS 2018   | 1 EA   |
| 12. INSTALL 4" SOLID DOUBLE YELLOW STRIPE PER DETAIL 22 OF CALTRANS STANDARD PLANS 2018  | 55 LF  |
| 13. INSTALL "RIGHT TURN" SIGN R3-7(R) PER CA MUTCD.  | 1 EA   |
| 14. INSTALL SIGN POST PER CITY OF RIVERSIDE STD. #664.   | 1 EA   |
| 15. INSTALL 8" SOLID WHITE CHEVRON CROSS HATCH MARKINGS AT 20' SPACING.  | 22 LF  |
| 16. INSTALL PAINTED RED CURB BETWEEN D/W AND LIMIT LINE.   | 64 LF  |

### WORK TO BE DONE

THESE IMPROVEMENTS CONSIST OF THE FOLLOWING WORK TO BE DONE ACCORDING TO THESE PLANS, THE CURRENT CITY OF RIVERSIDE STANDARDS AND SPECIFICATIONS, AND THE LATEST EDITION OF THE STANDARD SPECIFICATIONS FOR PUBLIC WORK CONSTRUCTION ("GREEN BOOK"), CALTRANS STANDARD PLANS (2018 EDITION); AND 2014 CA MUTCD.

### PRIVATE ENGINEER'S NOTE TO CONTRACTOR

ALL CONTRACTORS AND SUBCONTRACTORS PERFORMING WORK SHOWN ON OR RELATED TO THESE PLANS SHALL CONDUCT THEIR OPERATIONS SO THAT ALL EMPLOYEES ARE PROVIDED A SAFE PLACE TO WORK AND THE PUBLIC IS PROTECTED. ALL CONTRACTORS AND SUBCONTRACTORS SHALL COMPLY WITH THE OCCUPATIONAL SAFETY AND HEALTH REGULATIONS OF THE U.S. DEPARTMENT OF LABOR AND THE STATE OF CALIFORNIA DEPARTMENT OF INDUSTRIAL RELATIONS CONSTRUCTION SAFETY ORDERS. THE CIVIL ENGINEER SHALL NOT BE RESPONSIBLE IN ANY WAY FOR THE CONTRACTOR'S AND SUBCONTRACTOR'S COMPLIANCE WITH SAID REGULATIONS AND ORDERS.

CONTRACTOR FURTHER AGREES THAT HE SHALL ASSUME SOLE AND COMPLETE RESPONSIBILITY FOR JOB-SITE CONDITIONS DURING THE COURSE OF CONSTRUCTION OF THIS PROJECT, INCLUDING SAFETY OF ALL PERSONS AND PROPERTY, THAT THIS REQUIREMENT SHALL APPLY CONTINUOUSLY AND NOT BE LIMITED TO NORMAL WORKING HOURS, AND THAT THE CONTRACTOR SHALL DEFEND, INDEMNIFY AND HOLD THE OWNER AND CIVIL ENGINEER HARMLESS FROM ANY AND ALL LIABILITY, REAL OR ALLEGED, IN CONNECTION WITH THE PERFORMANCE OF WORK ON THIS PROJECT, EXCEPTION FOR LIABILITY ARISING FROM THE SOLE NEGLIGENCE OF THE OWNER OR ENGINEER.

THE EXISTENCE AND APPROXIMATE LOCATIONS OF ANY UNDERGROUND UTILITIES OR STRUCTURES SHOWN ON THESE PLANS ARE OBTAINED BY A SEARCH OF THE AVAILABLE RECORDS. THE CIVIL ENGINEER ASSUMES NO LIABILITY AS TO THE EXACT LOCATION OF SAID LINES NOR FOR UTILITY OR IRRIGATION LINES WHOSE LOCATIONS ARE NOT SHOWN. THE CONTRACTOR SHALL BE RESPONSIBLE FOR NOTIFYING ALL UTILITY AND IRRIGATION COMPANIES PRIOR TO WORK OR EXCAVATION TO DETERMINE THE EXACT LOCATIONS OF ALL LINES AFFECTING THIS WORK, WHETHER OR NOT SHOWN HERE ON, AND FOR ANY DAMAGE OR PROTECTION TO THESE LINES.

### NOTICE TO CONTRACTOR

THE EXISTENCE AND LOCATIONS OF ALL UNDERGROUND UTILITIES (UTILITY PIPES, STRUCTURES, ETC.) SHOWN ON THESE PLANS (MAIN LINES ONLY - NO SERVICE LATERALS) WERE ASCERTAINED BY A REVIEW OF RECORDS PROVIDED BY THESE MEMBER AGENCIES AND ARE APPROXIMATE. NEITHER THE OWNER NOR THE ENGINEER ASSUMES ANY RESPONSIBILITY FOR UTILITIES NOT SHOWN OR NOT IN THE LOCATION SHOWN. THE CONTRACTOR IS REQUIRED TO TAKE DUE PRECAUTIONARY MEASURES TO PROTECT THE UTILITY LINES SHOWN AND ANY OTHER LINES NOT OF RECORD OR NOT SHOWN ON THESE PLANS. LOCATIONS OF UTILITIES SHALL BE VERIFIED BY THE CONTRACTOR PRIOR TO COMMENCEMENT OF CONSTRUCTION. CALL UNDERGROUND SERVICE ALERT (U.S.A.) 811 AT LEAST 2 WORKING DAYS PRIOR TO COMMENCEMENT OF CONSTRUCTION.

### ENGINEER'S NOTES

PRIVATE ENGINEER WILL NOT BE PROVIDING INSPECTION SERVICES OR CONSTRUCTION REVIEW. THESE FUNCTIONS ARE THE RESPONSIBILITY OF THE CITY AND/OR THE GENERAL CONTRACTOR. ENGINEER ACCEPTS NO LIABILITY FOR SUCH FUNCTIONS OR WORK THEREOF.

### DECLARATION OF RESPONSIBLE CHARGE

I HEREBY DECLARE THAT I AM THE ENGINEER OF WORK FOR THIS PROJECT, THAT I HAVE EXERCISED RESPONSIBLE CHARGE OVER THE PROJECT AS DEFINED IN SECTION 6703 OF THE BUSINESS AND PROFESSIONS CODE, AND THAT THE DESIGN IS CONSISTENT WITH THE CURRENT STANDARD. I UNDERSTAND THAT THE CHECK OF THE PROJECT DRAWINGS AND SPECIFICATIONS BY THE CITY OF RIVERSIDE IS CONFINED TO A REVIEW ONLY AND DOES NOT RELIEVE ME, AS ENGINEER OF WORK, OF MY RESPONSIBILITIES FOR PROJECT DESIGN.

RICK ENGINEERING COMPANY  
1770 IOWA AVENUE, SUITE 100  
RIVERSIDE, CA 92507

By: Gusti M. Wellman DATED: 12/17/2019  
KRISTIN M. WERKSMAN R.C.E. 69317

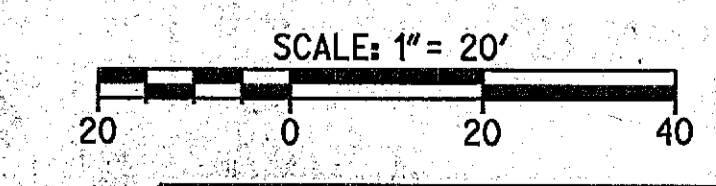
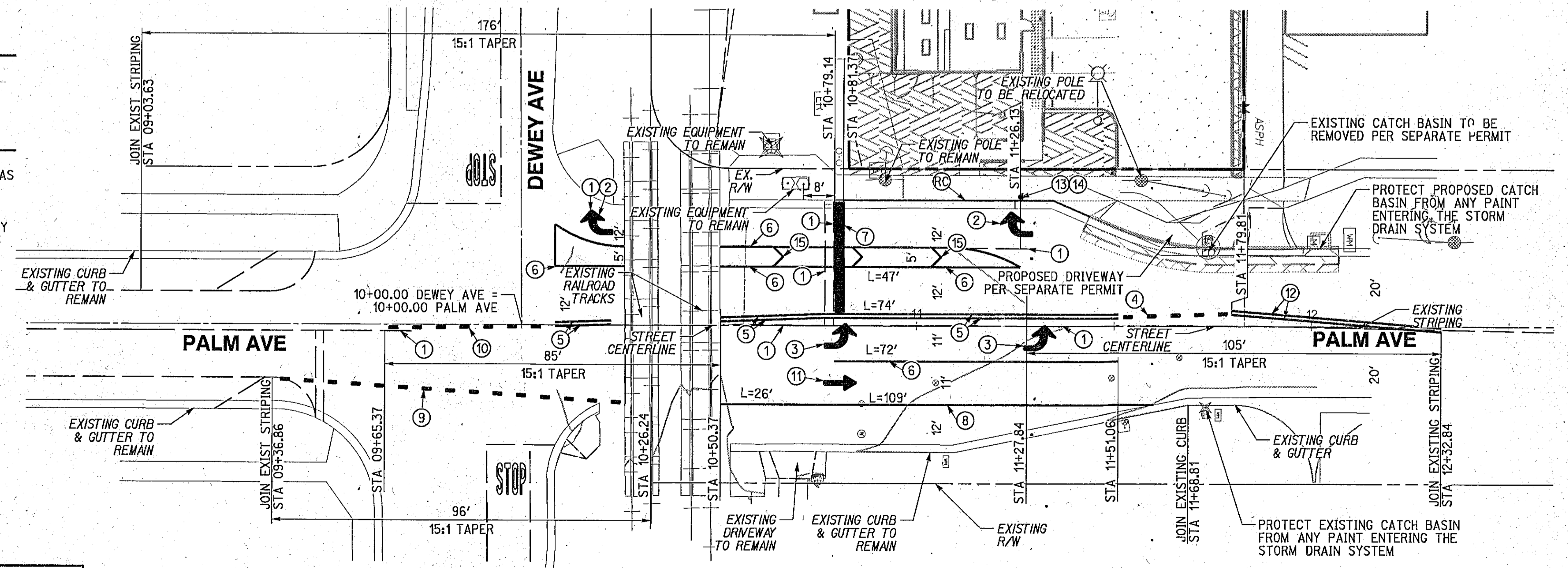

**CAUTION:**  
EXACT LOCATION OF EXISTING UNDERGROUND FACILITIES IS UNKNOWN. CONTRACTOR TO VERIFY IN FIELD.

**Know what's below.**  
Call what you dig.

Call at least 2 working days prior to excavating.

REGISTERED PROFESSIONAL ENGINEER

KRISTIN M. WERKSMAN

No. 69317

Exp. 6-30-20

CIVIL

STATE OF CALIFORNIA

PREPARED UNDER THE DIRECTION OF

Gusti M. Wellman 12/17/2019

KRISTIN M. WERKSMAN DATE

REGISTERED CIVIL ENGINEER NO. 59317

**RICK ENGINEERING COMPANY**

1770 IOWA AVENUE - SUITE 100  
RIVERSIDE, CA 92507  
951.782.0707  
(PAX) 951.782.0723

San Diego - Chicago - San Luis Obispo - Bakersfield - Sacramento - Phoenix - Tucson

www.rickengineering.com

CITY BUSINESS TAX CERTIFICATE NO. 35225 EXP. DATE 7/31/20

BENCH MARK: CITY OF RIVERSIDE BRASS DISK STAMPED "602-4-59" ELEV. 805.43, IN A CONCRETE POST 81.5 FEET NORTH OF THE CENTERLINE OF DEWEY AVENUE, 4.5 FEET WEST OF THE CENTERLINE OF ARCH WAY PRODUCED 54 FEET NORTHWEST OF POWER POLE #464609-1, 33.7 FEET NORTH OF THE RAIL OF THE U.P. RAILROAD, 2.5 FEET SOUTH OF A 5 FEET CONCRETE WALL, 2.5 FEET NORTHWEST OF A WOODEN GUARD POST AND 2 FEET LOWER THAN THE TRACK DATUM NAVD 83

| MARK | BY | DATE | REVISIONS | APPR | DATE |
|------|----|------|-----------|------|------|
|      |    |      |           |      |      |
|      |    |      |           |      |      |
|      |    |      |           |      |      |
|      |    |      |           |      |      |

DESIGNED BY: MM DRAWN BY: MM CHECKED BY: KW/JB

**CITY OF RIVERSIDE, CALIFORNIA**  
PUBLIC WORKS DEPARTMENT

|                     |    |         |
|---------------------|----|---------|
| APPROVED BY         | BY | DATE    |
| ENGINEERING MANAGER | CP | 2/13/20 |
| TRAFFIC DIVISION    | JM | 2/13/20 |
| PRINCIPAL ENGINEER  |    |         |

APPROVED BY: [Signature]

CITY ENGINEER

DATE: FEBRUARY 13, 2020

SIGNING & STRIPING PLAN

PALM AVENUE  
10+50.37 TO 11+99.38

SCALE: HORIZ: 1"=20' VERT: NONE

FILE NO.

PW18-0620

XL-787

SHEET 1 OF 1

PLAT DATE: 11-DEC-2019 JUN 17972A