

SIGNING AND STRIPING GENERAL NOTES:

- SIGNING AND STRIPING INSTALLATIONS SHALL CONFORM TO THE CALIFORNIA MANUAL ON UNIFORM TRAFFIC CONTROL DEVICES (2012 CA MUTCD), THE STATE OF CALIFORNIA DEPARTMENT OF TRANSPORTATION (CALTRANS) STANDARD PLANS AND SPECIFICATIONS DATED 2010, AND ALL ADDENDUMS THERETO, AND THE CITY OF RIVERSIDE PUBLIC WORKS DEPARTMENT STANDARD DRAWINGS, CURRENT EDITION.
- ALL STRIPING, MARKINGS, AND LEGENDS SHALL BE REFLECTORIZED THERMOPLASTIC UNLESS OTHERWISE NOTED. THE CONTRACTOR SHALL PROVIDE AND INSTALL RAISED PAVEMENT MARKERS FOR ALL STRIPINGS, STRIPINGS, MARKINGS AND LEGENDS SHALL CONFORM TO THE LATEST CALTRANS STANDARD PLANS A20A THRU A20D AND A24A THRU A24E.
- PRIOR TO FINAL ACCEPTANCE OF STREET IMPROVEMENTS, ALL PAVEMENT STRIPING AND STENCILING WITHIN THE PERIMETER OF THE CONSTRUCTION AREA SHALL BE RESTORED TO LIKE NEW CONDITION, IN A MANNER MEETING THE APPROVAL OF THE CITY OF RIVERSIDE.
- THE CONTRACTOR SHALL RE-STRIPE EXISTING STRIPING AND CURB MARKINGS OBLITERATED BY NEW CONSTRUCTION, WHETHER OR NOT SHOWN ON THE PLANS FOR REPLACEMENT, AT NO COST TO THE CITY.
- AT LOCATIONS WHERE EXISTING PAINTED CURB IS TO BE RECONSTRUCTED, THE CONTRACTOR SHALL PAINT THE NEW CURB AS SHOWN ON THE PLANS WITHIN 10 WORKING DAYS OF CURB CONSTRUCTION OR AS DIRECTED BY ENGINEER. THE PAINT SHALL BE WATER-BASED WITH 2-YEAR GUARANTEE AGAINST COLOR FADING. PRIOR TO THE START OF CONSTRUCTION, THE CONTRACTOR SHALL SUBMIT TO THE CITY WRITTEN PROOF OF THE MANUFACTURER'S 2-YEAR GUARANTEE.
- ALL NEW STRIPING SHALL BE "CAT TRACKED" AND APPROVED BY THE ENGINEER PRIOR TO FINAL INSTALLATION. THE CONTRACTOR SHALL NOTIFY THE ENGINEER AFTER COMPLETING LAYOUT AND AT LEAST 3 WORKING DAYS BEFORE COMMENCING INSTALLATION OF STRIPING, MARKINGS AND MARKERS.
- TRAFFIC SIGN FACE SHALL BE 3M DIAMOND GRADE DG3 REFLECTIVE SHEETING (ASTM XI) OR APPROVED EQUAL WITH PROTECTIVE GRAFFITI OVERLAY FILM OR AS OTHERWISE NOTED. ALL WARNING SIGNS SHALL HAVE A FLUORESCENT YELLOW BACKGROUND AND SCHOOL SIGNS NOTED SHALL HAVE A FLUORESCENT YELLOW-GREEN BACKGROUND.
- SIGNS SHALL BE STANDARD SIZE UNLESS NOTED OTHERWISE. PRIOR TO INSTALLATION, NEW SIGNS SHALL BE APPROVED BY THE CITY OF RIVERSIDE. EXACT LOCATIONS OF SIGNS SHALL BE DETERMINED BY THE CITY ENGINEER.
- SALVAGED SIGNS AND SIGN POSTS SHALL BE DELIVERED TO THE CITY OF RIVERSIDE SIGN DEPARTMENT.
- WHEN PAINT IS SPECIFIED, TRAFFIC STRIPES AND MARKINGS SHALL BE APPLIED IN TWO COATS. A MINIMUM OF SEVEN DAYS SHALL BE PROVIDED BETWEEN FIRST AND SECOND COATS.
- STRIPING SHALL BE APPLIED WITHIN 48 HOURS OF SURFACE COURSE REPLACEMENT ON STREETS OPEN TO THE PUBLIC. IN NO CASE SHALL A NEWLY PAVED STREET OPEN TO THE PUBLIC BE LEFT UNSTRIPED OVER A WEEKEND OR HOLIDAY.
- CONTRACTOR SHALL INSTALL NEW SIGN(S) AND/OR POST(S) PER CITY OF RIVERSIDE STANDARD DRAWING No. 664, SEE SPECIFICATIONS.
- CONTRACTOR SHALL INSTALL NEW STREET NAME SIGNS AND POST PER CITY OF RIVERSIDE STANDARD DRAWING No. 662, SEE SPECIFICATIONS.
- ALL CONFLICTING STRIPING, PAVEMENT MARKINGS, LEGENDS, AND RAISED PAVEMENT MARKERS SHALL BE REMOVED EVEN IF NOT SHOWN ON PLANS. REMOVALS OF PAINTED STRIPING, PAVEMENT MARKINGS AND LEGENDS SHALL BE DONE BY WET SANDBLASTING. REMOVALS OF THERMOPLASTIC STRIPING, PAVEMENT MARKINGS AND LEGENDS SHALL BE REMOVED BY WET SANDBLASTING, GRINDING OR OTHER APPROVED METHOD AND SHALL NOT DAMAGE THE PAVEMENT. "BLACK OUT" OF EXISTING DELINEATION IS NOT PERMITTED. ALL DAMAGED PAVEMENT DUE TO REMOVALS SHALL BE REPAIRED AS NECESSARY TO MAINTAIN A SMOOTH AND UNIFORM SURFACE OR AS DIRECTED BY THE ENGINEER. ALL STRIPING REMOVALS AND LEGENDS SHALL BE "FOG SEALED".
- WHERE APPLICABLE, OUTBOUND LANE LINE DETAILS SHALL COMMENCE AT THE CROSSWALK, MEANING THE PAINTED PORTION OF THE DETAIL SHALL JOIN THE CROSSWALK.

SIGNING AND STRIPING LEGEND AND CONSTRUCTION NOTES:

- E EXISTING TO REMAIN.
- PM INSTALL PAVEMENT MARKING OR ARROW AS NOTED.
- RP REMOVE ALL EXISTING CONFLICTING TRAFFIC STRIPING AND MARKINGS AS NOTED BY SANDBLAST METHOD, INCLUDING RAISED PAVEMENT MARKERS.
- RL RELOCATE EXISTING SIGN(S), INSTALL POST IF APPLICABLE
- # INSTALL CALTRANS STRIPING DETAIL PER NUMBER NOTED, INCLUDING INSTALLATION OF RAISED PAVEMENT MARKERS.
- IS FURNISH AND INSTALL SIGN AND POST
- S EXISTING SIGNALIZED INTERSECTION
- P PROPOSED SIGN (ONE POST)
- P EXISTING SIGN (ONE POST)
- P EXISTING SIGN (ON STREET LIGHT)
- (12')
- 12'

STRIPING/SIGNAGE QUANTITIES					
ITEM	DESCRIPTION	UNIT	SHEET 1	SHEET 2	TOTAL
1	DETAIL 12	LF	50	1660	1710
2	DETAIL 27B	LF	800	-	800
3	**DETAIL 38	LF	-	600	600
4	DETAIL 39	LF	850	870	1720
5	4" WHITE	LF	-	50	50
6	**12" WHITE	LF	-	80	80
7	PAVEMENT LEGENDS/MARKINGS	SF	84	14	98
8	INSTALL SIGN AND POST	EA	1	-	1
9	REMOVE SIGN AND POST	EA	-	1	1
10	RELOCATE SIGN AND POST	EA	-	1	1
11	REMOVE PAVEMENT MARKING	SF	-	126	126
12	REMOVE LANE LINE MARKING	LF	850	1190	2040

ALL PAVEMENT MARKING AND LANE LINE REMOVALS SHALL BE FOG SEALED
 ** DETAIL 38 & 12" WHITE SHALL BE PAINT (TWO COATS)

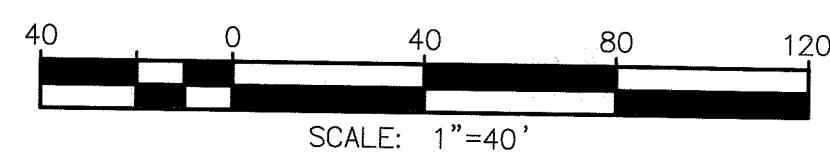
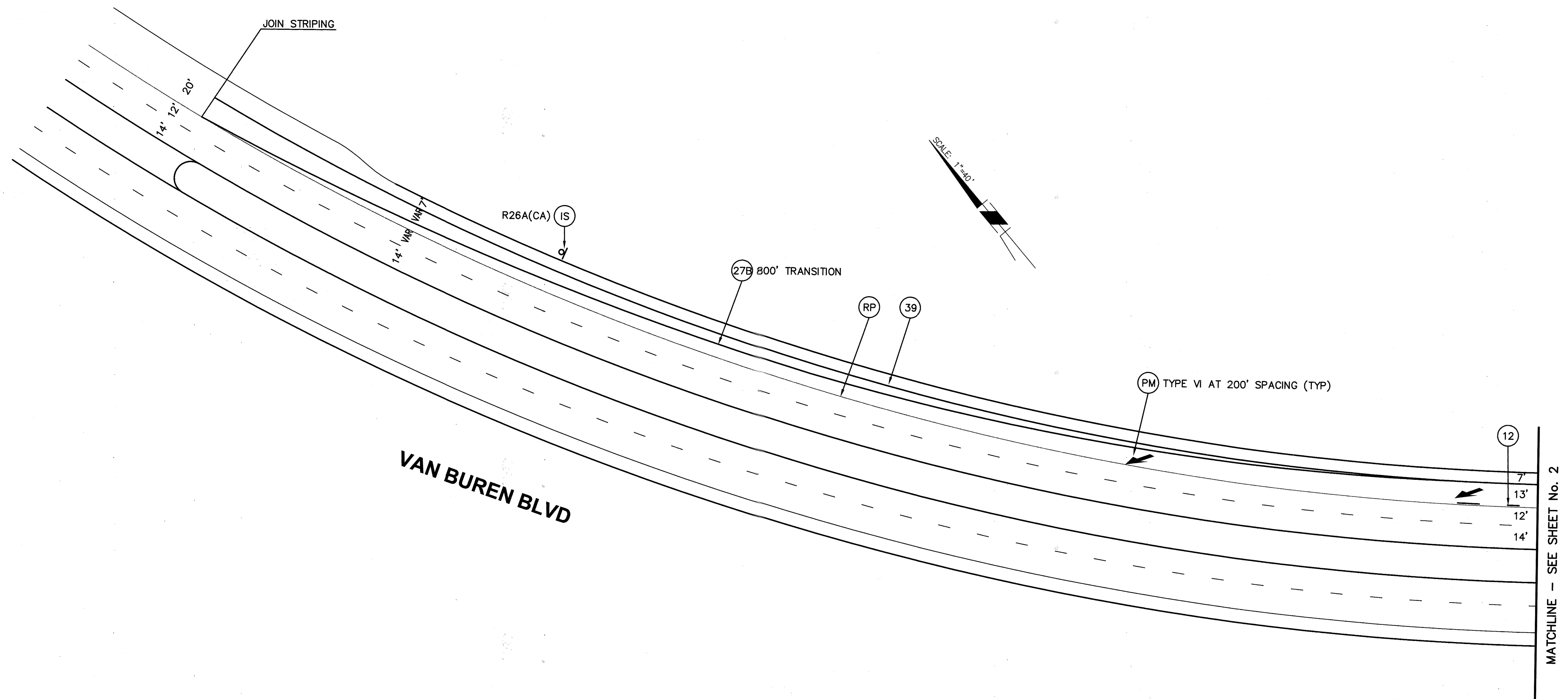
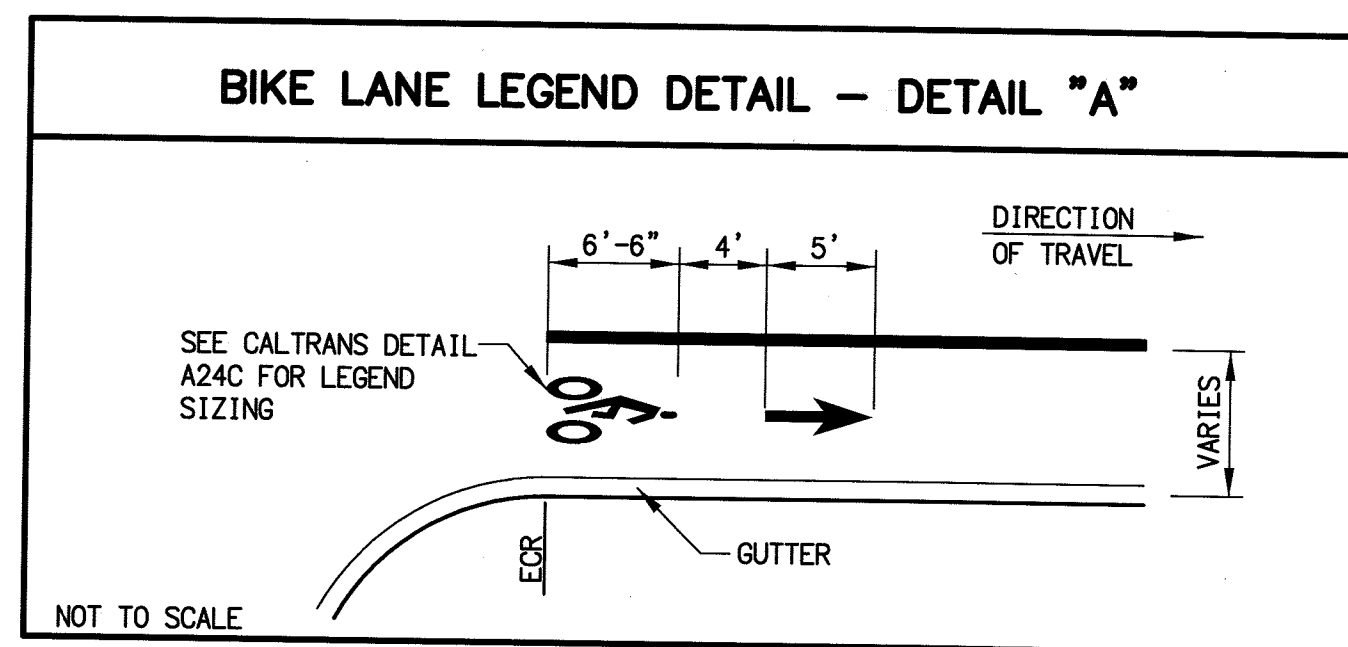

Under Ground Service Alert
 of Southern California
 Call: TOLL FREE
1-800-227-2600
 TWO WORKING DAYS BEFORE YOU DIG

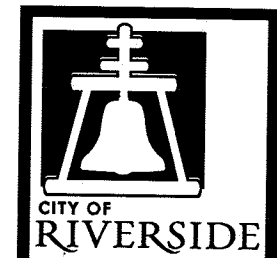

ENGINEER IN RESPONSIBLE CHARGE
 GILBERT M. HERNANDEZ
 R.C.E. No. 69170 EXPIRES: 6-30-12
 DATE: 1-21-14

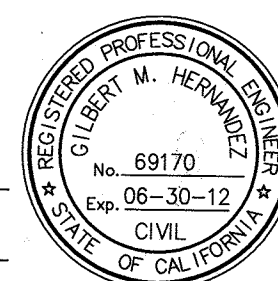

MARK	REVISIONS	APPR.	DATE

DESIGNED BY: GMH DRAWN BY: GMH CHECKED BY: GMH

CITY OF RIVERSIDE, CALIFORNIA DEPARTMENT OF PUBLIC WORKS			
APPROVED BY	BY	DATE	APPROVED BY
ENGINEERING MANAGER	F.M.	3/4/14	[Signature]
PRINCIPAL ENGINEER	D.C.	3/4/14	CITY ENGINEER
TRAFFIC DIVISION	[Signature]	3/3/14	DATE: 3/6/2014
CONSTRUCTION ADMIN.			

SIGNING AND STRIPING PLAN
VAN BUREN BOULEVARD
 FROM SANTA ANA RIVER
 TO N/O CENTRAL AVENUE

XL-714
 SHEET 1 OF 2
 FILE NAME: XL-714.DWG

MATCHLINE - SEE SHEET No. 2

MATCHLINE - SEE SHEET No. 1

MATCHLINE - SEE BELOW LEFT

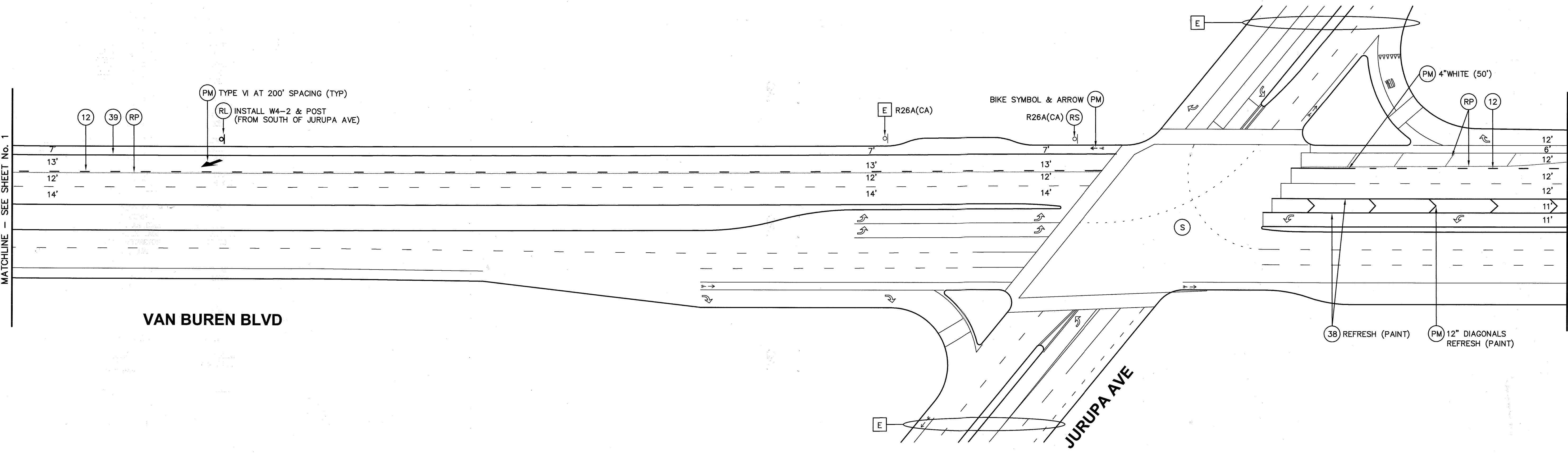

VAN BUREN BLVD

JURUPA AVE

MATCHLINE - SEE ABOVE RIGHT

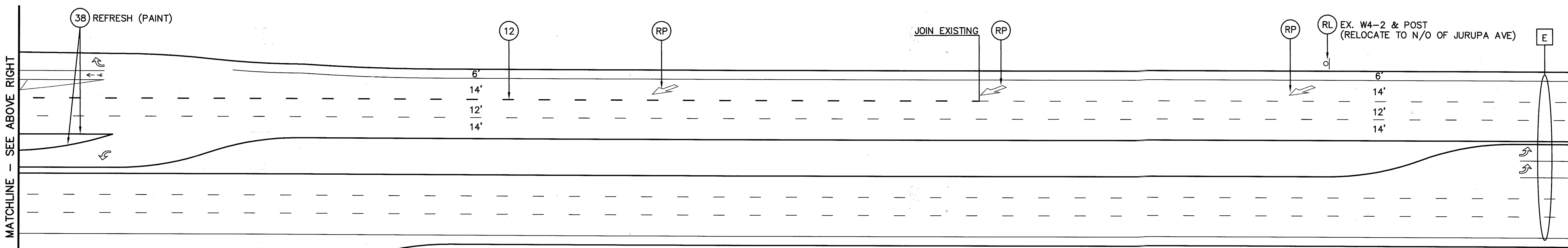

VAN BUREN BLVD

NOTE:

SEE SHEET No. 1 FOR SIGNING AND STRIPING GENERAL NOTES, CONSTRUCTION NOTES, AND QUANTITIES

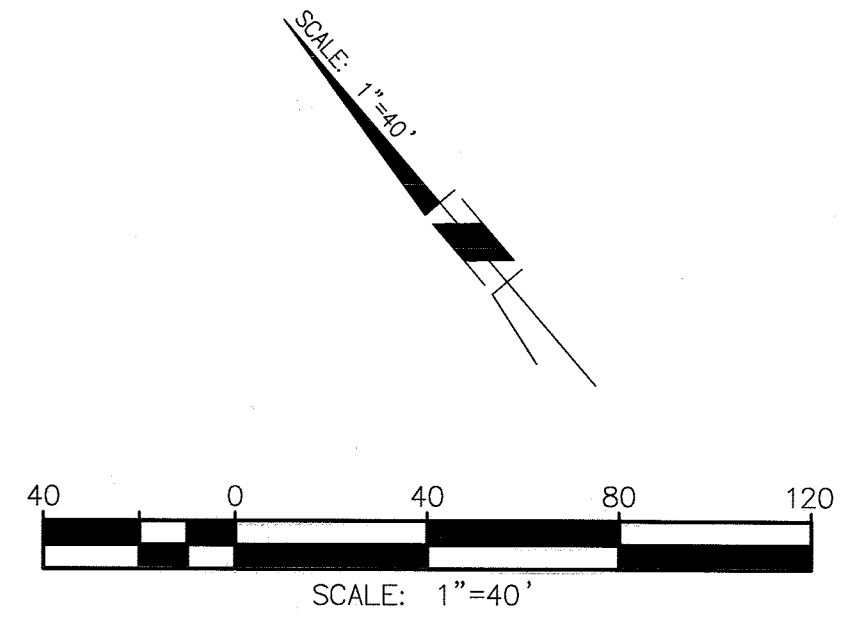

Under Ground Service Alert of Southern California
 Call: TOLL FREE 1-800-227-2600
 TWO WORKING DAYS BEFORE YOU DIG

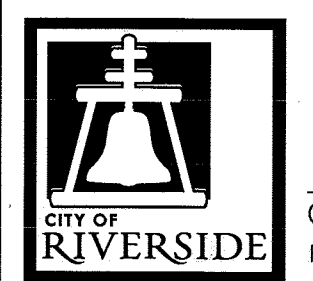

ENGINEER IN RESPONSIBLE CHARGE
 GILBERT M. HERNANDEZ
 R.C.E. No. 69170 EXPIRES: 6-30-12
 DATE 1-21-14

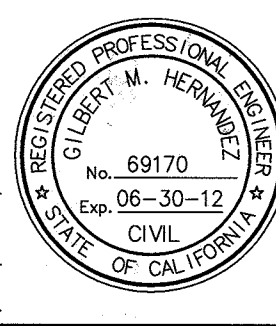

MARK	REVISIONS	APPR.	DATE

DESIGNED BY GMH DRAWN BY GMH CHECKED BY GMH

CITY OF RIVERSIDE, CALIFORNIA
 DEPARTMENT OF PUBLIC WORKS

APPROVED BY	BY	DATE	APPROVED BY
ENGINEERING MANAGER	F.M.	3/17/14	CITY ENGINEER
PRINCIPAL ENGINEER	D.C.	3/17/14	
TRAFFIC DIVISION			
CONSTRUCTION ADMIN.			

DATE 3/6/2014

SIGNING AND STRIPING PLAN
VAN BUREN BOULEVARD
FROM SANTA ANA RIVER
TO N/O CENTRAL AVENUE

SCALE: 1" = 40'

XL-714
 SHEET 2 OF 2
 FILE NAME: XL-714.DWG

STRIPING CONSTRUCTION NOTES: (BY CONTRACTOR)

- ① PAINT 4"/4" DOUBLE YELLOW STRIPE PER CALTRANS STANDARD PLANS, PLAN NO. A20A, DETAIL 22.
- ② SAND BLAST EXISTING STRIPING AS SHOWN ON PLANS.
- ③ APPLY THERMOPLASTIC 8" SOLID WHITE STRIPE PER CALTRANS STANDARD PLANS, PLAN NO. A20D, DETAIL 38.
- ④ APPLY THERMOPLASTIC TYPE IV ARROW MARKING PER CALTRANS STANDARD PLANS, PLAN NO. A24A.
- ⑤ APPLY THERMOPLASTIC 12" SOLID WHITE STRIPE PER CALTRANS STANDARD PLANS, PLAN NO. A24E.
- ⑥ INSTALL SIGNAL AHEAD SIGN (48"x48") ON 4"x6" POST WITH ANCHOR BLOCKS PER CALTRANS TRAFFIC MANUAL, CHAPTER 4.
- ⑦ REFRESH EXISTING STRIPING OR MARKING.
- ⑧ INSTALL SIGN (STANDARD SIZE OR AS INDICATED) PER CALTRANS TRAFFIC MANUAL, CHAPTER 4.
- ⑨ REMOVE AND SALVAGE EXISTING SIGN.
- ⑩ RE-PAINT 4" WHITE DASHED STRIPE PER CALTRANS STANDARD PLANS, PLAN NO. A20A, DETAIL 12.
- ⑪ PAINT 4" WHITE RIGHT EDGE STRIPE PER CALTRANS STANDARD PLANS, PLAN NO. A20B, DETAIL 27B.
- ⑫ RE-PAINT 4" WHITE RIGHT EDGE STRIPE PER CALTRANS STANDARD PLANS, PLAN NO. A20B, DETAIL 27B.
- ⑬ RE-APPLY 8" SOLID WHITE STRIPE PER CALTRANS STANDARD PLANS, PLAN NO. A20D, DETAIL 38.
- ⑭ PAINT 4" SOLID WHITE FOR 100'.
- ⑮ EXISTING SIGN, PROTECT IN PLACE.

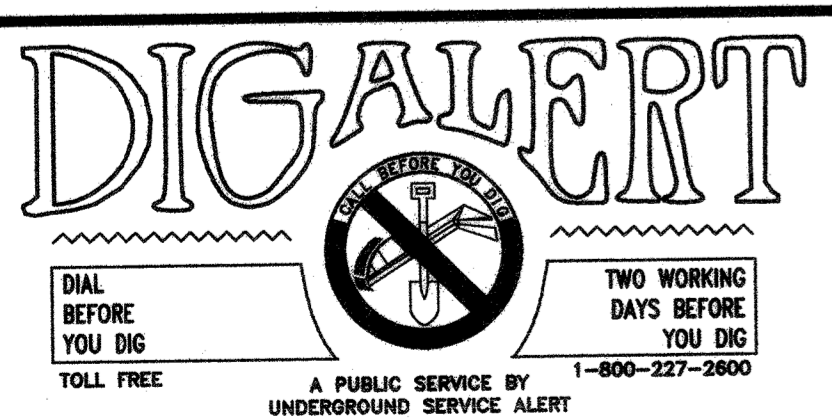
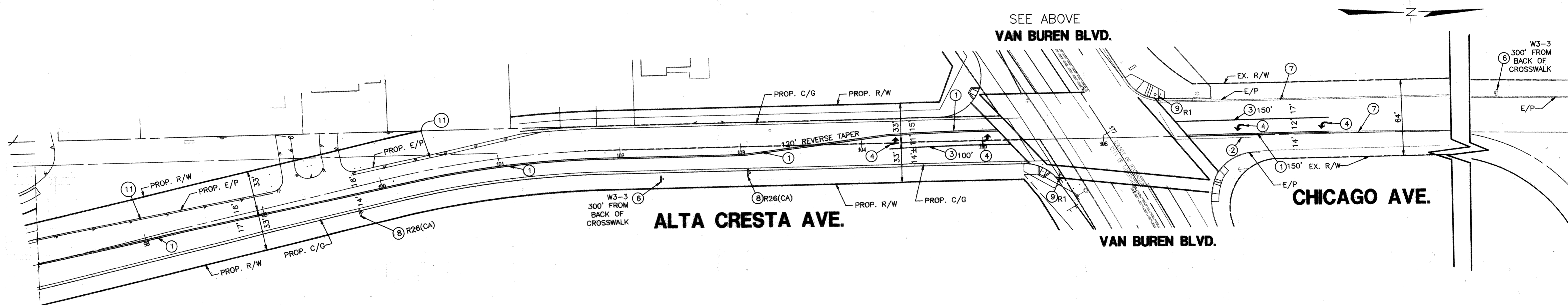
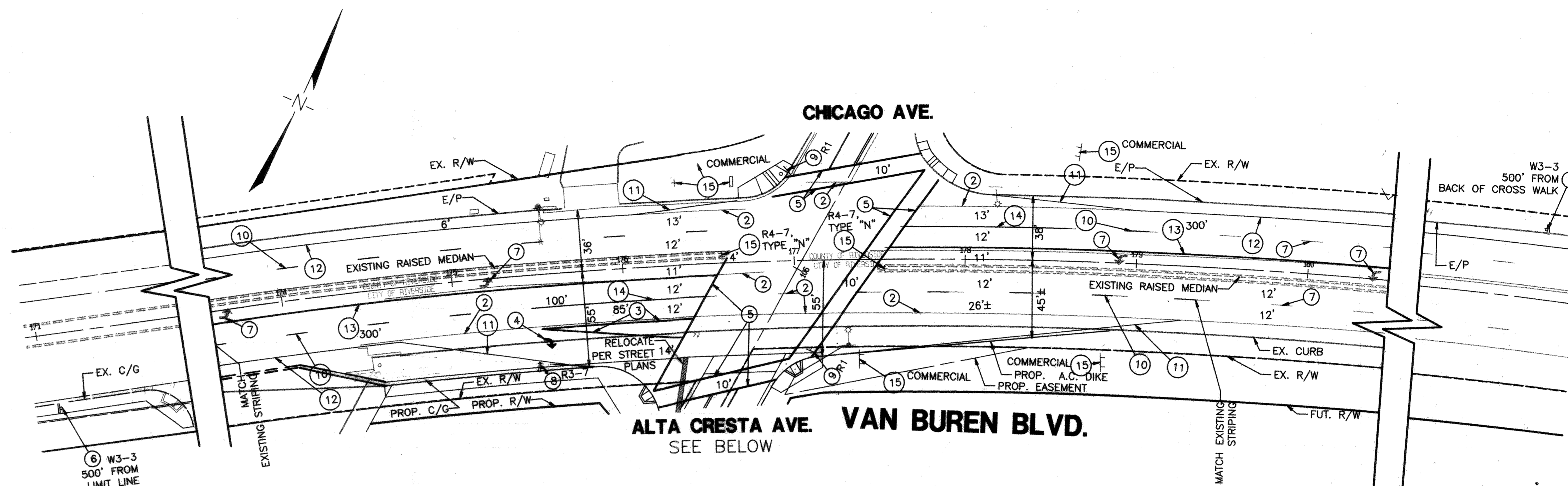

CITY OF RIVERSIDE, CALIFORNIA PUBLIC WORKS DEPARTMENT			
APPROVED BY	BY	DATE	APPROVED BY
PRINCIPAL ENGINEER	<i>[Signature]</i>	4/4/07	<i>[Signature]</i>
PARK DEPARTMENT			CITY ENGINEER
TRAFFIC DIVISION			
STREET SERVICES			

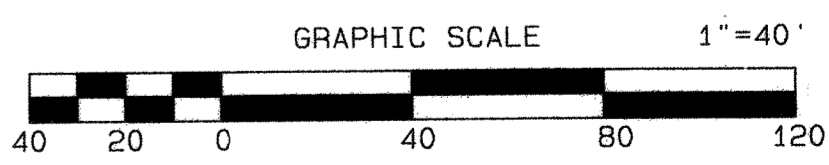

NOTE:
WORK CONTAINED WITHIN THESE PLANS SHALL NOT COMMENCE UNTIL AN ENCROACHMENT PERMIT AND/OR A GRADING PERMIT HAS BEEN ISSUED.

THE PRIVATE ENGINEER SIGNING THESE PLANS IS RESPONSIBLE FOR ASSURING THE ACCURACY AND ACCEPTABILITY OF THE DESIGN HEREON. IN THE EVENT OF DISCREPANCIES ARISING AFTER COUNTY APPROVAL OR DURING CONSTRUCTION, THE PRIVATE ENGINEER SHALL BE RESPONSIBLE FOR DETERMINING AN ACCEPTABLE SOLUTION AND REVISIONS TO THE PLANS FOR APPROVAL BY THE COUNTY.

DATE	BY	MARK	REVISIONS	APPR. DATE	COUNTY
2/5/08	DPAS	▲	ADDED CONSTRUCTION NOTE (11), SHEET 2	4/7/08	RIVERSIDE

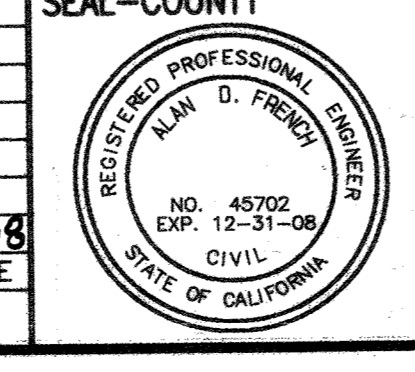

COUNTY OF RIVERSIDE
TRANSPORTATION DEPARTMENT

APPROVED BY:
Alan French 4-4-07

ALAN D. FRENCH, P.E.
R.C.E. 45702 EXP. 12-31-08

DATE: 4/7/08

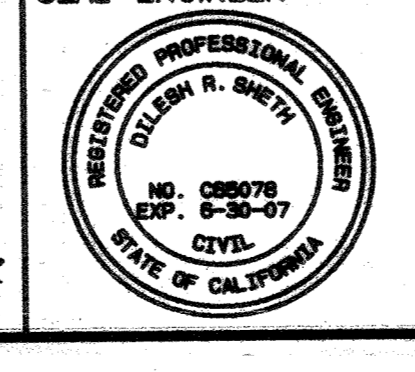

ALBERT A. WEBB ASSOCIATES ENGINEERING CONSULTANTS

CIVIL ENGINEERS
3788 McCRAV ST.
RIVERSIDE CA. 92506
PH (951) 686-1070
FAX (951) 788-1256

PREPARED BY: *Dilesh R. Sheth*
R.C.E. NO. 088078
DATE: 6-30-07

BENCHMARK: SEE STREET PLAN

SCALE: H: AS SHOWN V: N/A

MS 3983 IP 040150
COUNTY OF RIVERSIDE
SIGNING AND STRIPING PLAN
VAN BUREN BLVD. AND CHICAGO AVE.
ALTA CRESTA AVENUE

SHEET NO. **3**
OF 3 SHEETS

FOR: CENTEX HOMES
W.O. 03-0179
COUNTY FILE NO. 946JJ

XL-714
COUNTY ORG